

NOTES:

- ALL SHORT TERM BICYCLE PARKING SPACES SHALL INCLUDE A STATIONARY PARKING DEVICE ON A CONCRETE SURFACE WHICH ADEQUATELY SUPPORTS THE BICYCLE AND MUST HOLD AT LEAST 90 DEGREES OF THE WHEEL ARC.
- ALL LONG TERM FACILITIES SHALL CONSIST OF A FULLY ENCLOSED LOCKABLE SPACE ACCESSIBLE ONLY TO OPERATOR OF THE BICYCLE, OR ATTENDANT PARKING WITH A CREDIT CARD SYSTEM ACCESSIBLE ONLY TO THE ATTENDANT(S), OR A LOCKED ROW OR OFFICE INSIDE THE BUILDING. (WHERE NOT SPECIFIED, EITHER SHORT TERM OR LONG TERM PARKING IS PERMISSIBLE.)
- EACH SHORT TERM BICYCLE PARKING SPACE SHALL BE A MINIMUM OF TWO FEET WIDE AND ALL REQUIRED PARKING FACILITIES SHALL BE FROM SIX FEET LONG AND SHALL HAVE A WIDTH OF EIGHT FEET OF OVERHEAD CLEARANCE.
- AN APPROVED LIST OF BICYCLE PARKING DEVICES MAINTAINED BY THE MUNICIPAL SERVICES DEPARTMENT. ALTERNATIVE BICYCLE PARKING DEVICES MAY BE USED IF ESTABLISHED AS AN APPROVED EQUIVALENT IN FUNCTION, QUALITY AND CONSTRUCTION.
- FIXED OBJECTS WHICH ARE INTENDED TO SERVE AS BICYCLE PARKING FACILITIES SHALL BE CLEARLY LABELED AS AVAILABLE BICYCLE PARKING.
- BICYCLE PARKING SHALL BE CONSISTENT WITH SURROUNDINGS IN COLOR AND DESIGN AND BE INCORPORATED WHEREVER POSSIBLE INTO BUILDING OR STREET FURNITURE DESIGN.
- BICYCLE PARKING SHALL BE LOCATED AS NEAR THE PRINCIPAL ENTRANCE OF THE BUILDING AS PRACTICABLE.
- BICYCLE PARKING SHALL BE LOCATED IN A CONVENIENT, HIGHLY VISIBLE, ACTIVELY LIGHTED AREA.
- BICYCLE PARKING SHALL BE LOCATED SO AS NOT TO IMPEDING PEDESTRIAN MOVEMENT.

City of Boca Raton
Municipal Services Department
20 West Pompano Beach Road
Boca Raton, Florida 33432

BICYCLE PARKING DETAIL (TYP.)

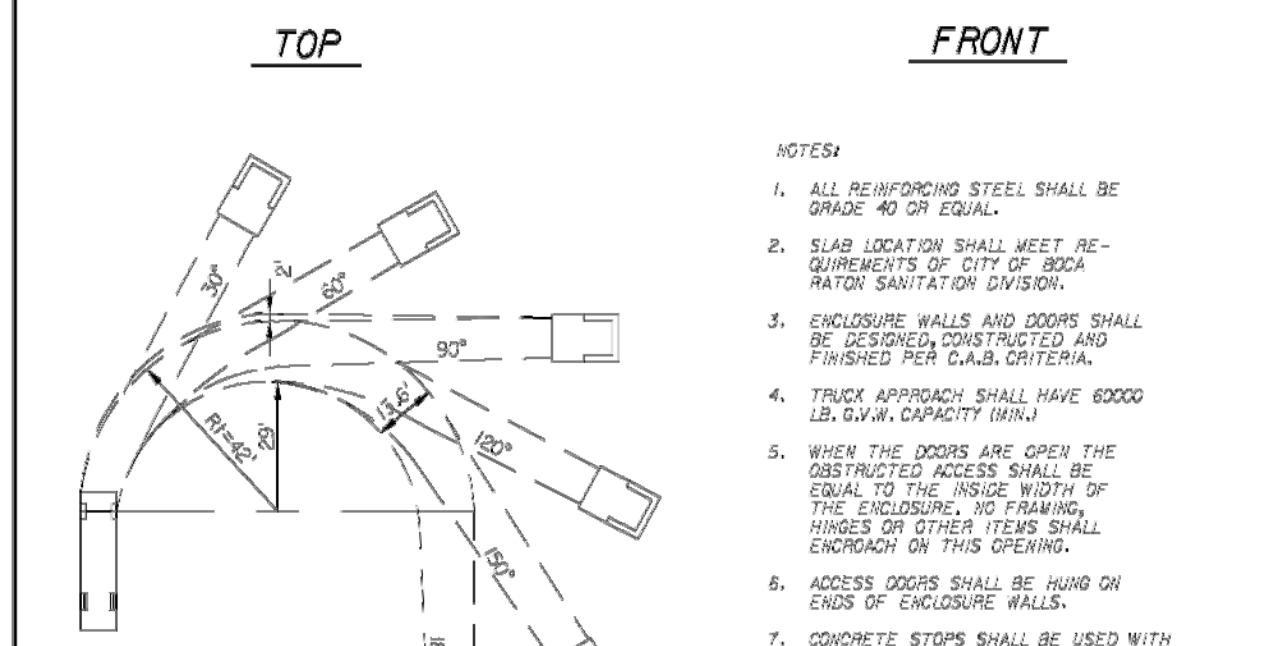
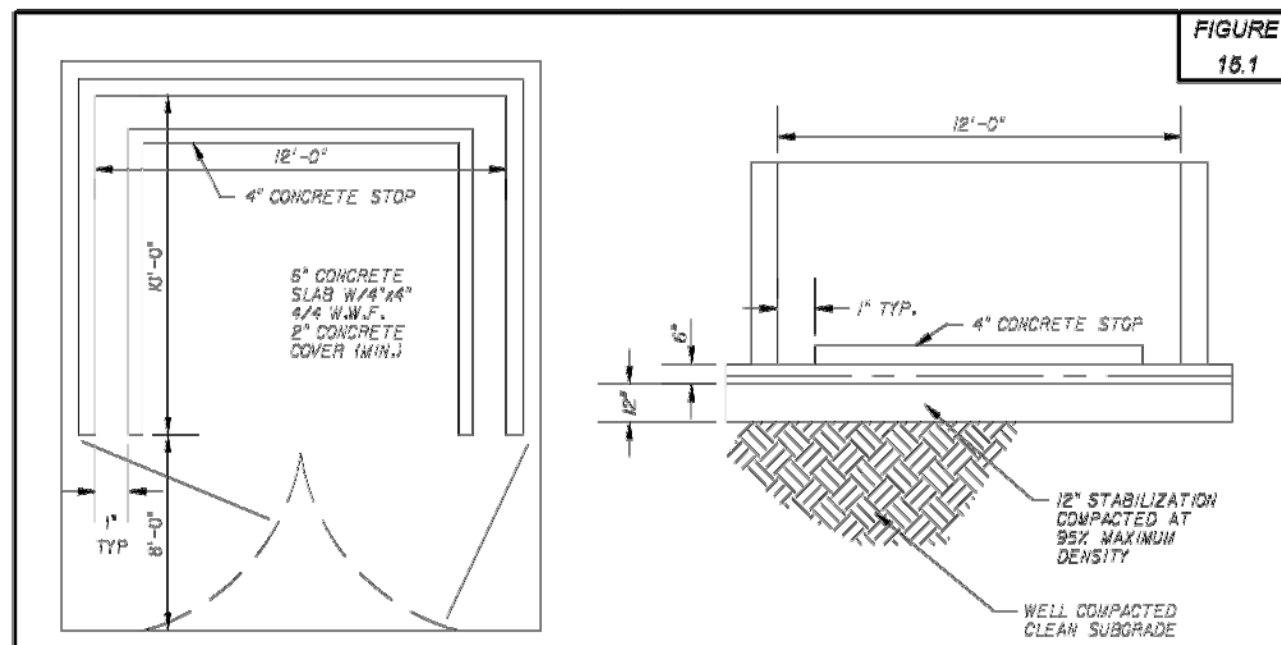

NOTES:

- ALL REINFORCING STEEL SHALL BE GRADE 40 OR EQUAL.
- SLAB LOCATION SHALL MEET REQUIREMENTS OF CITY OF BOCA RATON SANITATION DIVISION.
- ENCLOSURE WALLS AND DOORS SHALL BE DESIGNED, CONSTRUCTED AND FINISHED PER LOCAL CRITERIA.
- TRUCK APPROACH SHALL HAVE 60000 LB. GVW. CAPACITY (MIN.)
- WHEN THE DOORS ARE OPEN THE OBSTRUCTED ACCESS SHALL BE EQUAL TO THE INSIDE WIDTH OF THE ENCLOSURE. NO FRAMING, HINGES OR OTHER ITEMS SHALL ENPROACH ON THIS OPENING.
- ACCESS DOORS SHALL BE HARD ON ENDS OF ENCLOSURE WALLS.
- CONCRETE STOPS SHALL BE HARD ON ENDS OF ENCLOSURE WALLS.

City of Boca Raton
Municipal Services Department
20 West Pompano Beach Road
Boca Raton, Florida 33432

DUMPSTER ENCLOSURE COMMERCIAL (SINGLE)

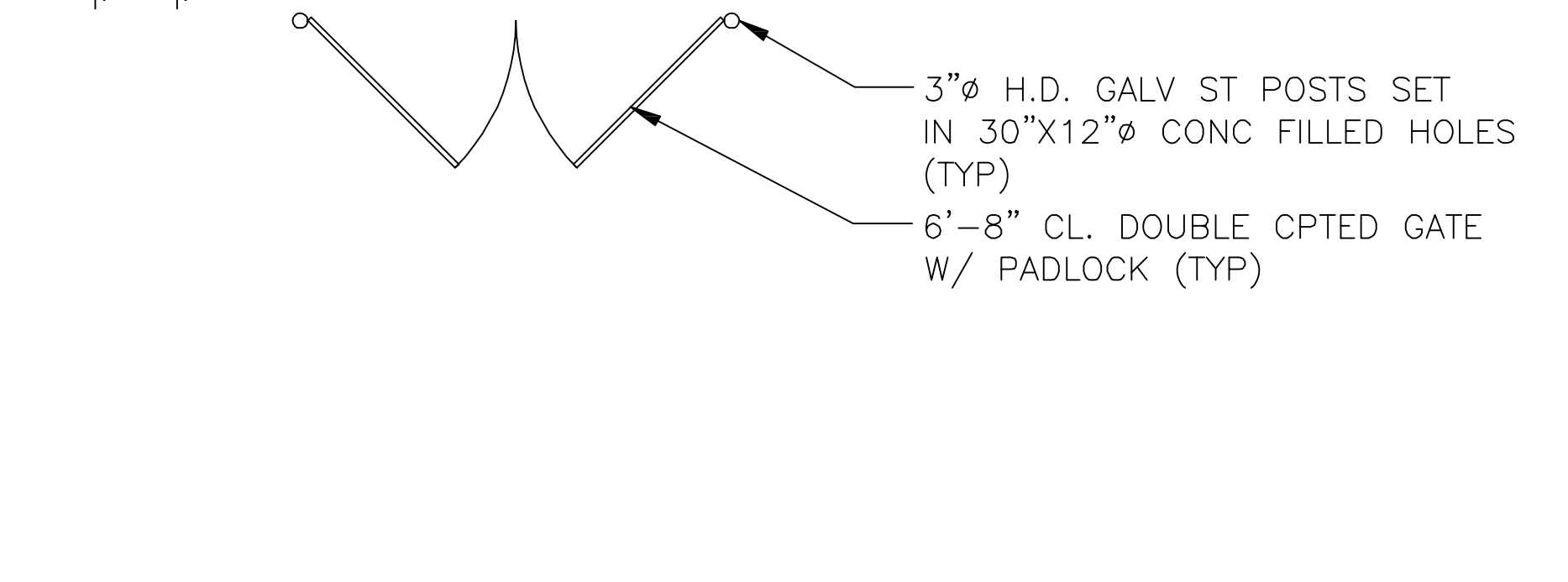
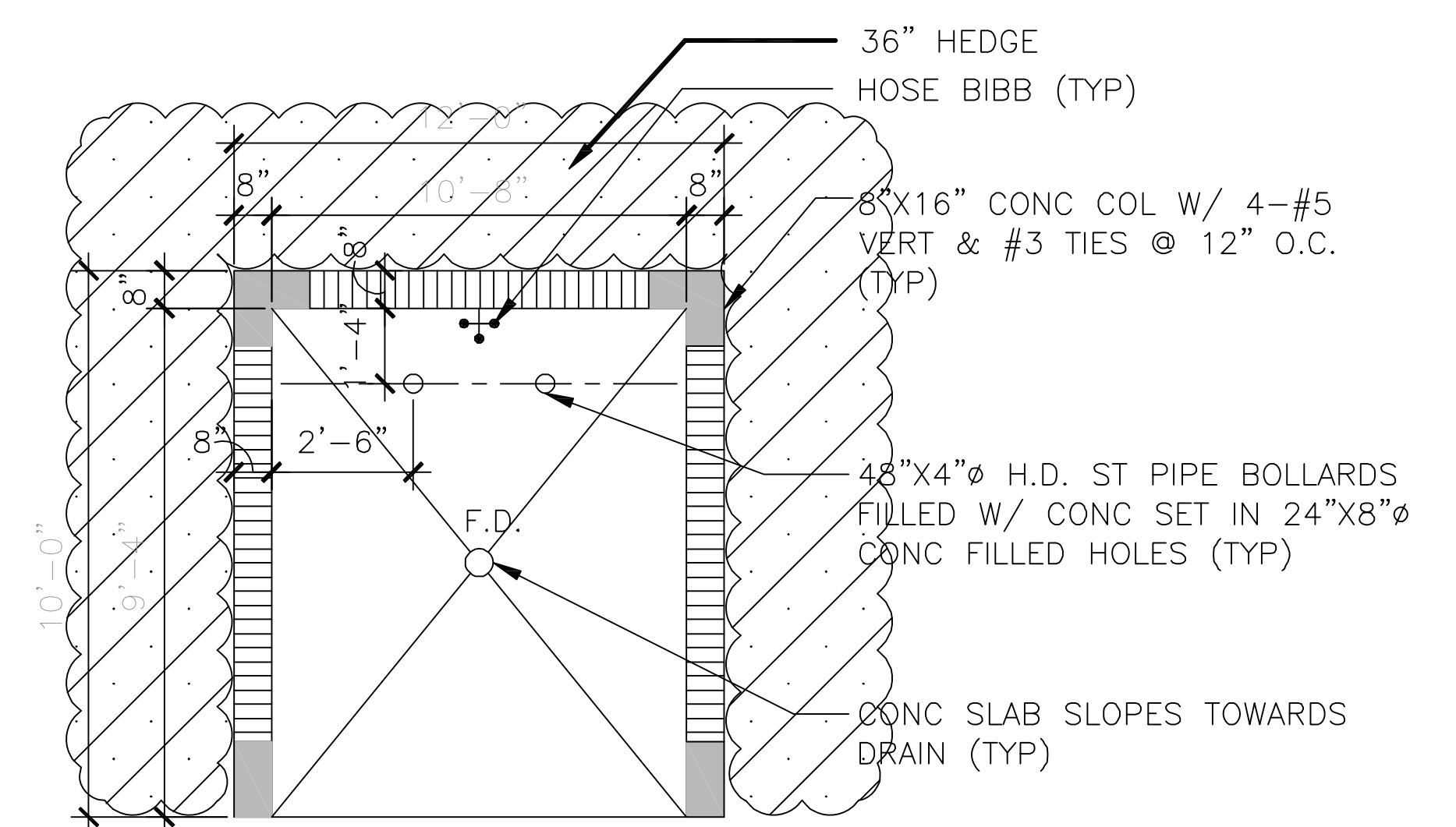

NOTES:

- ALL REINFORCING STEEL SHALL BE GRADE 40 OR EQUAL.
- SLAB LOCATION SHALL MEET REQUIREMENTS OF CITY OF BOCA RATON SANITATION DIVISION.
- ENCLOSURE WALLS AND DOORS SHALL BE DESIGNED, CONSTRUCTED AND FINISHED PER LOCAL CRITERIA.
- TRUCK APPROACH SHALL HAVE 60000 LB. GVW. CAPACITY (MIN.)
- WHEN THE DOORS ARE OPEN THE OBSTRUCTED ACCESS SHALL BE EQUAL TO THE INSIDE WIDTH OF THE ENCLOSURE. NO FRAMING, HINGES OR OTHER ITEMS SHALL ENPROACH ON THIS OPENING.
- ACCESS DOORS SHALL BE HARD ON ENDS OF ENCLOSURE WALLS.
- CONCRETE STOPS SHALL BE HARD ON ENDS OF ENCLOSURE WALLS.

City of Boca Raton
Municipal Services Department
20 West Pompano Beach Road
Boca Raton, Florida 33432

DUMPSTER ENCLOSURE COMMERCIAL (SINGLE)

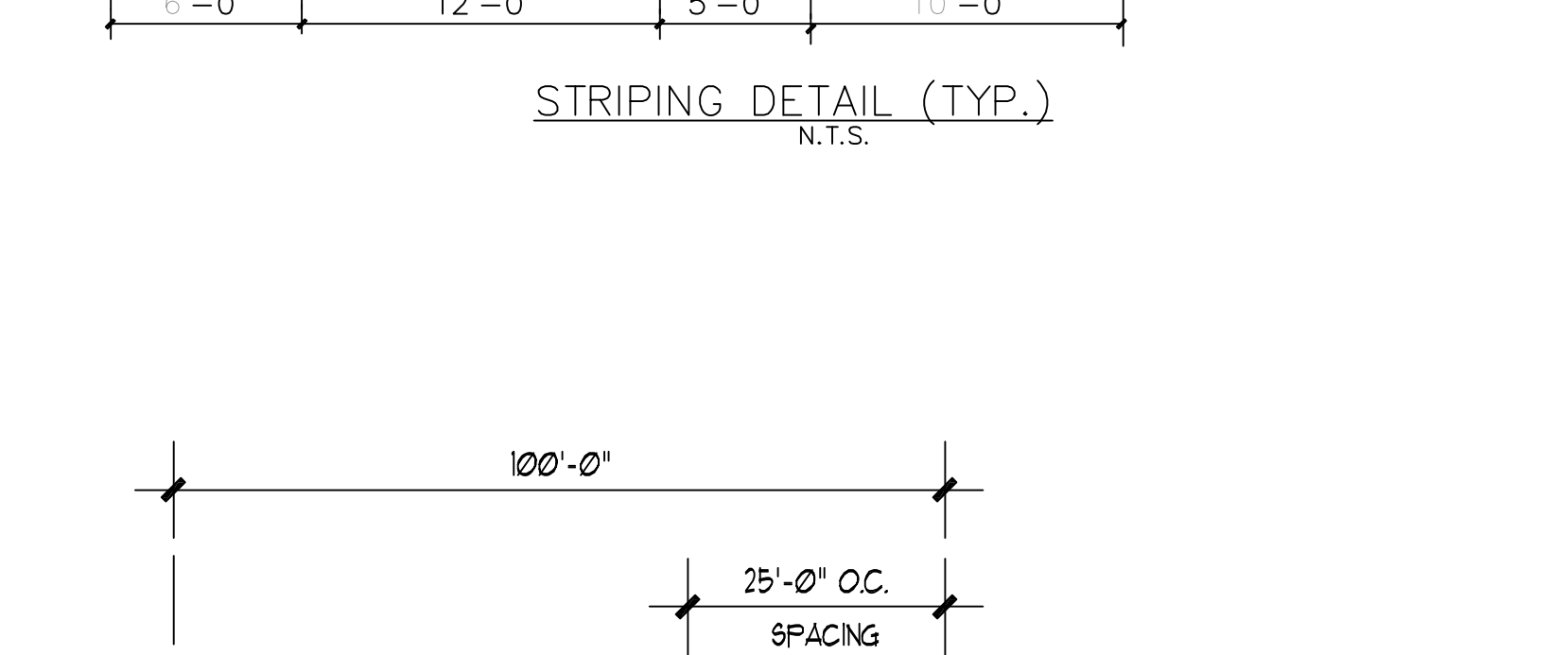
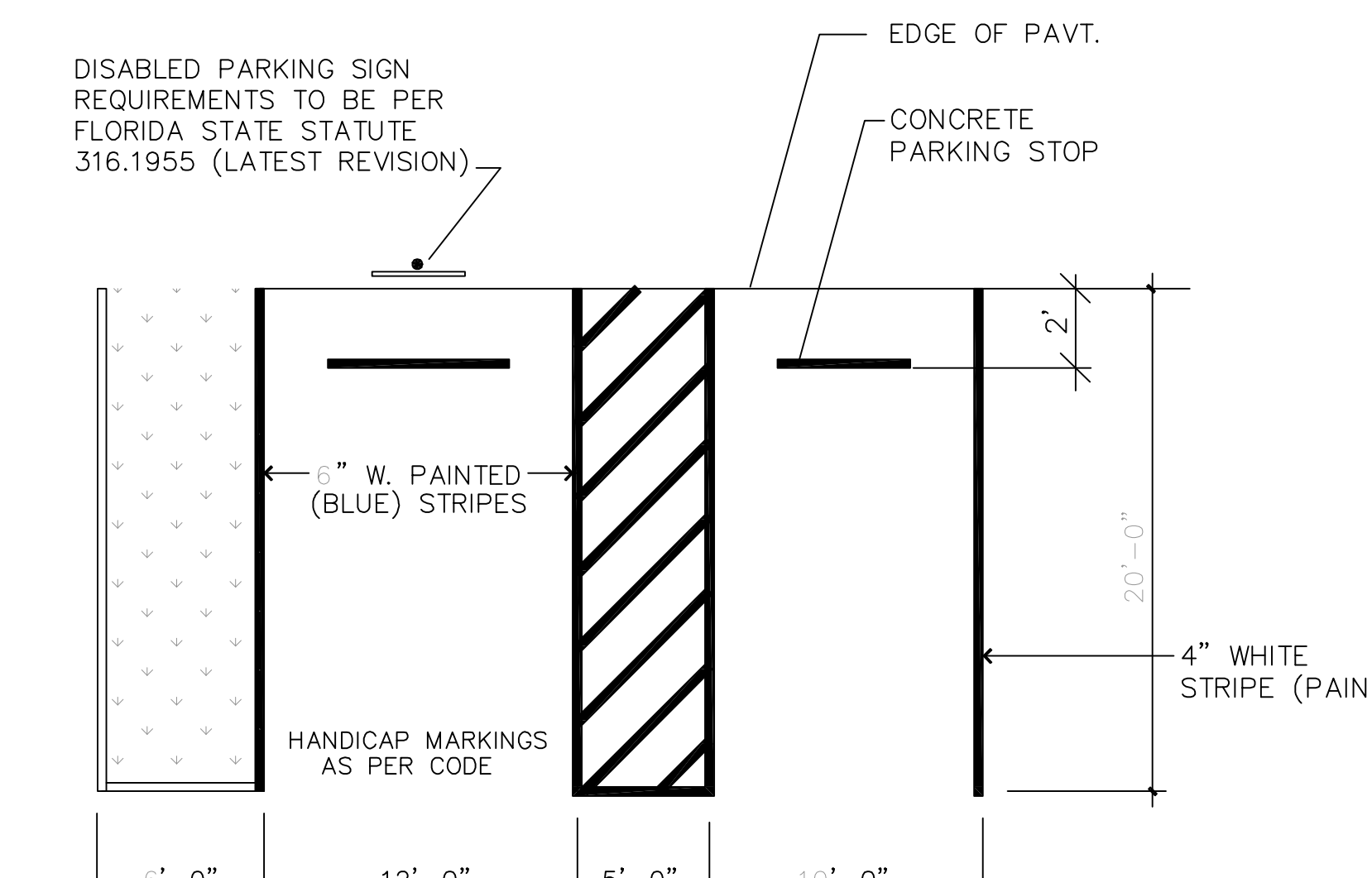

NOTES:

- ALL REINFORCING STEEL SHALL BE GRADE 40 OR EQUAL.
- SLAB LOCATION SHALL MEET REQUIREMENTS OF CITY OF BOCA RATON SANITATION DIVISION.
- ENCLOSURE WALLS AND DOORS SHALL BE DESIGNED, CONSTRUCTED AND FINISHED PER LOCAL CRITERIA.
- TRUCK APPROACH SHALL HAVE 60000 LB. GVW. CAPACITY (MIN.)
- WHEN THE DOORS ARE OPEN THE OBSTRUCTED ACCESS SHALL BE EQUAL TO THE INSIDE WIDTH OF THE ENCLOSURE. NO FRAMING, HINGES OR OTHER ITEMS SHALL ENPROACH ON THIS OPENING.
- ACCESS DOORS SHALL BE HARD ON ENDS OF ENCLOSURE WALLS.
- CONCRETE STOPS SHALL BE HARD ON ENDS OF ENCLOSURE WALLS.

City of Boca Raton
Municipal Services Department
20 West Pompano Beach Road
Boca Raton, Florida 33432

DUMPSTER ENCLOSURE COMMERCIAL (SINGLE)

NO.	DATE	DESCRIPTION
1		
2		
3		
4		
5		
6		
7		
8		

CLIENT:
8300 Congress, LLC.
8300 Congress Avenue,
Boca Raton, FL 33487

PROJECT:
8300 Congress Avenue
Site improvements
PRELIMINARY SITE DETAILS

GGB Engineering, Inc.
CIVIL & FORENSIC ENGINEERS, LAND PLANNERS,
CONSTRUCTION MANAGERS.
FLORIDA REGISTRATION NO. 8118
Shirley Road, Suite 201
Fort Lauderdale, Florida 33312
Phone: (954) 986-9899
Fax: (954) 986-6655

DATE: 01/20/14	SCALE: NTS.
DESIGNED BY: G.G.B.	DRAWN BY: B.B.
PROJECT NO. 14-0121	
SHEET SP2	OF 2

GARY G. BLOOM, P.E.
FLA LIC. No. 19832