

PLUMBING LEGEND	
---	COLD WATER LINE
---	100° HOT WATER LINE
---	140° HOT WATER LINE
---	HOT WATER RETURN LINE
---	SANITARY LINE
---	GAS LINE
---	CONDENSATE LINE
---	DOMESTIC LINE
---	WASTE LINE
---	RAIN WATER LEADER LINE (R.W.L.)
---	VENT LINE
---	FLOOR DRAIN
---	SHUT-OFF VALVE
---	HOSE BIBB WITH S.O.V. & VACUUM BREAKER
---	A.A.V. AIR ADMITTANCE CHAMBER

- PLUMBING**
- ALL WORK SHALL BE DONE IN ACCORDANCE WITH THE FLORIDA BUILDING CODE 2010 EDITION, AND SHALL COMPLY WITH ALL LOCAL RULES AND ORDINANCES.
  - ALL WORKMANSHIP & MATERIALS SHALL BE IN STRICT ACCORDANCE WITH APPLICABLE NATIONAL, STATE, LOCAL CODES, RULES & ORDINANCES.
  - CONTRACTOR SHALL VISIT THE JOB SITE & THOROUGHLY EXAMINE & IDENTIFY ALL EXISTING CONDITIONS.
  - ALL WORK SHALL BE PERFORMED BY A LICENSED PLUMBING CONTRACTOR IN A FIRST-CLASS WORKMANLIKE MANNER. THE COMPLETE SYSTEM SHALL BE FULLY OPERATIVE.
  - ALL EXCAVATION & BACK FILL AS REQUIRED FOR THIS PHASE OF CONSTRUCTION SHALL BE A PART OF THIS CONTRACT.
  - REQUIRED INSURANCE SHALL BE PROVIDED BY THIS CONTRACTOR FOR PROTECTION AGAINST PUBLIC LIABILITY & PROPERTY DAMAGE FOR THE DURATION OF WORK.
  - CONTRACTOR SHALL PAY FOR ALL PERMITS, FEES, INSPECTIONS & TESTS. SUBSTITUTIONS BY THE CONTRACTOR SHALL HAVE PRIOR APPROVAL. ANY CHANGES MADE WITHOUT PRIOR APPROVAL SHALL BE THE CONTRACTOR'S RESPONSIBILITY TO RETURN TO THE ORIGINAL DESIGN.
  - REPAIRS AND REWORK SHALL BE DONE AT THE CONTRACTOR'S EXPENSE.
  - ALL WORK SHALL BE COORDINATED WITH OTHER TRADES TO AVOID INTERFERENCE WITH THE PROCESS OF CONSTRUCTION.
  - VERIFY LOCATION, SIZE, TRAPS, INVERTS OF ALL EXISTING UTILITIES PRIOR TO BEGINNING CONSTRUCTION. ADVISE ENGINEER OF ANY DISCREPANCIES. ANY COST RESULTING FROM DISCREPANCIES NOT REPORTED AT THIS TIME SHALL BE THE CONTRACTOR'S RESPONSIBILITY.
  - WATER PIPING TO BE TYPE "C" OR TYPE "L" COPPER ABOVE OR BELOW GRADE.
  - S.O.V., WASTE & VENT PIPING TO BE PVC 4" & 6" O.D.W.
  - ALL FIXTURES MUST BE PROVIDED WITH READILY ACCESSIBLE STOPS.
  - N/A
  - WHERE DISSIMILAR METALS ARE TO BE JOINED, APPROVED INSULATING UNIONS SHALL BE USED.
  - INSULATE HOT WATER AND HOT WATER RETURN LINES WITH 1" THICK SWAP ON INSULATION FROM WATER HEATER.
  - CONDENSATE LINES TO BE COPPER/PVC DEPENDING ON PROJECT REQUIREMENTS.
  - INSULATE WITH 1/2" THICK RADIANT INSULATION.
  - CONTRACTOR SHALL GUARANTEE ALL MATERIALS & WORKMANSHIP FREE FROM DEFECTS FOR A PERIOD OF 12 MONTHS FROM THE DATE OF COMPLETION. ANY DEFECTS SHALL BE COMPLETED WITHOUT ADDITIONAL CHARGE AND SHALL INCLUDE REPAIR, REPLACEMENT OR REPAIR OF ANY OTHER PHASE OF THE INSTALLATION WHICH MAY HAVE BEEN DAMAGED THEREBY.
  - NO PVC PIPING TO BE USED IN COMMON PLUMBING AREAS.
  - SEE PLUMBING PLANS FOR ADDITIONAL REQUIREMENTS.

- SPECIFICATIONS**
1. ALL WORK SHALL BE DONE IN ACCORDANCE WITH THE FLORIDA BUILDING CODE 2010 EDITION, AND SHALL COMPLY WITH ALL LOCAL RULES AND ORDINANCES.
  2. ALL WORKMANSHIP & MATERIALS SHALL BE IN STRICT ACCORDANCE WITH APPLICABLE NATIONAL, STATE, LOCAL CODES, RULES & ORDINANCES.
  3. CONTRACTOR SHALL VISIT THE JOB SITE & THOROUGHLY EXAMINE & IDENTIFY ALL EXISTING CONDITIONS.
  4. ALL WORK SHALL BE PERFORMED BY A LICENSED PLUMBING CONTRACTOR IN A FIRST-CLASS WORKMANLIKE MANNER. THE COMPLETE SYSTEM SHALL BE FULLY OPERATIVE.
  5. ALL EXCAVATION & BACK FILL AS REQUIRED FOR THIS PHASE OF CONSTRUCTION SHALL BE A PART OF THIS CONTRACT.
  6. REQUIRED INSURANCE SHALL BE PROVIDED BY THIS CONTRACTOR FOR PROTECTION AGAINST PUBLIC LIABILITY & PROPERTY DAMAGE FOR THE DURATION OF WORK.
  7. CONTRACTOR SHALL PAY FOR ALL PERMITS, FEES, INSPECTIONS & TESTS. SUBSTITUTIONS BY THE CONTRACTOR SHALL HAVE PRIOR APPROVAL. ANY CHANGES MADE WITHOUT PRIOR APPROVAL SHALL BE THE CONTRACTOR'S RESPONSIBILITY TO RETURN TO THE ORIGINAL DESIGN.
  8. REPAIRS AND REWORK SHALL BE DONE AT THE CONTRACTOR'S EXPENSE.
  9. ALL WORK SHALL BE COORDINATED WITH OTHER TRADES TO AVOID INTERFERENCE WITH THE PROCESS OF CONSTRUCTION.
  10. VERIFY LOCATION, SIZE, TRAPS, INVERTS OF ALL EXISTING UTILITIES PRIOR TO BEGINNING CONSTRUCTION. ADVISE ENGINEER OF ANY DISCREPANCIES. ANY COST RESULTING FROM DISCREPANCIES NOT REPORTED AT THIS TIME SHALL BE THE CONTRACTOR'S RESPONSIBILITY.
  11. WATER PIPING TO BE TYPE "C" OR TYPE "L" COPPER ABOVE OR BELOW GRADE.
  12. S.O.V., WASTE & VENT PIPING TO BE PVC 4" & 6" O.D.W.
  13. ALL FIXTURES MUST BE PROVIDED WITH READILY ACCESSIBLE STOPS.
  14. N/A
  15. WHERE DISSIMILAR METALS ARE TO BE JOINED, APPROVED INSULATING UNIONS SHALL BE USED.
  16. INSULATE HOT WATER AND HOT WATER RETURN LINES WITH 1" THICK SWAP ON INSULATION FROM WATER HEATER.
  17. CONDENSATE LINES TO BE COPPER/PVC DEPENDING ON PROJECT REQUIREMENTS.
  18. INSULATE WITH 1/2" THICK RADIANT INSULATION.
  19. CONTRACTOR SHALL GUARANTEE ALL MATERIALS & WORKMANSHIP FREE FROM DEFECTS FOR A PERIOD OF 12 MONTHS FROM THE DATE OF COMPLETION. ANY DEFECTS SHALL BE COMPLETED WITHOUT ADDITIONAL CHARGE AND SHALL INCLUDE REPAIR, REPLACEMENT OR REPAIR OF ANY OTHER PHASE OF THE INSTALLATION WHICH MAY HAVE BEEN DAMAGED THEREBY.
  20. NO PVC PIPING TO BE USED IN COMMON PLUMBING AREAS.
  21. SEE PLUMBING PLANS FOR ADDITIONAL REQUIREMENTS.

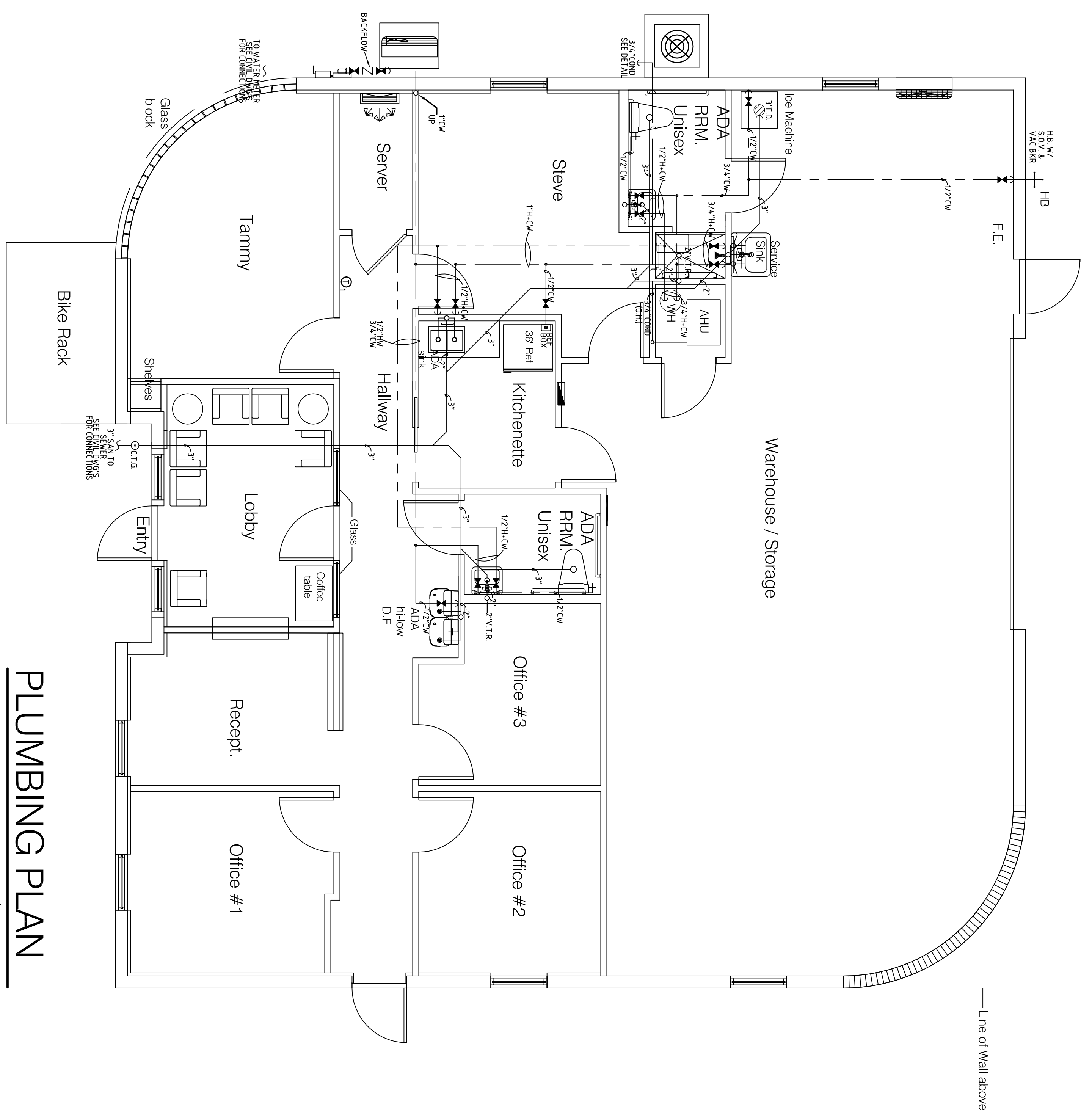

PROJECT: KELLY SCHMIDT

SANITARY SINK	NO.	F.U./EACH	TOTAL	MIN. TRAP SIZE
WATER CLOSET	2	4.0	8.0	3"
LAVATORY	1	1.0	1.0	1 1/2"
SHOWER	1	2.0	2.0	1 1/2"
SERVICE SINK	1	2.0	2.0	2"
KITCHEN SINK	1	2.0	2.0	2"
DINING SINK	2	0.5	1.0	1 1/2"
FLOOR DRAIN	1	2.0	2.0	2"
TOTAL	10	-	19	-

TOTAL SANITARY FIXTURE UNITS: 19.0  
 MINIMUM SIZE SANITARY LINE @ 1/8" SLOPE: 3"

HOT & COLD WATER SIZES	NO.	C.M.F./F.S.	TOTAL	MIN./F.S.	TOTAL
WATER CLOSET	2	5.0	10.0	1"	1"
SHOWER	1	3.0	3.0	3/4"	3/4"
SERVICE SINK	1	2.25	2.25	2.25	2.25
KITCHEN SINK	1	2.25	2.25	2.25	2.25
DINING FOUNTAIN	2	0.25	0.50	-	-
HOSE BIBB	1	3.0	3.0	-	-
TOTAL	10	-	24.0	-	10.4

TOTAL C.M.F.U. (24.0 \* .105) = 2.52  
 MINIMUM SIZE WATER SERVICE: 1"  
 MINIMUM SIZE WATER METER: 1"

**PLUMBING PLAN**  
 1/4" = 10'

**ARCHITECTURE**  
 RICK BRAUTIGAN  
 1025 SDIXI @ HIGHWAY  
 Delray Beach, FL 33483  
 PH: 561.272.9086  
 FX: 561.272.5636  
 FAX: 002029

**PRELIMINARY SET: 06/2015**

NOTE:  
 ALL PERMITS, FEES, INSPECTIONS, AND TESTS SHALL BE THE RESPONSIBILITY OF THE CONTRACTOR. THE CONTRACTOR SHALL BE RESPONSIBLE FOR OBTAINING ALL NECESSARY PERMITS AND FEES. THE CONTRACTOR SHALL BE RESPONSIBLE FOR OBTAINING ALL NECESSARY PERMITS AND FEES. THE CONTRACTOR SHALL BE RESPONSIBLE FOR OBTAINING ALL NECESSARY PERMITS AND FEES.

**FORMICA**  
 ASSOCIATES  
 Consulting Engineers  
 3500 N.W. Boca Raton Blvd.  
 Boca Raton, FL 33431  
 TEL: (561) 993-8000  
 FAX: (561) 993-8001  
 Email: info@formica.com

Kelly Building for:  
**Schmidt Investment Properties, LLC**  
 1302 Wallace Drive  
 Delray Beach, FL 33414  
 RBA.PN.13714.09

**PLUMBING PLAN**  
 Set 1/4

**REVISIONS**

**PLUMBING PLAN**  
 1  
 © PAUL RICHARD BRAUTIGAN, ARCHITECT AR0011073