

OCCUPANT LOAD FACTOR TABLE 1004.1.1 F.B.C AND 2010 Florida Fire Prevention Code, NFPA 101, 2009 EDITION				
ROOM NUMBER	CLASSIFICATION	SQ.FT/OCCUPANT	AREA (SQ.FT)	OCCUPANTS ALLOWED
101	MERCANTILE	30 (GROSS)	656	22
103	KITCHENETTE	200 (GROSS)	134	1
106	STORAGE	300 (GROSS)	58	1
108	ASSEMBLY WITH FIXED SEATS	--	68	2
110	ASSEMBLY WITH FIXED SEATS	--	3240	362
111	STORAGE	300 (GROSS)	242	1
113	BUSINESS	100 (GROSS)	335	4
115	MECHANICAL EQUIPMENT ROOM	300 (GROSS)	122	1
116	ASSEMBLY WITHOUT FIXED SEATS	7 (NET)	1111.60	159
				553

### LIFE SAFETY PLAN NOTES:

**INTERIOR FINISH:**  
INTERIOR WALL AND CEILING FINISH MATERIALS TO BE CLASS A OR B TO COMPLY WITH SECTION 13.3.3 Florida Fire Prevention Code, Fifth Edition (2014) / NFPA 101, 2012 EDITION

**INTERIOR FLOOR FINISH SHALL COMPLY WITH SECTION 13.3.3.5** Florida Fire Prevention Code, Fifth Edition (2014) / NFPA 101, 2012 EDITION

**ILLUMINATION OF MEANS OF EGRESS:**  
SHALL COMPLY WITH 39.2.8 Florida Fire Prevention Code, Fifth Edition (2014) / NFPA 101, 2012 EDITION

**EMERGENCY LIGHTING:**  
SHALL COMPLY WITH 39.2.9.1 Florida Fire Prevention Code, Fifth Edition (2014) / NFPA 101, 2012 EDITION

**DOOR HARDWARE:**  
ALL DOORS HARDWARE SHALL COMPLY WITH NFPA 101 CHAPTER 7

**SIGNAGE:**  
PROVIDE 3" ADDRESS/SUITE NUMBER ON EXTERIOR DOOR  
PROVIDE MAX. OCCUPANCY SIGNS PER NFPA 101: 12.7.8.3

**REQUIRED MEANS OF EGRESS SHALL BE MAINTAINED AT ALL TIMES DURING CONSTRUCTION, DEMOLITION, REMODELING OR ALTERATIONS AND ADDITIONS TO ANY BUILDING.**

### NOTES

1. STAIR DOORS- 'B' LABEL' 1-1/2 HR RATED (450" F MAX.) (ALL EXIT DOORS SHALL BE 3'-0" WIDE, 35" CLEAR WIDTH / .02 IN. PER PERSON AS PER TABLE 1004 OF THE F.B.C. = 170 PERSONS)
2. UNIT PARTY WALLS TO BE 1 HR RATED.
3. ELEVATOR DOORS TO BE 1-1/2 HR RATED.
4. TENANT ENTRY DOORS TO BE 3/4 HR RATED 'C' LABEL'
5. FIRE EXTINGUISHER INSTALLED SO THAT MAXIMUM TRAVEL DISTANCE FROM ANY POINT IS NO MORE THAN 75 L.F.

### LIFE SAFETY PLAN NOTES:

USE CLASSIFICATION: ASSEMBLY / ASSEMBLY W/FURNITURE / MERCANTILE / STORAGE / MECHANICAL ROOM.  
SPRINKLERED

STAIR ENCLOSURES, ELEVATOR SHAFTS: N/A

**INTERIOR FINISH:**  
INTERIOR WALL AND CEILING FINISH MATERIALS TO BE CLASS A OR B TO COMPLY WITH SECTION 13.3.3. Florida Fire Prevention Code, Fifth Edition (2014) / NFPA 101, 2012 EDITION

**INTERIOR FLOOR FINISH SHALL COMPLY WITH SECTION 13.3.3.5 - Florida Fire Prevention Code, Fifth Edition (2014) / NFPA 101, 2012 EDITION**

**ILLUMINATION OF MEANS OF EGRESS:**  
SHALL COMPLY WITH 39.2.8 Florida Fire Prevention Code, Fifth Edition (2014) / NFPA 101, 2012 EDITION

**EMERGENCY LIGHTING:**  
SHALL COMPLY WITH 39.2.9.1 Florida Fire Prevention Code, Fifth Edition (2014) / NFPA 101, 2012 EDITION

**REQUIRED MEANS OF EGRESS SHALL BE MAINTAINED AT ALL TIMES DURING CONSTRUCTION, DEMOLITION, REMODELING OR ALTERATIONS AND ADDITIONS TO ANY BUILDING.**

**EGRESS: REQUIRED NUMBER OF EXITS:**  
REQUIRED: TWO - PROVIDED: TWO

**MINIMUM CORRIDOR WIDTH:**  
REQUIRED: 36" - PROVIDED: 72"+

**LENGTH OF TRAVEL:**  
MAXIMUM: 250 LINEAR FEET - PROVIDED: SEE PLAN

**LEVEL EGRESS WIDTH:**  
REQUIRED: 17" X 2" = 3.4" (32" MIN) - PROVIDED: 96"+

**MAXIMUM DEAD END CORRIDOR LENGTH:**  
MAXIMUM: 50 FT - ACTUAL: N/A

**MINIMUM WIDTH OF DOORS:**  
REQUIRED: 32" - PROVIDED: 32"+

**EXIT SIGNS REQUIRED:**  
YES - PROVIDED: YES

**EMERGENCY LIGHTING:**  
REQUIRED: YES - PROVIDED: YES

### LIFE SAFETY PLAN LEGEND:

AREA (SF)	FUNCTION
OCC/SF	OCC

	PORTABLE FIRE EXTINGUISHER. SHALL COMPLY WITH CH 39.3.5-2010 Florida Fire Prevention Code, NFPA 101, 2009 EDITION 75' MAX. TRAVEL DISTANCE TO EXTINGUISHER
	TRAVEL DISTANCE 200' MAX. ALLOWED - 83'-4" PROPOSED WORST CASE LENGTH
	COMMON PATH 75' MAX. ALLOWED - 50'-8" PROPOSED WORST CASE LENGTH
	1 HR FIRE / SMOKE BARRIER SEPARATION
	2 HR FIRE BARRIER SEPARATION
	DEAD END CORRIDOR 50' MAX. ALLOWED
	EDGE LIT GREEN LED EXIT SIGN

NOTE:  
REFER TO REFLECTED CEILING PLAN FOR EMERGENCY LIGHTING

### DOOR HARDWARE

ALL DOORS HARDWARE SHALL COMPLY WITH NFPA 101 CHAPTER 7

### SIGNAGE:

PROVIDE 3" ADDRESS/SUITE NUMBER ON EXTERIOR DOOR  
PROVIDE MAX. OCCUPANCY SIGNS PER NFPA 101: 12.7.8.3

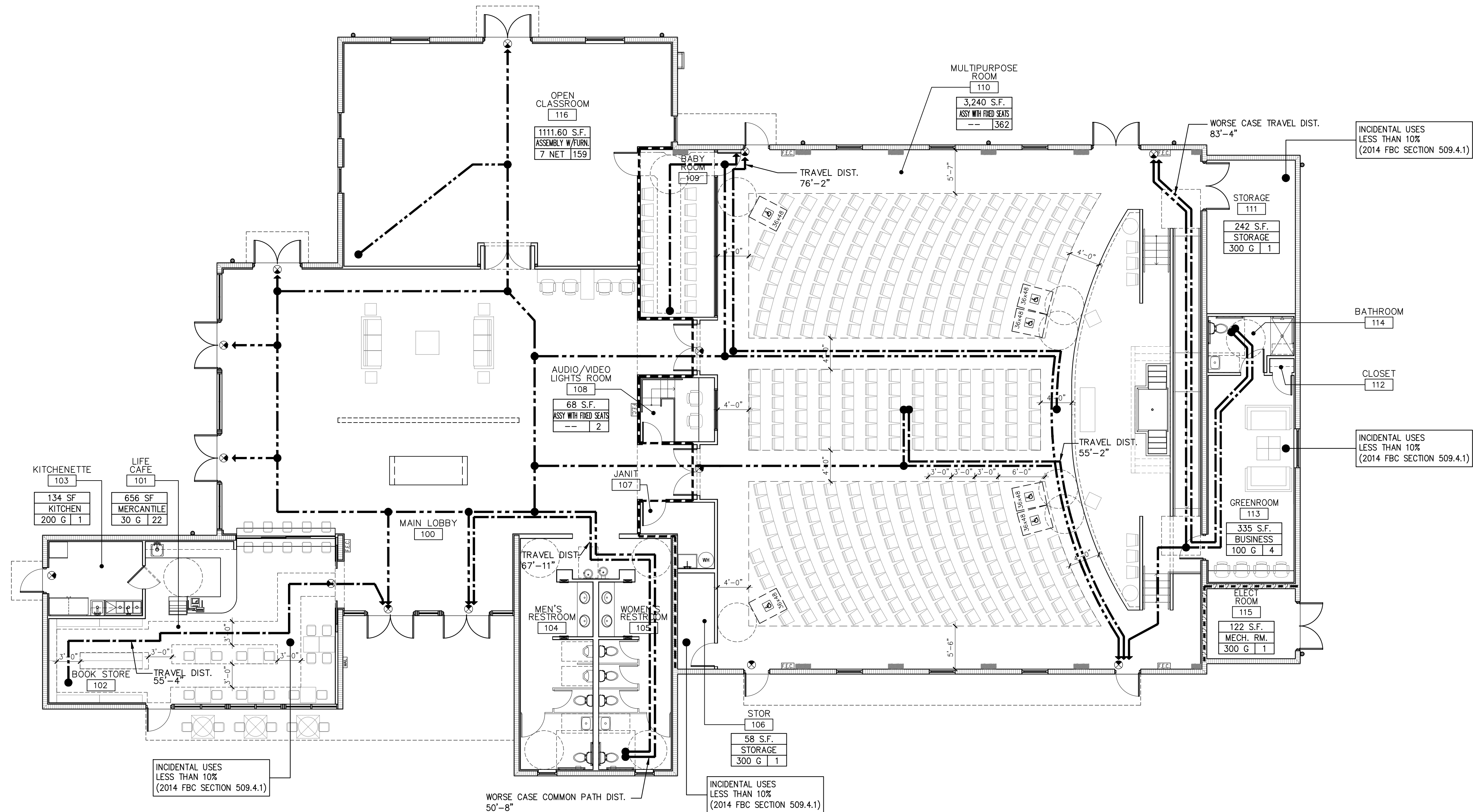

## 1 FLOOR PLAN

SCALE: 1/8" = 1'-0"



### REVISIONS

1.
2.
3.
4.
5.
6.
7.
8.
9.
10.

ALL AREAS, DESIGN, DIMENSIONS, AND PLANS INDICATED OR REPRESENTED BY THIS DRAWING ARE OWNED BY AND PROPERTY OF RWB ARCHITECTURE AND SHALL BE KEPT IN CONFIDENCE AND NOT TO BE REPRODUCED, COPIED, OR TRANSMITTED IN ANY FORM OR BY ANY MEANS, ELECTRONIC OR MECHANICAL, INCLUDING PHOTOCOPYING, RECORDING, OR BY ANY INFORMATION STORAGE AND RETRIEVAL SYSTEM, WITHOUT THE WRITTEN PERMISSION OF RWB ARCHITECTURE, INC.

LIFE FELLOWSHIP  
11401 WEST SAMPLE ROAD  
CORAL SPRINGS, FL. 33065

1600 SOUTH DIXIE HWY., SUITE 400  
BOCA RATON, FLORIDA 33432  
PHONE 561-391-0081 FAX 561-391-0085  
EMAIL mail@rwb-arch.com

**RWB**  
Linare  
ARCHITECTURE

PROJECT # 14-067  
DATE 05-19-16  
SHEET #

## LS1.0

JUAN C. LINARES