

SLAB INFILL DETAIL AT SLAB SAW CUTS
SCALE: N.T.S. 6

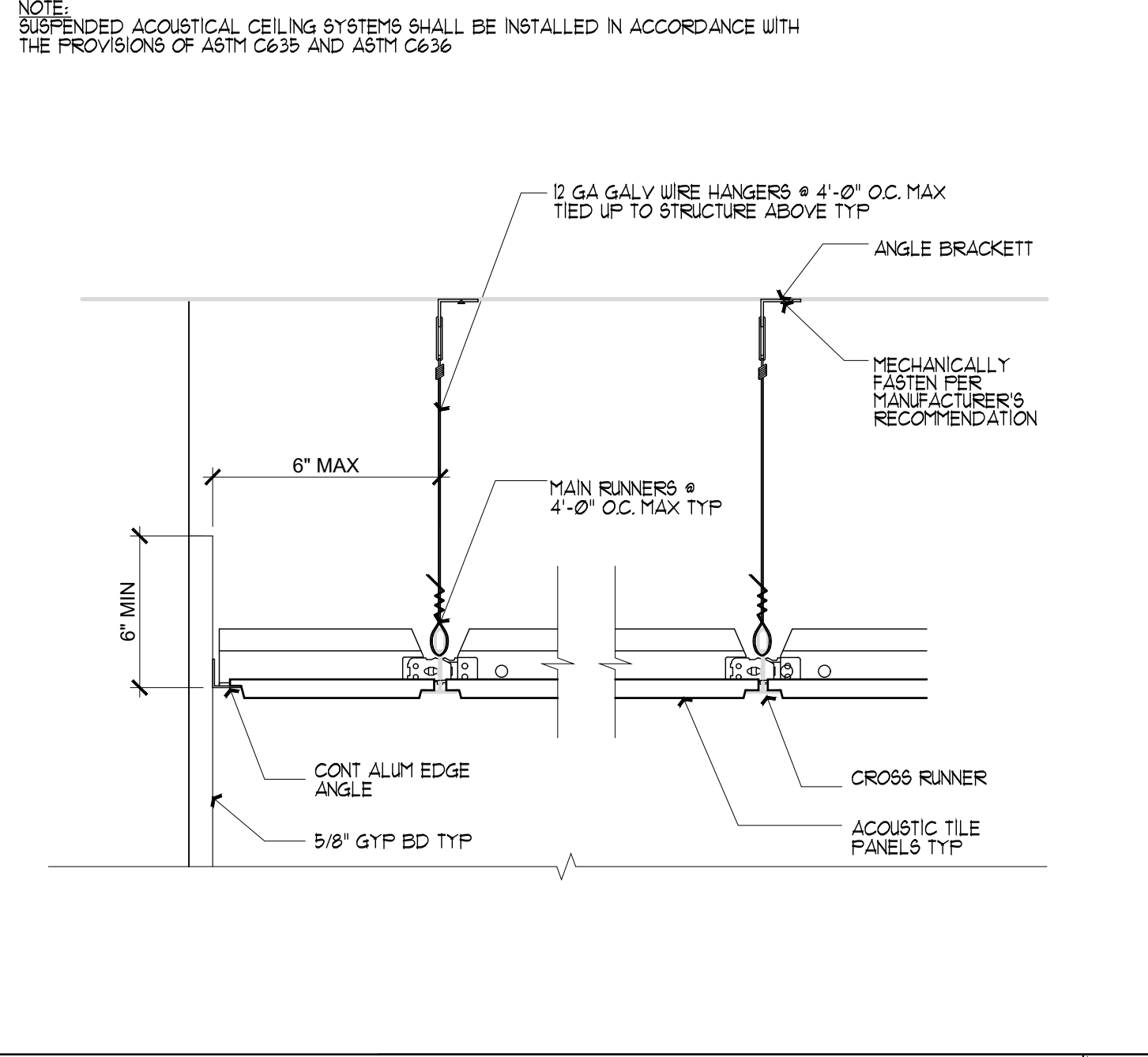

SUSPENDED CEILING DETAIL
SCALE: N.T.S. 7

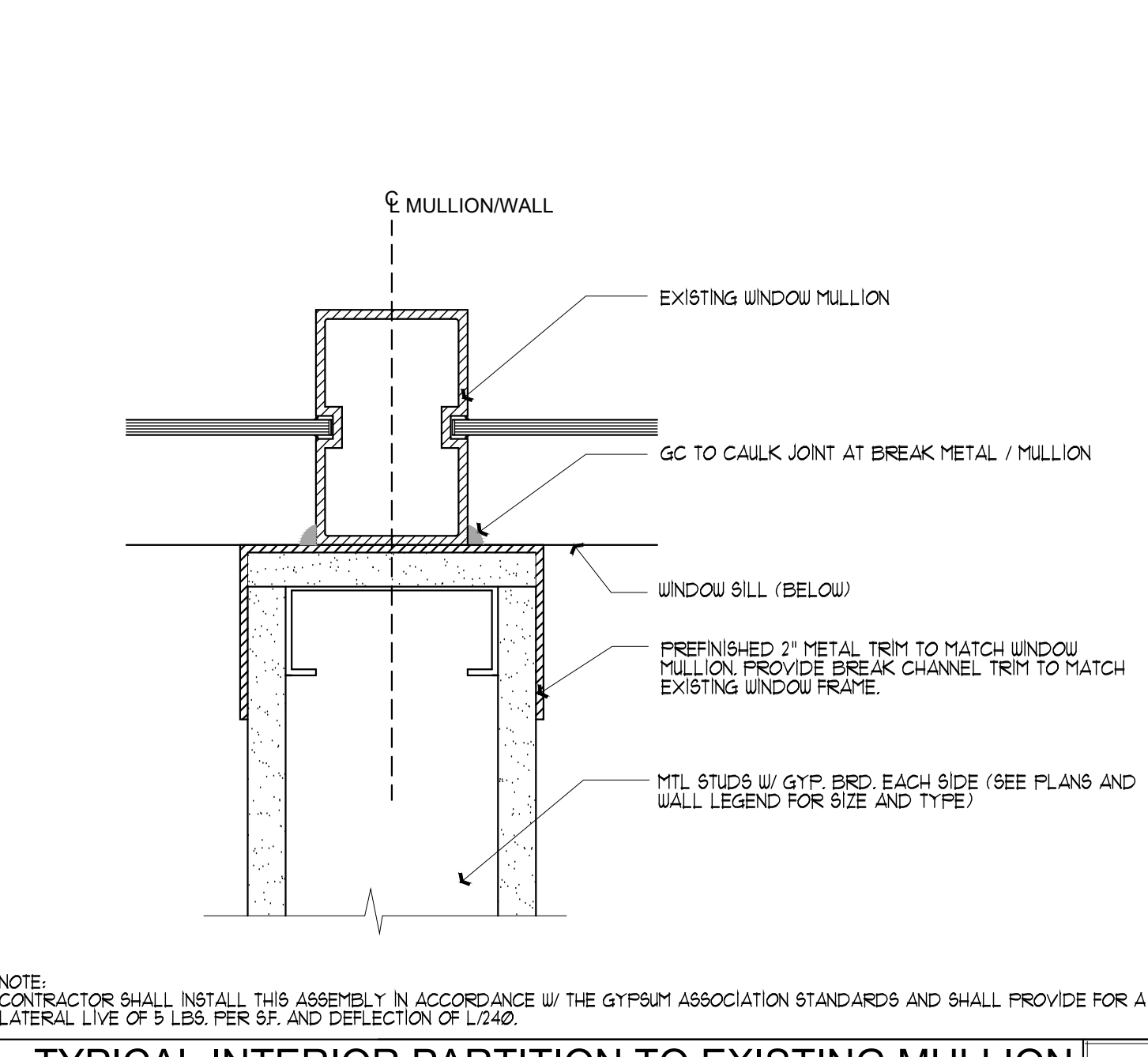

TYPICAL INTERIOR PARTITION TO EXISTING MULLION
SCALE: N.T.S. 8

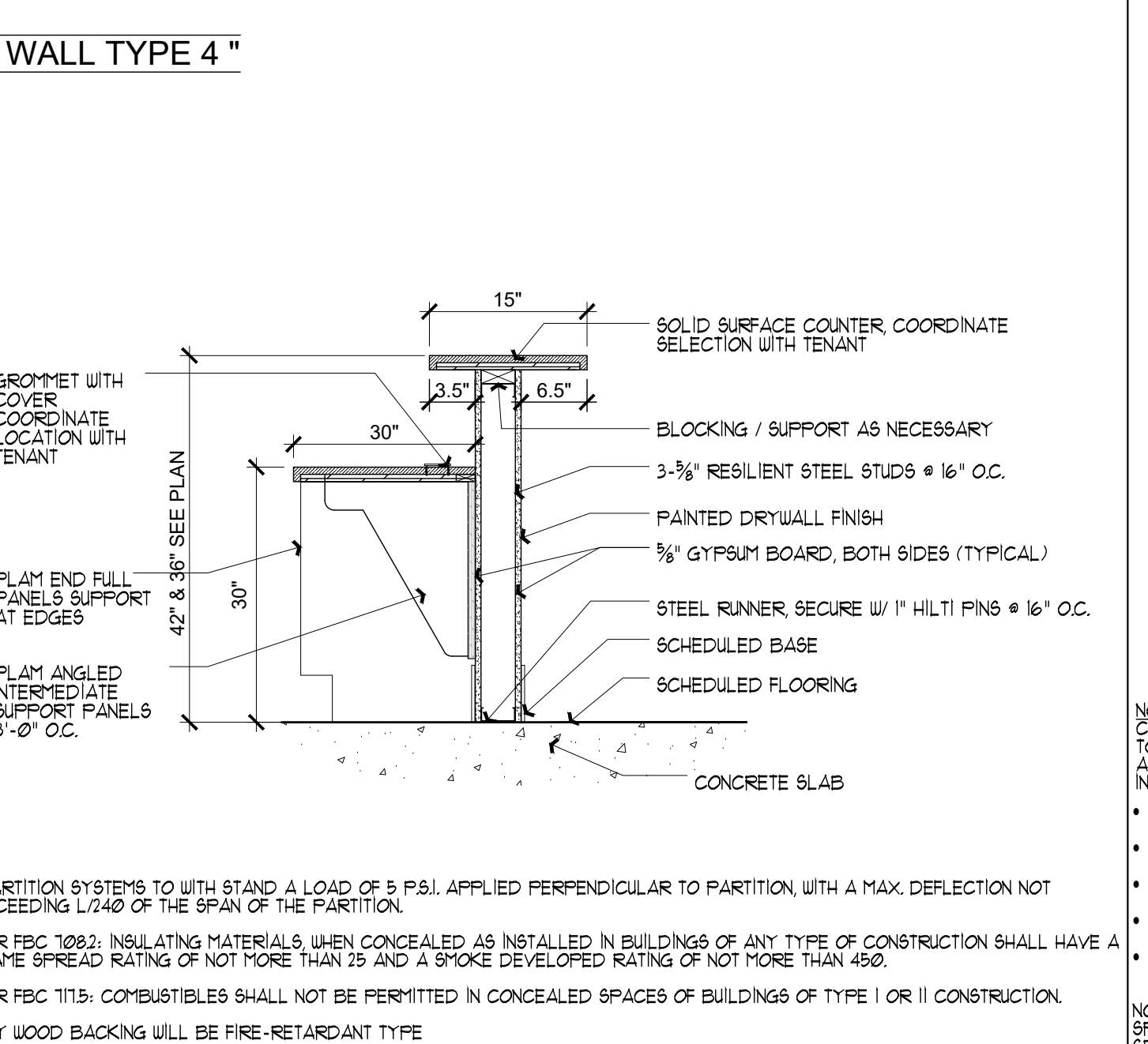

RECEPTION AREA LOW WALL AND COUNTER
SCALE: N.T.S. 4

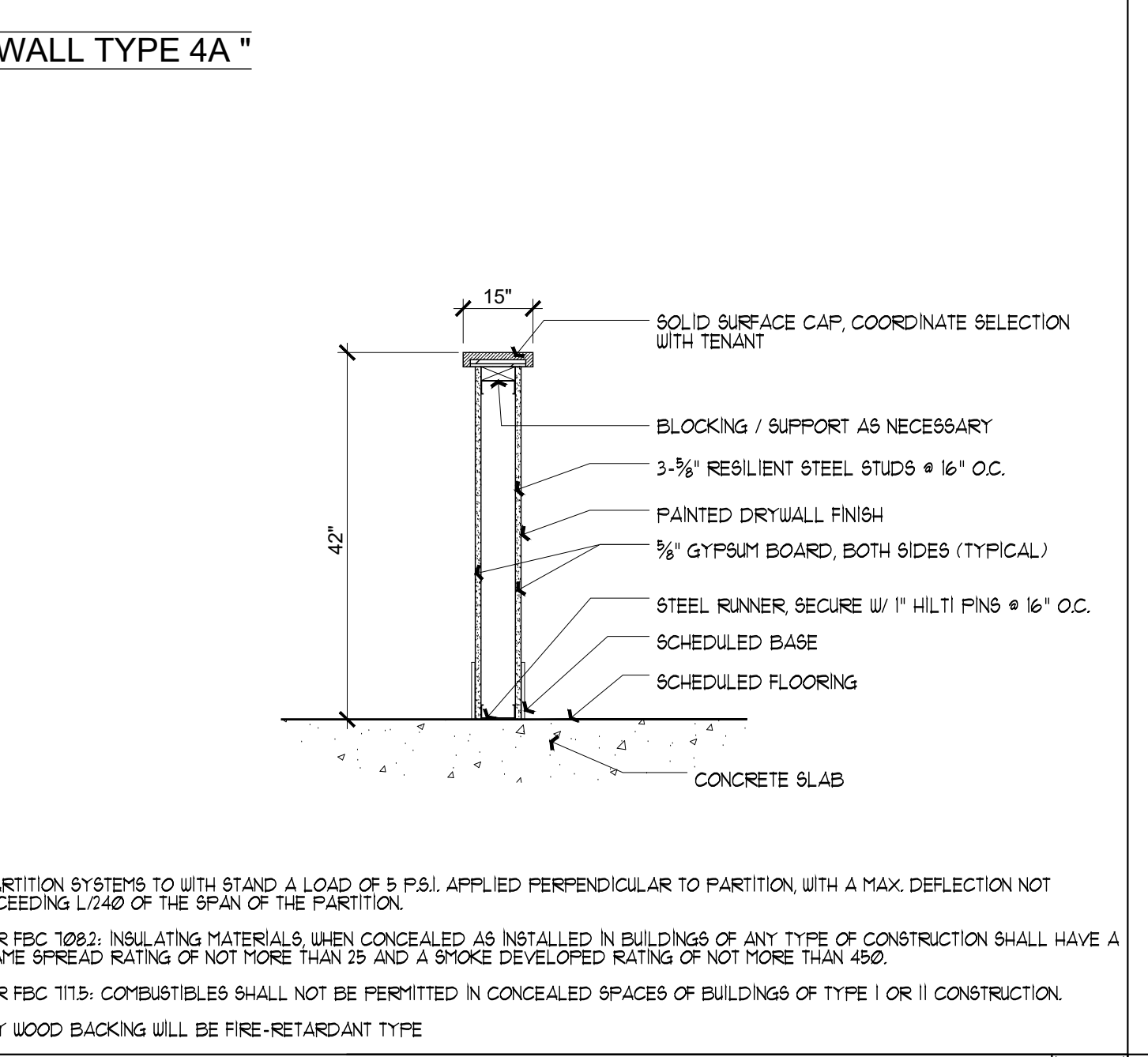

1-HR FIRE-RATED PARTITION U.L. ASSEMBLY #U465
SCALE: N.T.S. 4A

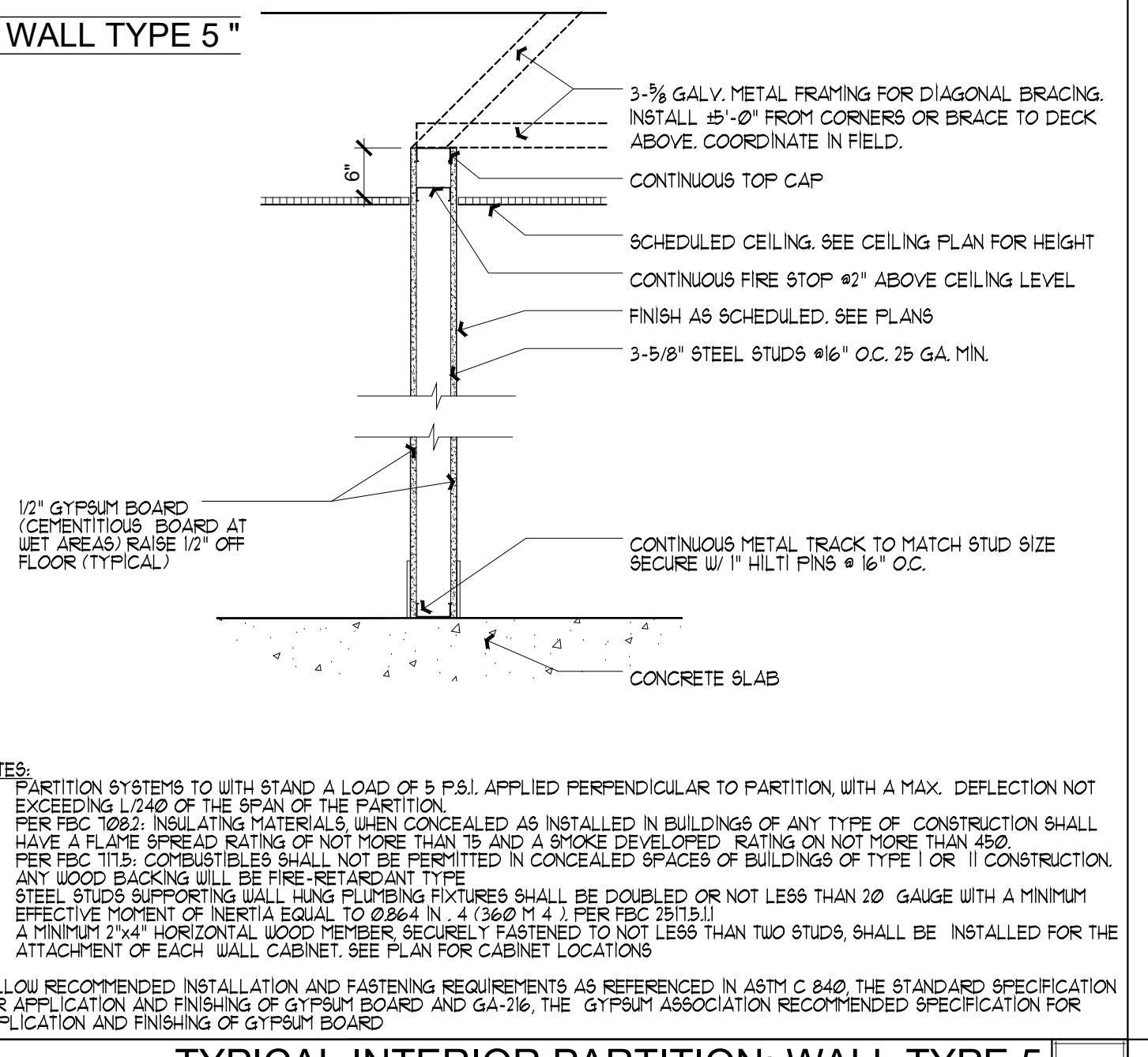

TYPICAL INTERIOR PARTITION: WALL TYPE 5
SCALE: N.T.S. 5

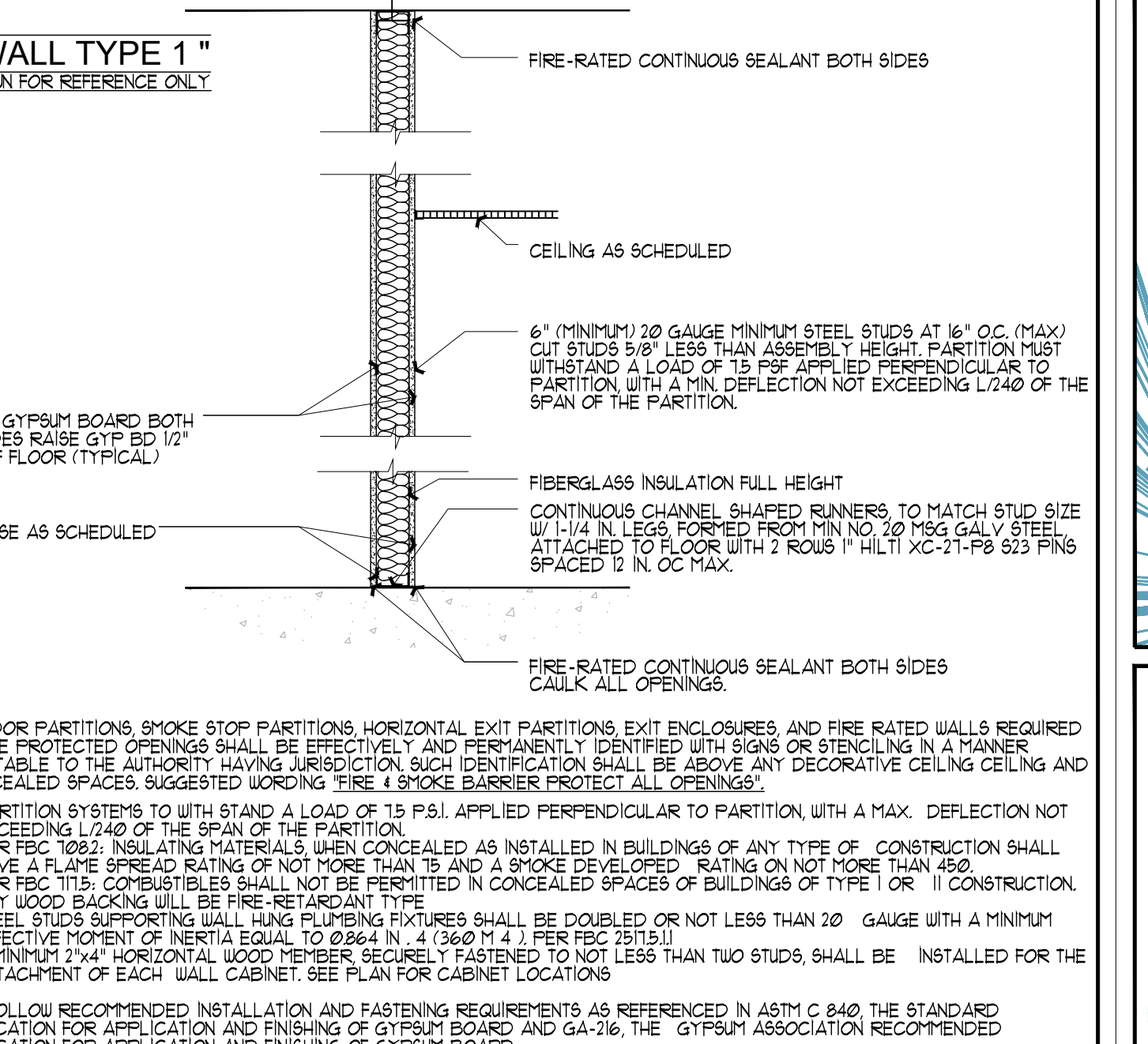

1-HR FIRE-RATED PARTITION U.L. ASSEMBLY #U465
SCALE: N.T.S. 1

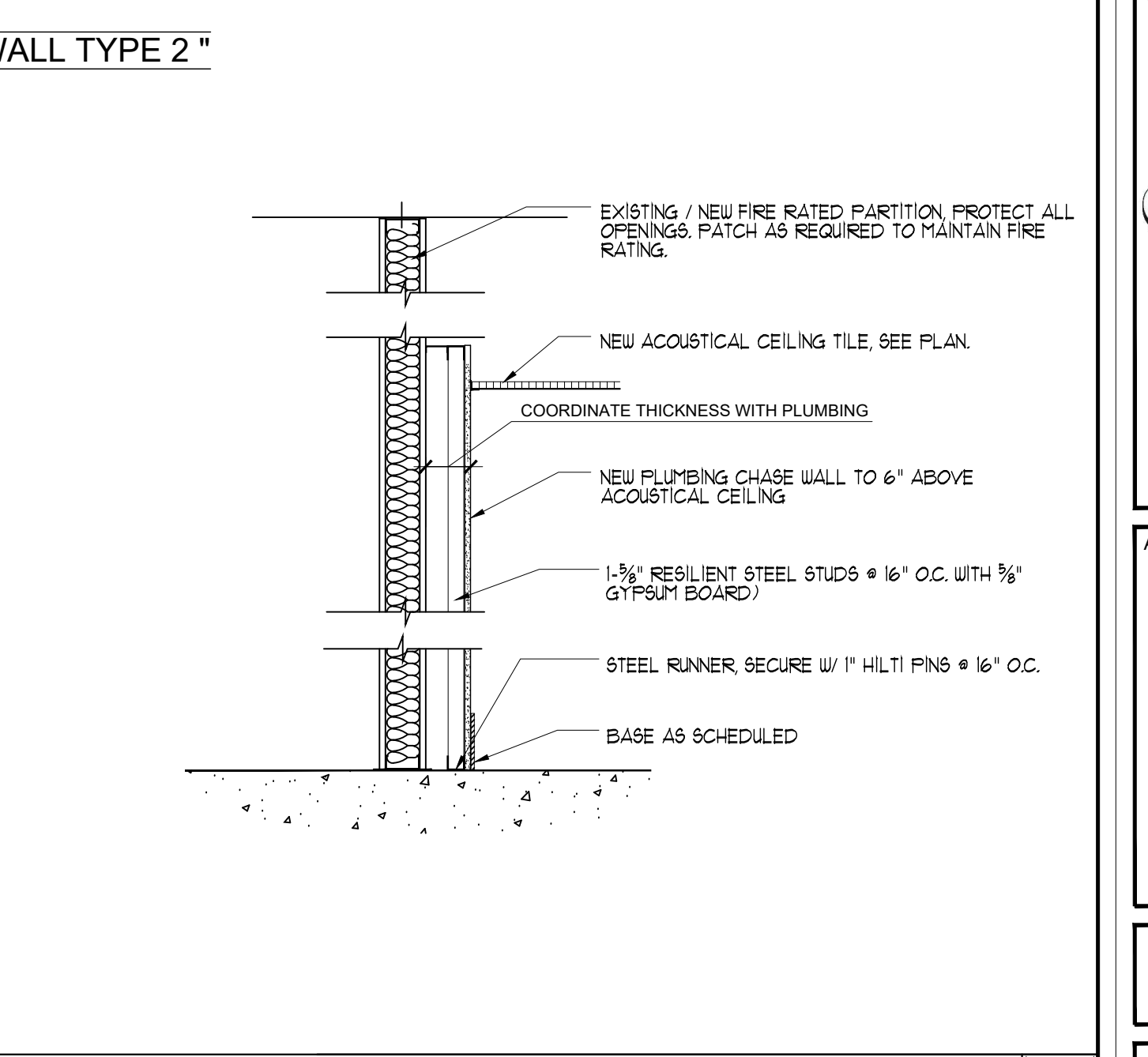

CHASE WALL AT FIRE RATED PARTITION: WALL TYPE 2
SCALE: N.T.S. 2

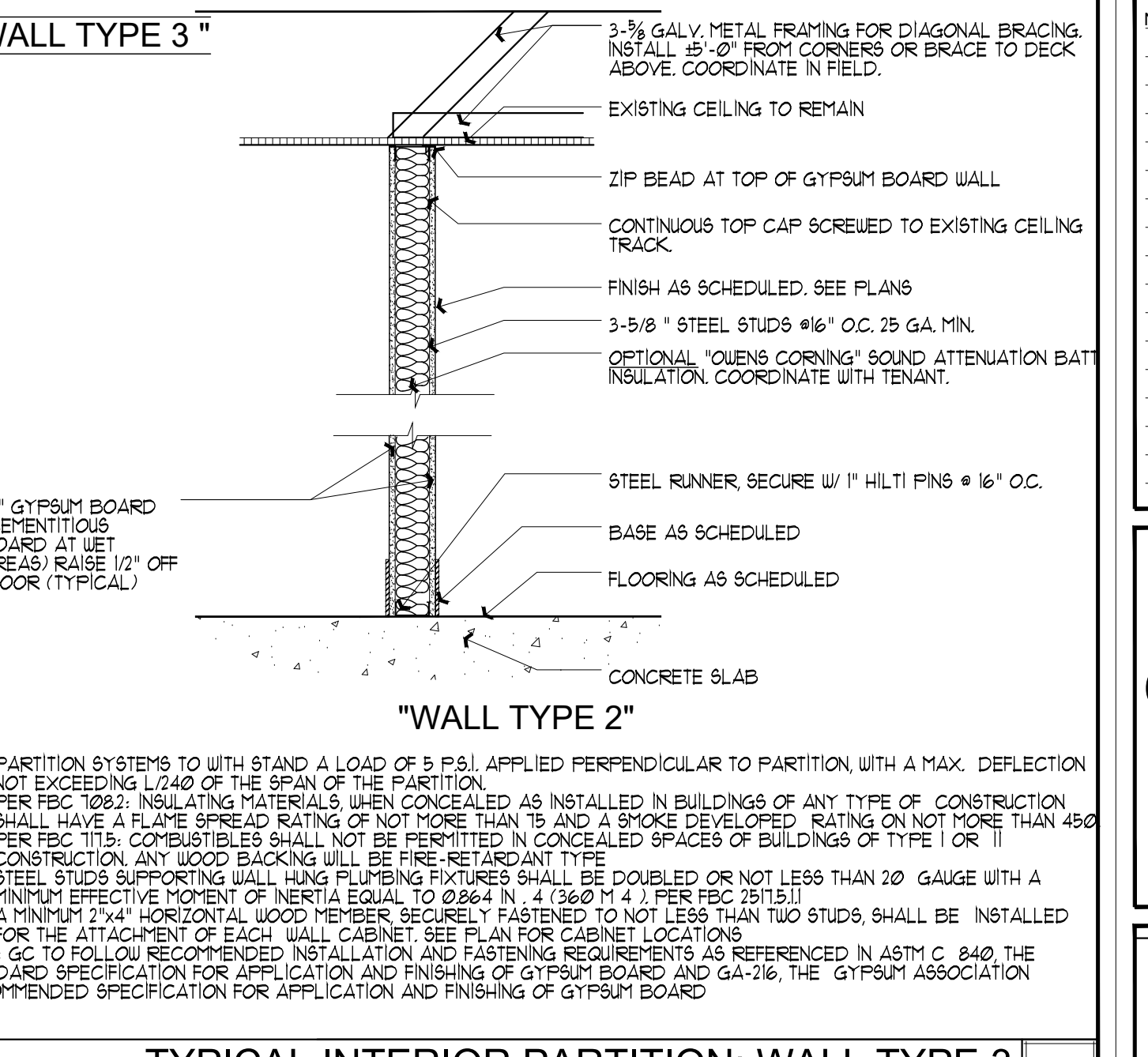

TYPICAL INTERIOR PARTITION: WALL TYPE 3
SCALE: N.T.S. 3

639 E. Ocean Ave. Suite 403
Ft. Lauderdale, FL 33304
www.stevemyott.com
P: 954.754.7054

**STEVEN E. MYOTT
ARCHITECT**

INTERIOR DESIGN

Camp Canine
- INTERIOR RENOVATION -
PENN DUTCH PLAZA
3191 SR7
MARGATE, FLORIDA 33063

ARCHITECT

STEVEN E. MYOTT, ARCHITECT.

AR00014888

ALL DRAWINGS AND WRITTEN MATERIAL APPEARING HEREON CONSTITUTE ORIGINAL AND UNPUBLISHED WORK OF THE ARCHITECT AND MAY NOT BE USED, REPRODUCED OR DISSEMINATED IN ANY FORM WITHOUT THE EXPRESSED WRITTEN CONSENT OF THE ARCHITECT.

PROJECT NO: 16043
DRAWN BY: SV
CHECKED BY: SM

NO. DATE: ISSUED FOR:

1	05.20.2016	PRELIMINARY REVIEW
---	------------	--------------------

CONSTRUCTION DETAILS

A600

PRINTED ON: 5/20/2016