

LOW VOLTAGE REQUIREMENTS

CONTRACTORS RESPONSIBILITIES:

1. PROVIDE AND INSTALL CABLE TRAY, CONDUIT AND JUNCTION BOXES IN WALLS AND ABOVE/BELOW COUNTERS FOR NETWORK DROPS.
2. PROVIDE CONDUIT IN WALLS FROM THE JUNCTION BOX TO ABOVE THE WALL FOR EACH. WHERE CEILING IS PLENUM RATED, PROVIDE CONTINUOUS CONDUIT FOR A WIRING WITHIN CEILING.
3. CONDUIT STUBBED ABOVE THE CEILING SHALL RECEIVE A PLASTIC RING TO PREVENT DAMAGE TO WIRING DUE TO RUBBING THE CUT END OF THE CONDUIT.
4. ALL LOW VOLTAGE CABLES ARE TO BE ROUTED WITHIN THE LOW VOLTAGE CABLE TRAYS TO THE MAXIMUM EXTENT POSSIBLE.
5. PROVIDE AND INSTALL FULLY MONITORED AND CODE APPROVED FIRE ALARM SYSTEM. THE CONTRACTOR IS RESPONSIBLE FOR HIRING A STATE LICENSED FIRE ALARM SYSTEM COMPANY FOR DESIGN AND INSTALLING THE COMPLETE SYSTEM. THE DESIGN AND SUBMITTALS FOR THIS SYSTEM SHALL BE PROVIDED BY THE CONTRACTORS LICENSED FIRE ALARM COMPANY AND SUBMITTED TO ANY AND ALL STATE AND OR LOCAL AGENCIES AS REQUIRED FOR REVIEW AND APPROVAL. A COPY OF THE SUBMITTAL SHALL ALSO BE SUBMITTED TO THE ARCHITECT FOR REVIEW PRIOR TO SUBMITTING TO CODES FOR REVIEW.

OWNER RESPONSIBILITIES:

1. PROVIDE AND INSTALL RAW CABLING FOR DATA (CAT6), VOICE (CAT6), CATV, SURVEILLANCE CAMERAS, DETECTION AND BURGLARY ALARM SYSTEMS. FACEPLATES FOR VOICE/DATA, BLANK WALL PLATE INSERTS AND CAT6 WALL PLATE INSERTS SHALL BE PROVIDED AND INSTALLED BY TENANT.
2. TERMINATE ALL ETHERNET CAT6 CABLE RUNS AT BOTH WORKSTATIONS AND PATCH PANELS ENDS.
3. TERMINATE CATV CABLES.
4. PROVIDE AND INSTALL TV SETS AND DVD PLAYERS.
5. TEST CATV AND MOVIE PLAYER SYSTEM.
6. TERMINATE CCTV CAMERA CABLES, INSTALL CAMERAS, CAMERA POWER AND DVR.
7. PROVIDE AND INSTALL ALL VIDEO SURVEILLANCE CAMERAS, MOUNTS, RECORDER AND DISPLAY.
8. PROVIDE AND INSTALL ACCESS ALARM SYSTEM THAT MEET ALL CODE REQUIREMENTS.
9. PROVIDE AND INSTALL FREEZER TEMPERATURE SENSOR, MONITORS AND ALARMS.
10. PROVIDE AND INSTALL ALL COMPUTERS, PRINTERS, TIME CLOCKS AND OTHER USER EQUIPMENT.
11. PROVIDE AND INSTALL RAW CABLING FOR DATA (CAT 6), VOICE (CAT 6), CATV, SURVEILLANCE CAMERAS, DETECTION AND BURGLARY ALARM SYSTEMS.

OWNER RESPONSIBILITIES FOR NETWORK RACK INSTALLATION: (OWNER TO PROVIDE AND INSTALL)

1. ENCLOSED 19" EQUIPMENT CABINET AND ACCESSORIES.
2. FLOOR BOLTS AND BOLTING OF RACK TO FLOOR.
3. SWITCH METERED PDU WITH ATS.
4. 24 AND 48 PORT PATCH PANELS.
5. 3.5" DIAMETER PVC PACK-TOP CONDUIT (STOVE PIPE).
6. RACK MOUNT UPS.
7. UPS NETWORK MANAGEMENT CARD WITH TEMP SENSOR.
8. PATCH CABLES FOR RACK AND WORKSTATION.
9. CENTRAL TELEPHONE SYSTEM (PBX) AND ACCESSORIES.
10. VIDEO SURVEILLANCE SYSTEM (DVR) AND ACCESSORIES.

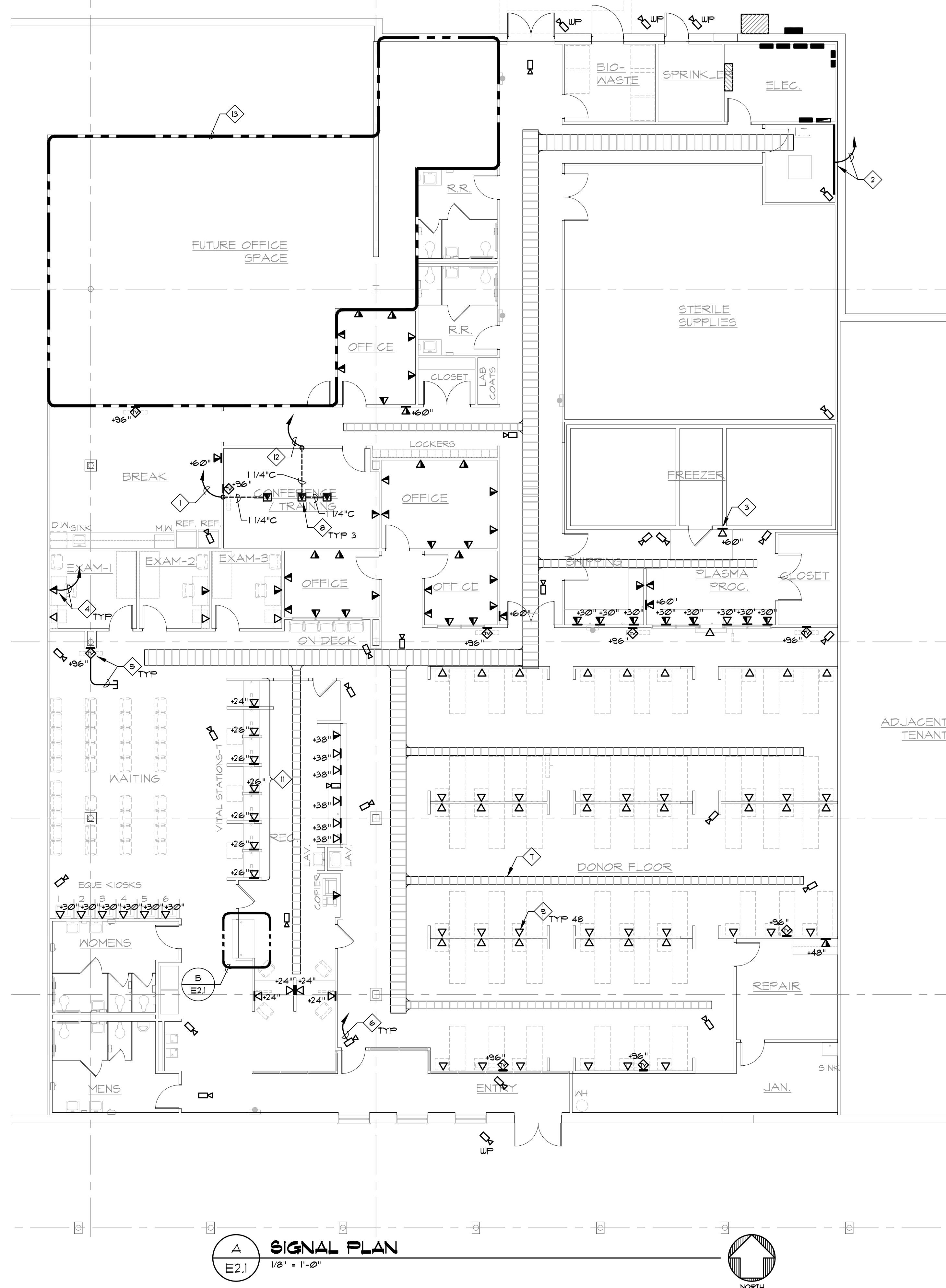

A SIGNAL PLAN
E2.1 1/8" = 1'-0"

GENERAL NOTES:

1. VERIFY LOCATION OF ALL DEVICES WITH ARCHITECT/OWNER'S REPRESENTATIVE PRIOR TO ROUGH-IN.
2. ALL VOICE/DATA CABLES SHALL BE CATEGORY 6. CABLES INSTALLED BY OWNER.
3. THE CONTRACTOR SHALL INSTALL JUNCTION BOXES, RINGS AND CONDUITS FROM OUTLET JUNCTION BOX TO CABLE TRAY. PROVIDE NYLON BUSHING AT CONDUIT END. CONDUITS SHALL BE SIZED APPROPRIATELY TO FACILITATE QUANTITY OF CABLES AS DETERMINED BY THE OWNER'S REPRESENTATIVE.
4. THE OWNER SHALL UTILIZE CABLE TRAY TO ROUTE ALL CABLES FROM THE DEVICE TO THE RACK/TELEPHONE BACKBOARD.
5. THE CONTRACTOR SHALL VERIFY ADDITIONAL REQUIREMENTS WITH THE OWNER'S IT. STANDARD'S PRIOR TO SUBMITTING BID.
6. CABLE TRAY MAIN TRUNKS SHALL BE 12" WIDE. BRANCH TRUNKS SHALL BE 6" WIDE. SUBMIT CABLE TRAY FOR REVIEW.
7. DONOR FLOOR KNEE WALLS AND CONTROL AREA CONDUITS. ROUTE 1" CONDUIT MAXIMUM FOR (6) CAT 6 CABLES OR 3/4" CONDUIT WITH (4) CAT 6 CABLES. CABLE QUANTITY BY OWNER.
8. LOW VOLTAGE DEVICES AND FACEPLATE COLORS SHALL MATCH POWER DEVICE AND FACEPLATE COVERS. PROVIDE WHITE FACEPLATES.
9. ALL DEVICES AND FACEPLATES SHALL BE WHITE. THE CONTRACTOR SHALL COORDINATE BETWEEN ELECTRICAL AND LOW VOLTAGE TRADES TO ENSURE THAT POWER AND LOW VOLTAGE DEVICE AND FACEPLATES MATCH. PROVIDE SAMPLES TO TENANT FOR FINAL COLOR SELECTION.

SHEET NOTES:

1. ROUTE 1 1/4" CONDUIT UP WALL TO CEILING SPACE ABOVE TV LOCATION.
2. PROVIDE 8 1/4" X 3/4" X LENGTH AS INDICATED FIRE-RATED PLYWOOD BACKBOARD WITH 3/4" - 1# CU TO MAIN SERVICE PANEL GROUND BUS. ROUTE (2) 2" CONDUITS TO UTILITY COMPANY SERVICE ENTRANCE. VERIFY ADDITIONAL REQUIREMENTS WITH PHONE COMPANY PRIOR TO ROUGH-IN.
3. PROVIDE DATA OUTLET FOR FREEZER TEMPERATURE MONITORING EQUIPMENT. VERIFY EXACT LOCATION PRIOR TO ROUGH-IN.
4. 3/4" CONDUIT STUB FROM VOICE/DATA OUTLET JUNCTION BOX TO CABLE TRAY. PROVIDE (1) CAT 6 CABLE FOR A SINGLE DATA OUTLET.
5. 3/4" CONDUIT STUB FROM MATV OUTLET TO CABLE TRAY. ROUTE PLENUM RATED RG6 COAX CABLE TO 'TBB' VIA CABLE TRAY. LEAVE 10' OF BLACK CABLE AT TELE ROOM FOR TERMINATION BY OTHERS.
6. ROUTE (1) PLENUM RATED CAT 6 CABLE FROM IP CAMERA TO DATA RACK IN DATA ROOM VIA CABLE TRAY.
7. SUGGESTED BASKET TRAY ROUTING. THE CONTRACTOR SHALL FIELD VERIFY ROUTING WITH THE OWNER'S LOW VOLTAGE CONTRACTOR.
8. DEVICE IS MOUNTED IN A MULTI-COMPARTMENT FLUSH FLOOR STYLE FLOOR BOX. REFER TO E2.0 FOR ADDITIONAL INFORMATION. COORDINATE COVER PLATE STYLE WITH THE INSTALLED FLOOR COVERING TO PROVIDE A FLUSH FLOOR INSTALLATION.
9. PROVIDE 48 JUNCTION BOX WITH SINGLE GANG MUD RING ADJACENT POWER RECEPTACLE FOR PLASMA MACHINE. PROVIDE 3/4" CONDUIT STUBBED FROM JUNCTION BOX TO CABLE TRAY. ROUTE (2) CAT 6 PLENUM RATED CABLES TO DATA RACK VIA CABLE TRAY.
10. PROVIDE 48 JUNCTION BOX MOUNTED BELOW RECEPTION AREA FOR TV CONTROL. VERIFY EXACT MOUNTING LOCATION WITH IMMUNOTEK IT EQUIPMENT INSTALLER. ROUTE 1 1/4" CONDUIT WITH BUSHING TO ABOVE ACCESSIBLE CEILING. PROVIDE ANOTHER 48 JUNCTION BOX ADJACENT TV CONTROL JUNCTION BOX WITH 1" CONDUIT BETWEEN.
11. DEVICES MOUNTED IN MILLWORK. COORDINATE DEVICE LOCATION, CONDUIT ENTRY ETC. WITH THE MILLWORK SHOP DRAWINGS.
12. ROUTE 1 1/4" CONDUIT UP WALL TO CABLE TRAY.
13. AREA NOT IN SCOPE OF WORK.

B ENLARGED SIGNAL PLAN
E2.1 1/4" = 1'-0"

ACKAL A PROFESSIONAL CORPORATION
ARCHITECTS
105 CHAPEL DRIVE - LAFAYETTE, LOUISIANA 70506
337-988-5271 ph. - 337-988-5272 fax
www.ackalarchitects.com

INTERIOR TENANT IMPROVEMENT FOR:
IMMUNOTEK BIO CENTERS, LLC
4550 LAKE NORTH ROAD
OFFICE DEPOT PLAZA, SUITE B-5
LAKE WORTH, PALM BEACH COUNTY, FL 33463



AUG. 02, 2016
COPYRIGHT © 2016 ACKAL ARCHITECTS, APC.
THIS DOCUMENT IS THE PROPERTY OF
ACKAL ARCHITECTS, APC.
THIS DOCUMENT MAY NOT BE COPIED,
REPRODUCED OR USED WITHOUT
WRITTEN CONSENT FROM
ACKAL ARCHITECTS, APC.

proj. no. 16-002
date: 08-02-2016
project architect: B.A.
project manager: A.D.
drawn by: MSA
file name: LAKEWORTH
revised:
plot scale: AS NOTED
sheet name:
SIGNAL
PLAN

sheet no.
E2.1
40 of 42

