

EST. 1988

RICK GONZALEZ, A.I.A.
PRESIDENT AR-0014172
300 CLEMATIS STREET
WEST PALM BEACH
FLORIDA 33401
PH: (561) - 659 - 2383
FAX: (561) - 659 - 5546
www.regarchitects.com

CORPORATION NUMBER
AA-0002447

AMPHITHEATRE
at
COMMONS
PARK

11600 POINCIANA BLVD.
ROYAL PALM BEACH, FL 33411

REVISIONS	NO.
	▲
	▲
	▲
	▲

DATE 06-30-16

SCALE AS NOTED

DRAWN RB/FR/JS

CHECKED DA/SR

REG No. 16028

© 2016

OWNERSHIP AND USE OF THESE DOCUMENTS & SPECIFICATIONS AS INSTRUMENTS OF SERVICE ARE AND SHALL REMAIN THE PROPERTY OF THE ARCHITECT WHETHER THE PROJECT THEY ARE MADE FOR IS EXECUTED OR NOT. THEY SHALL NOT BE USED BY THE OWNER OR OTHERS ON OTHER PROJECTS OR FOR ADDITIONS TO THIS PROJECT BY OTHERS, EXCEPT BY AGREEMENT IN WRITING AND WITH APPROPRIATE COMPENSATION TO THE ARCHITECT.

LIGHTING PLAN

E2.1

LIGHTING CONTROL SYMBOL LEGEND	
	7-DAY FULL YEAR LIGHTING CONTROL WITH ASTRONOMICAL TIME CLOCK
	WALL MOUNTED OCCUPANCY SENSOR SENSOR SWITCH WSD-PDT
	WALL MOUNTED OCCUPANCY SENSOR 2-POLE MODEL - SENSOR SWITCH WSD-PDT-2P CAPABLE OF SWITCHING SEPARATE VOLTAGES ON EACH POLE
	SWITCH
	3-WAY SWITCH
	4-WAY SWITCH
	DIMMER SWITCH
	OVERRIDE SWITCH WITH PILOT LIGHT; 2 HOUR MAX TIME DELAY MODEL (CH-# (OF BUTTONS))
	CEILING MOUNTED OCCUPANCY SENSOR SENSOR SWITCH (CMR_PDT) LINE VOLTAGE
NOTE: ALL SYMBOLS MAY NOT BE USED FOR THIS PROJECT.	

LIGHTING CONTROL SYMBOL LEGEND							
TYPE	DESCRIPTION	MFG	CATALOG NUMBER	VOLTS	LAMPS	WATTS	MOUNTING
(A)	LED DOWNLIGHT	LITHONIA LIGHTING	LDN4 SERIES	120	25W LED	25	CEILING
(B)	WALL MOUNTED FIXTURE	LUMINAIRE LIGHTING	SPC 8 SERIES	120	25W LED	25	WALL
(C)	LED FIXTURE	BEGHELLI LIGHTING	BS 100 LED SERIES	120	80W LED	80	CEILING
(E)	SAME AS TYPE "G" EXCEPT WITH 90 MIN EMERGENCY BACKUP	BEGHELLI LIGHTING	BS 100 LED SERIES	120	80W LED	80	CEILING
(X)	EXIT SIGN	WITH MINIMUM 90 MINUTE BATTERY EVENLITE	TEX SERIES	120	LED		

NOTES:
1. PROVIDE ELECTRONIC BALLAST FOR ALL FLUORESCENT LAMPED FIXTURES.
2. MINIMUM FLUORESCENT LAMP COLOR TEMPERATURE SHALL BE 3500K.
3. VERIFY BALLAST REQUIREMENTS FOR ALL FLUORESCENT FIXTURES. PROVIDE ELECTRONIC DIMMING BALLASTS FOR SPECIFIC FIXTURES INDICATED WITH DIMMER CONTROL.
4. VERIFY ALL FIXTURE SELECTIONS PRIOR TO PURCHASE WITH OWNER/ARCHITECT.

LIGHTING NOTES	
1.	ALL EXIT, EMERGENCY, AND BATTERY PACKS IN FLUORESCENT FIXTURES TO BE WIRED AHEAD OF CONTROL SWITCH.
2.	ALL WALL MOUNTED EMERGENCY LIGHT FIXTURES SHALL BE MOUNTED AT HEIGHTS INDICATED ON THE PLANS.
3.	ALL DIMMER SWITCHES SHALL HAVE A PRESET MINIMUM RATING OF 10 KW.
4.	ALL FIXTURE COUNTS, SELECTIONS, AND EXACT LOCATIONS MUST BE VERIFIED WITH OWNER/ARCHITECT PRIOR TO PURCHASE. CONFIRM ALL LIGHT FIXTURE MODEL NUMBERS, FINISH COLORS AND ELECTRICAL REQUIREMENTS BEFORE ORDERING AND INSTALLATION.
5.	CONTRACTOR TO VERIFY IF ANY LOW VOLTAGE LIGHT FIXTURES REQUIRE STEP-DOWN TRANSFORMERS, QUANTITY AND LOCATION TO BE FIELD VERIFIED PRIOR TO CONSTRUCTION. PROVIDE ALL TRANSFORMERS AND INCLUDE IN BID.
6.	ALL FIXTURES TO HAVE U.L. CERTIFICATION.
7.	ALL EXISTING AND NEW LUMINAIRES SHALL COMPLY WITH SECTION 4.10.130(G) DISCONNECTING MEANS OF THE NEC.
8.	CONTRACTOR TO PROVIDE LUMINAIRES TO CONFORM TO ENERGY CODE, THERMAL ENVELOPE RATINGS.

ENERGY COMPLIANCE NOTE	
1.	AN AUTOMATIC TIME CLOCK SHALL BE THE MEANS OF LIGHTING SHUTOFF PER FBC ENERGY CONSERVATION SECTION FOR ALL AREAS WHERE OCCUPANCY SENSORS ARE NOT USED, AND IT SHALL CONTAIN AN ASTRONOMICAL TIMECLOCK TO SHUT THE TENANT SPACE DOWN AT A SCHEDULED TIME OF DAY.
2.	ALL LIGHT CIRCUITS THAT ARE NOT WIRED THROUGH THE ASTRONOMICAL TIME CLOCK SHALL BE CONTROLLED BY OCCUPANCY SENSORS WHICH MUST TURN LIGHTS OFF WITHIN 30 MINUTES AFTER AN OCCUPANT LEAVES THE SPACE.
3.	RECORD DRAWINGS OF INSTALLATION AND OPERATION MANUALS ARE TO BE PROVIDED TO THE OWNER AS SPECIFIED IN FLORIDA BUILDING CODE ENERGY CONSERVATION SECTION.

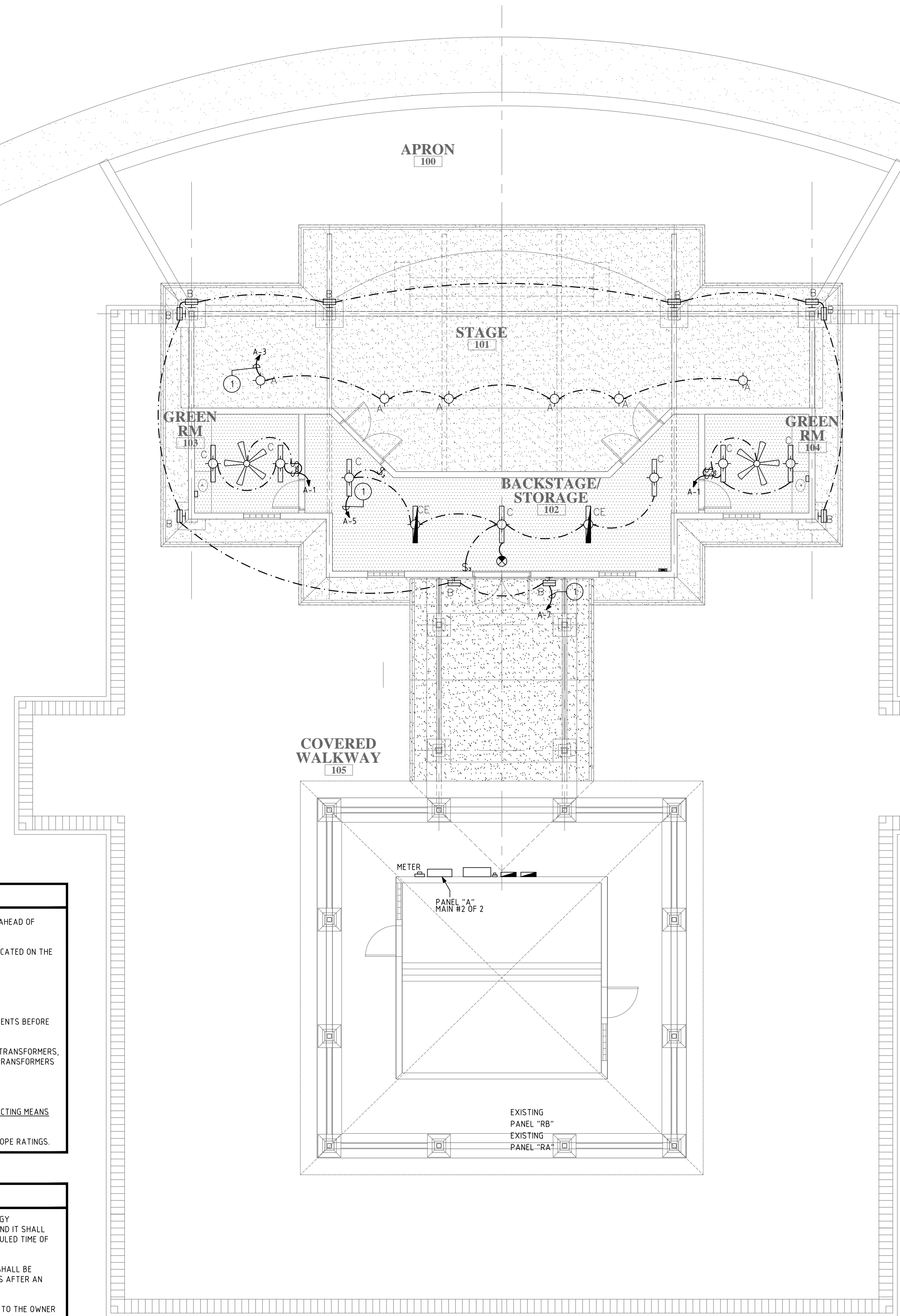

LIGHTING PLAN
1/8" = 1'-0"

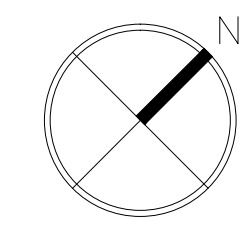

PROGRESS OR CHECK SETS, BY THEIR NATURE, MAY BE INCOMPLETE AND ARE NOT TO BE USED FOR BIDDING OR CONSTRUCTION. CONTRACTOR RECOGNIZES HIS SOLE RESPONSIBILITY TO INCLUDE ALL CONTINGENCIES FOR DESIGN AND INSTALLATION TO MEET THE PROJECT REQUIREMENTS IN ANY PRICING EXERCISE.

PRIOR TO SUBMITTING THE BID, THE CONTRACTOR SHALL FIELD VERIFY ALL EXISTING CONDITIONS AND INFORM THE ARCHITECT AND THE ENGINEER OF ANY DISCREPANCY BETWEEN THESE DOCUMENTS AND THE EXISTING CONDITIONS AND SHALL INCLUDE IN THE BID TO CORRECT THE SAME AS DIRECTED. THE ENGINEER AND THE ARCHITECT, ARE NOT RESPONSIBLE FOR ANY ADDITIONAL COSTS RESULTING FROM VERIFIABLE EXISTING CONDITIONS DISCOVERED AFTER CONTRACT HAS BEEN AWARDED. NO CHANGES SHALL BE MADE TO THESE PLANS WITHOUT PRIOR APPROVAL FROM THE ENGINEER OF RECORD. ALL CHANGES SHALL BE SUBMITTED FOR REVIEW PRIOR TO INSTALLATION. NOT FOR BID UNTIL PERMIT HAS BEEN ISSUED.

PROGRESS SET: 08/22/16

FRAE CONSULTING

700 WEST HILLSBORO BLVD. - BLDG. #1, SUITE 204
DEERFIELD BEACH, FLORIDA 33441
TEL: (561) 391-9292 FAX: (561) 391-9898
CERTIFICATE OF AUTHORIZATION NO. 28107
LIRIBILA IAPRARE, P.E. LICENSE #72122
STEPHEN F. ROLLIN, P.E. LICENSE #36428
DONALD H. AUSTIN, JR., P.E. LICENSE #60651
JASON BARBER, P.E. LICENSE #73050
EMAIL: INFO@FRAECONSULTING.COM
DESIGNED BY: RB/SK/JS PM: BJ P/N 16028