

| Drawing List | | |
|--------------|--|---------|
| A1. | Building Location Plan/ Project Data..... | 9-15-16 |
| A1.1 | Structural Details | 9-15-16 |
| A1.2 | Specifications & Notes | 9-15-16 |
| A1.3 | Specifications & Notes (PGT) | 9-15-16 |
| A1.4 | Specifications & Notes (PGT) | 9-15-16 |
| A2. | Exist./Demo Plan (Building 1-6) Elevations | 9-15-16 |
| A3. | Proposed (Building 1) Elevations..... | 9-15-16 |
| A4. | Proposed (Building 2) Elevations..... | 9-15-16 |
| A5. | Proposed (Building 3) Elevations..... | 9-15-16 |
| A6. | Proposed (Building 4) Elevations..... | 9-15-16 |
| A7. | Proposed (Building 5) Elevations..... | 9-15-16 |
| A8. | Proposed (Building 6) Elevations..... | 9-15-16 |
| A9. | Exist./Demo Plan (Building 7) Elevations..... | 9-15-16 |
| A10. | Proposed Elevations..... | 9-15-16 |
| A11. | Proposed Elevations..... | 9-15-16 |

SCOPE OF WORK

- **DEMO:** REMOVE EXISTING WINDOWS AND SHUTTERS ONLY
- **WINDOWS:** REPLACE WITH NEW IMPACT RESISTANT WINDOWS PER CH.6 OF THE FLORIDA BUILDING CODE "EXISTING" AND CH.16 F.B.C. "BUILDING"
- **REPAIR:** REPAIR DAMAGED STUCCO AND PAINT. REPAIR INTERIOR G.W.Bd. AND PRIME ONLY.
- THERE IS NO ADDITIONAL SQUARE FOOTAGE ADDED.

ZONING DATA: (City of Delray Beach)

Property zoning RM
Medium Density Residential (12-Delray Beach)

LEGAL DESCRIPTION:

28-46-43, N. 500 FT. OF S. 1100 FT. GOV. LTS 1 & LYG E. OF INTRACOASTAL WATERWAY & W. OF SR 5 (LESS BERMUDA HIGH WEST CO.)

STRUCTURAL DATA:

- | | |
|----------------------------------|--------------|
| 1. Basic Wind Speed | 170 |
| 3 sec gust | |
| 2. Wind Importance Factor | 1.0 |
| 3. Risk Category | II |
| 4. Wind Exposure | C |
| 5. Internal Pressure Coefficient | ± 0.18 |
| 6. Building design | Enclosed |
| 7. Soil Bearing capacity min. | 2,500 p.s.f. |
| 8. Structural Loads | |

APPLICABLE CODES:

1. Florida Building Code 2014 Edition
2. A.C.I. 318-08 for reinforced concrete.
3. A.C.I. 315-92 details and detailing of concrete reinforcement or manual of standard. Practice for detailing reinforced concrete structures.
4. A.C.I. 530-08 and A.C.I. 530.1-08 for reinforced masonry.
5. A.I.S.C. Steel Construction A.S.D. for Structural Steel, Ninth Edition.
6. ANS/AWS D1.4.
7. A.S.C.E. 7-10 for Wind Analysis and Design.
8. A.S.T.M. Standards and Specifications. American Society for Testing and Materials.
9. American Forest and Paper Association: National Design Specification for Wood Construction.
10. APA. The Engineered Wood Association.
11. National Pest Control Association Standards.

SITE NOTES:

1. THERE IS NO ADDITIONAL S.F. ADDED.
2. THERE IS NO LANDSCAPE.
3. THERE IS NO IRRIGATION.
4. THERE IS NO WATER/ SEWER/ PAVING/ DRAINAGE.



LOCATION MAP

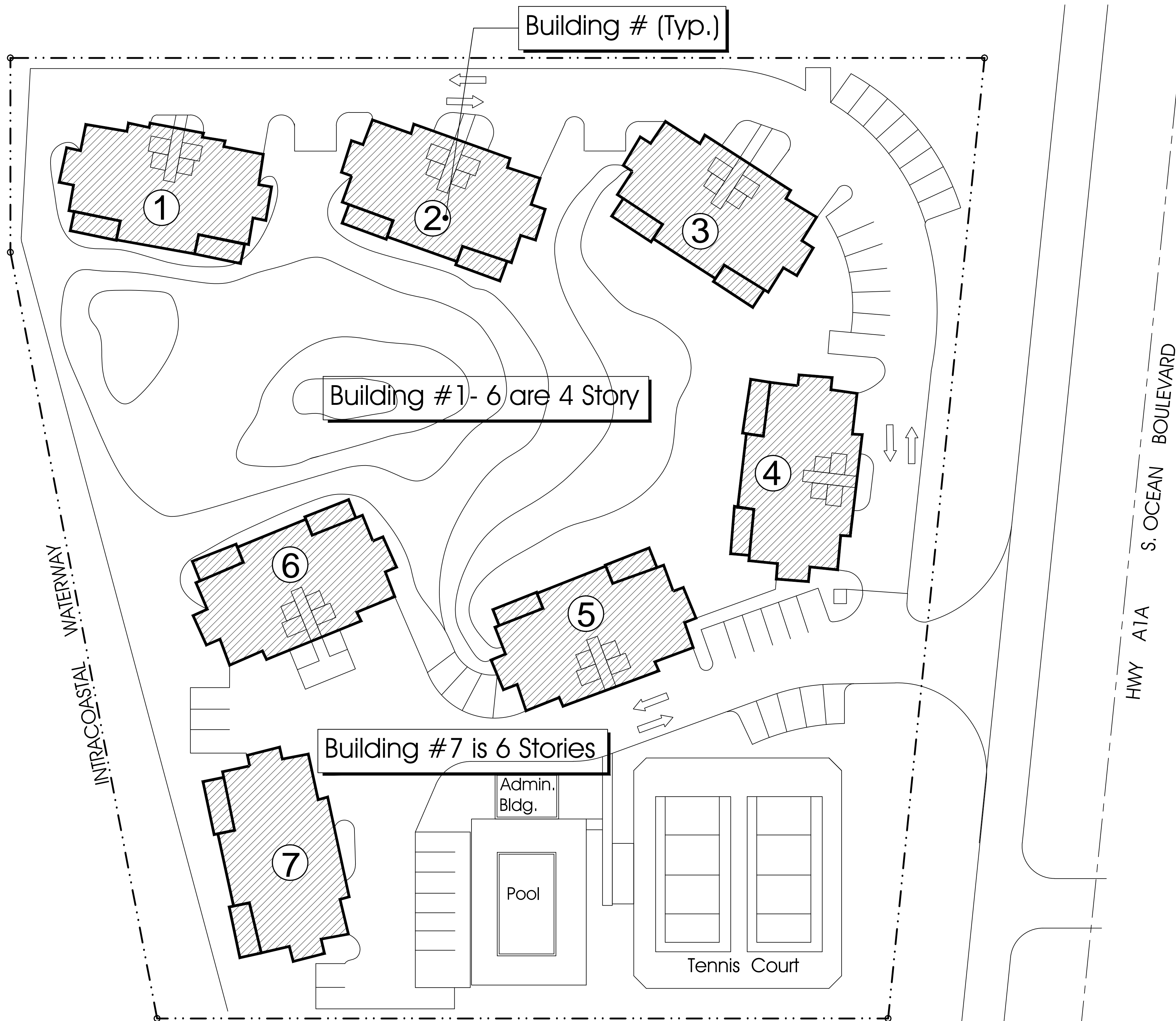

Site Location Plan
1/32" = 1'-0" SC

Window Replacement and Repair for: Bermuda High Condominium

2150 South Ocean Blvd. · Delray Beach · FL

ARCHITECTURE
RICK BRAUTIGAN
1025 S Dixie Highway
Delray Beach, FL 33483
Ph: 561.272.9086
Fx: 561.272.5636
AAC002029

Date:
Mark Duckett,
P.E., S.I., S.E.S.C.
consulting Structural Engineer
3844 N.W. 43rd Terr.
Coconut Creek, FL.
FL Registration P.E. #45196
S.I. #1040

Bermuda High West
2150 S. Ocean Boulevard
Delray Beach,
Florida
RBA: PN: 11616.04

Issued

- ⊙ : Permit Set
- ⊙ : G.C. Bid Set
- ⊙ : Owner Review
- 9-15-16: Structural Review

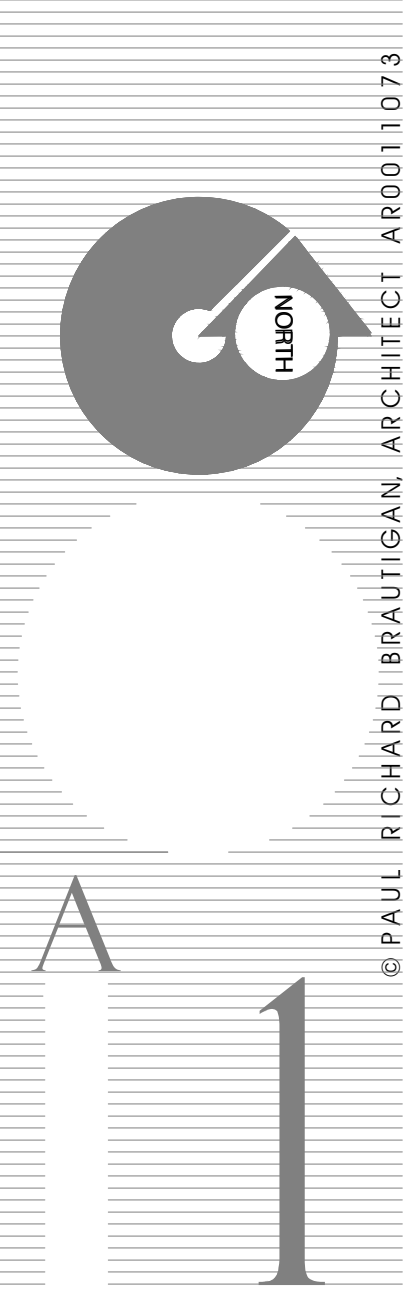

ALL DESIGN, CONCEPTS, AND IDEAS CONTAINED AND REPRESENTED HEREIN ARE THE PROPERTY OF RICK BRAUTIGAN ARCHITECTURE, INC. AND ANY NOT BE ALTERED, CHANGED, REPRODUCED OR COPIED WITHOUT THE PERMISSION OF RICK BRAUTIGAN ARCHITECTURE, INC. EXPRESSED IN WRITING. 1. DRAWINGS ARE NOT TO BE SCALED. WRITTEN DIMENSIONS HAVE PRECEDENCE OVER ALL SCALED DIMENSIONS. 2. CONTRACTOR TO VERIFY ALL DIMENSIONS AND ADVISE ARCHITECT OF ANY DISCREPANCIES. CONSTRUCTION SHALL NOT PROCEED UNTIL SAID DISCREPANCIES HAVE BEEN RESOLVED. 3. NO MATERIALS OR SYSTEMS ARE TO BE FABRICATED UNTIL ALL DIMENSIONS HAVE BEEN VERIFIED BY CONTRACTOR BY SHOP DRAWINGS HAVE BEEN REVIEWED AND ACCEPTED BY THE ARCHITECT