

SEMINOLE PRATT AND WHITNEY ROAD

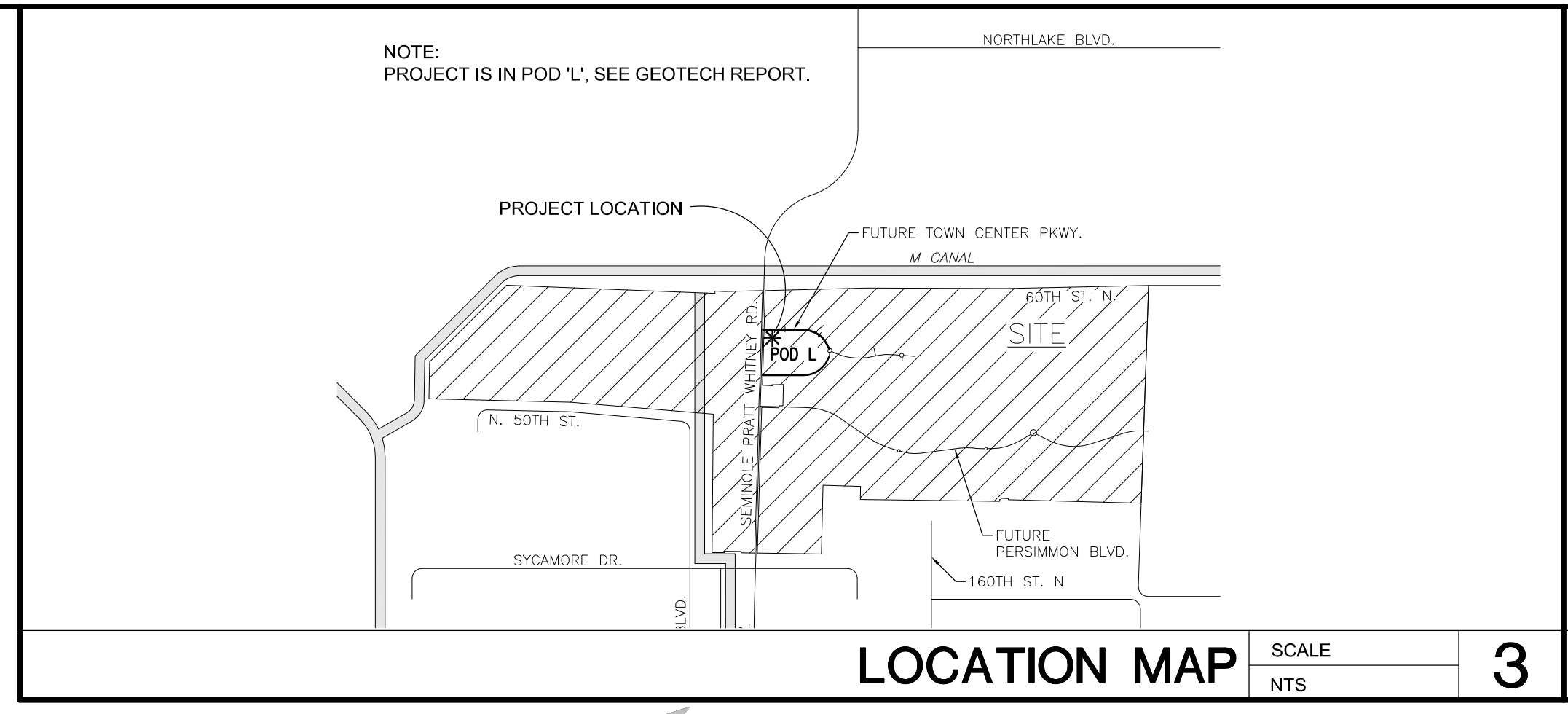

LOCATION MAP SCALE 3 NTS

1. SITE PLAN IS DIAGRAMMATIC INFORMATION TAKEN FROM CIVIL ENGINEERING DRAWING AS PREPARED BY SIMMONS AND WHITE. INFORMATION SHOWN MAY NOT BE CURRENT. GC TO OBTAIN LATEST CIVIL DRAWINGS AND COORDINATE AS REQUIRED.

2. LANDSCAPE INFORMATION IS DIAGRAMMATIC INFORMATION TAKEN FROM LANDSCAPE DRAWING AS PREPARED BY DS BOCA. INFORMATION SHOWN MAY NOT BE CURRENT. GC TO OBTAIN LATEST LANDSCAPE DRAWINGS AND COORDINATE AS REQUIRED.

GENERAL NOTES SCALE 2 NTS

api+

2709 Rocky Point Dr. 201 T 813 + 281 9299
Tampa, Florida 33607 USA F 813 + 281 9292
License No AAC001935 **apiplus.com**

BULLETIN LOG



WESTLAKE VISITOR CENTER
CITY OF WESTLAKE
PALM BEACH COUNTY, FLORIDA

ISSUE DATE: - 09-30-16
ISSUED FOR:
PERMIT - BUILDING SHELL ONLY
© AS DATED ARCHITECTURE PLUS INTERNATIONAL, INC.



REVISION LOG

STATE REGISTRATIONS

FL #AAC001935 NC #8581
SC #6109 GA #10079
TN #00102675

Juan F. Romero AIA License No. AR000793

WESTLAKE VISITOR CENTER
PROJECT NAME

SITE PLAN
SHEET NAME

PROJECT NUMBER: 2016.037
DRAWN BY: DF/CV CHECKED BY: TM/PC
SCALE: AS NOTED

SP1.00
SHEET NUMBER

SITE PLAN SCALE 1 1" = 20'-0"