

Luminaire Schedule									
Project: ACTIVITY CENTER FOR FLORENCE FULLER CHILD DEVELOPMENT CENTER (WEST CAMPUS) - SITE BOCA RATON, FL 10/20/2016									
Symbol	Qty	Label	Arrangement	Manufacturer	Description	Lum. Lumens	LLF	Lum. Watts	
SA	9	SA	SINGLE	Lithonia Lighting	DSX1 LED 30C 1000 50K T3M MVOLT HS MH: 25' POLE MOUNT A.F.G.	9004	0.855	105	
SB	2	SB	SINGLE	Lithonia Lighting	DSX1 LED 60C 1000 50K T3M MVOLT MH: 25' POLE MOUNT A.F.G.	23461	0.855	209	
SC	4	SC	SINGLE	Lithonia Lighting	DSX1 LED 30C 1000 50K T3M MVOLT MH: 25' POLE MOUNT A.F.G.	11333	0.855	105	
SD	3	SD	SINGLE	Lithonia Lighting	DSX1 LED 40C 1000 50K T3M MVOLT MH: 25' POLE MOUNT A.F.G.	15941	0.855	138	

ZONING: IL
LAND USE: IND
EXISTING USE: INDUSTRIAL PARK
BOCA COMMERCE PARK
CONTOL #88-00068
RESO #1991-1224

BOCA COMMERCE PARK

S.W. 185th STREET

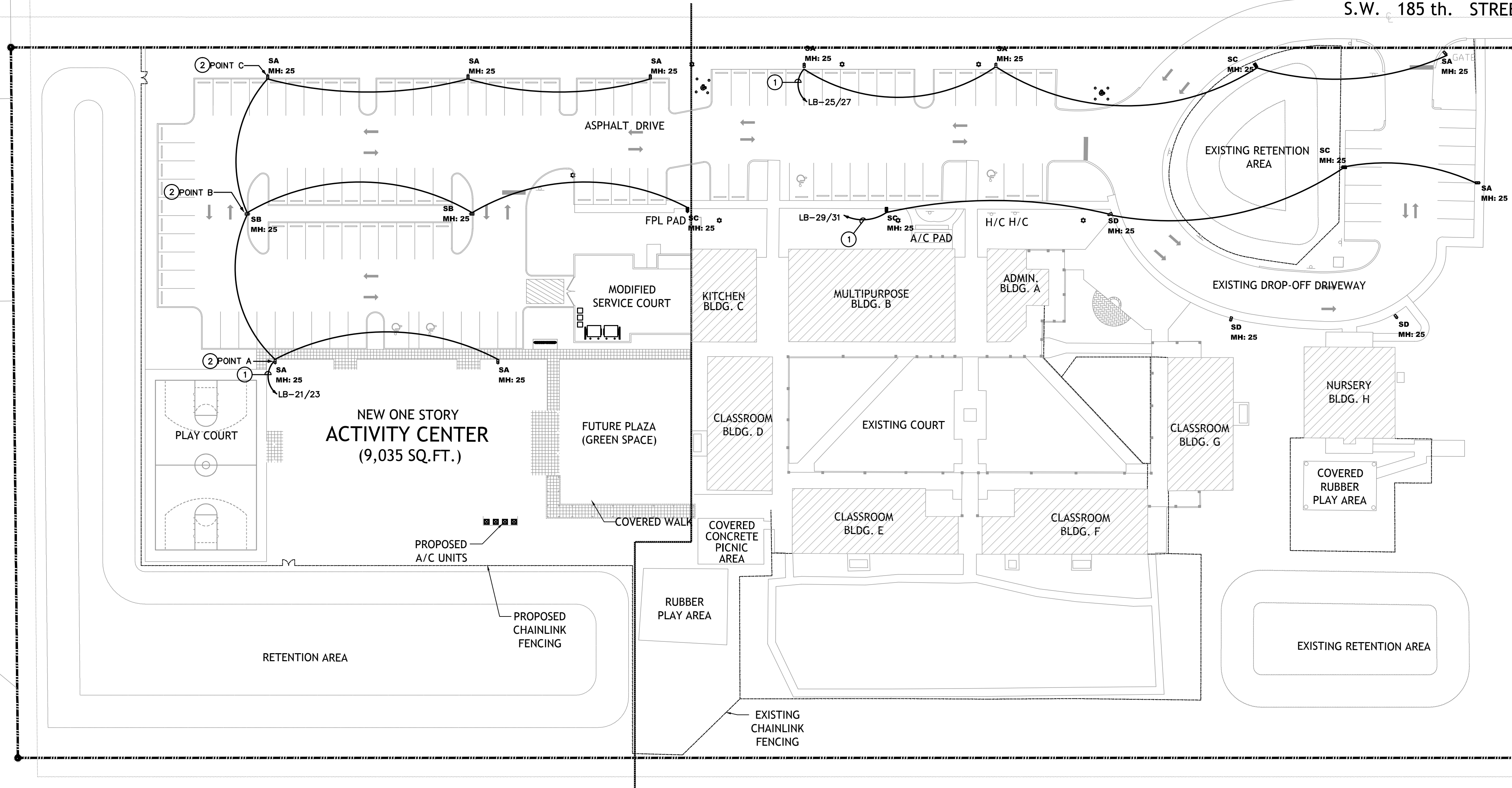

LIGHTING PLAN
1/32"=1'-0"
NORTH

ZONING: PO
LAND USE: LR3
EXISTING USE: LIBRARY
PALM BEACH COUNTY LIBRARY
CONTOL # 06-174
RESO # 2010-0001

COUNTY LIBRARY

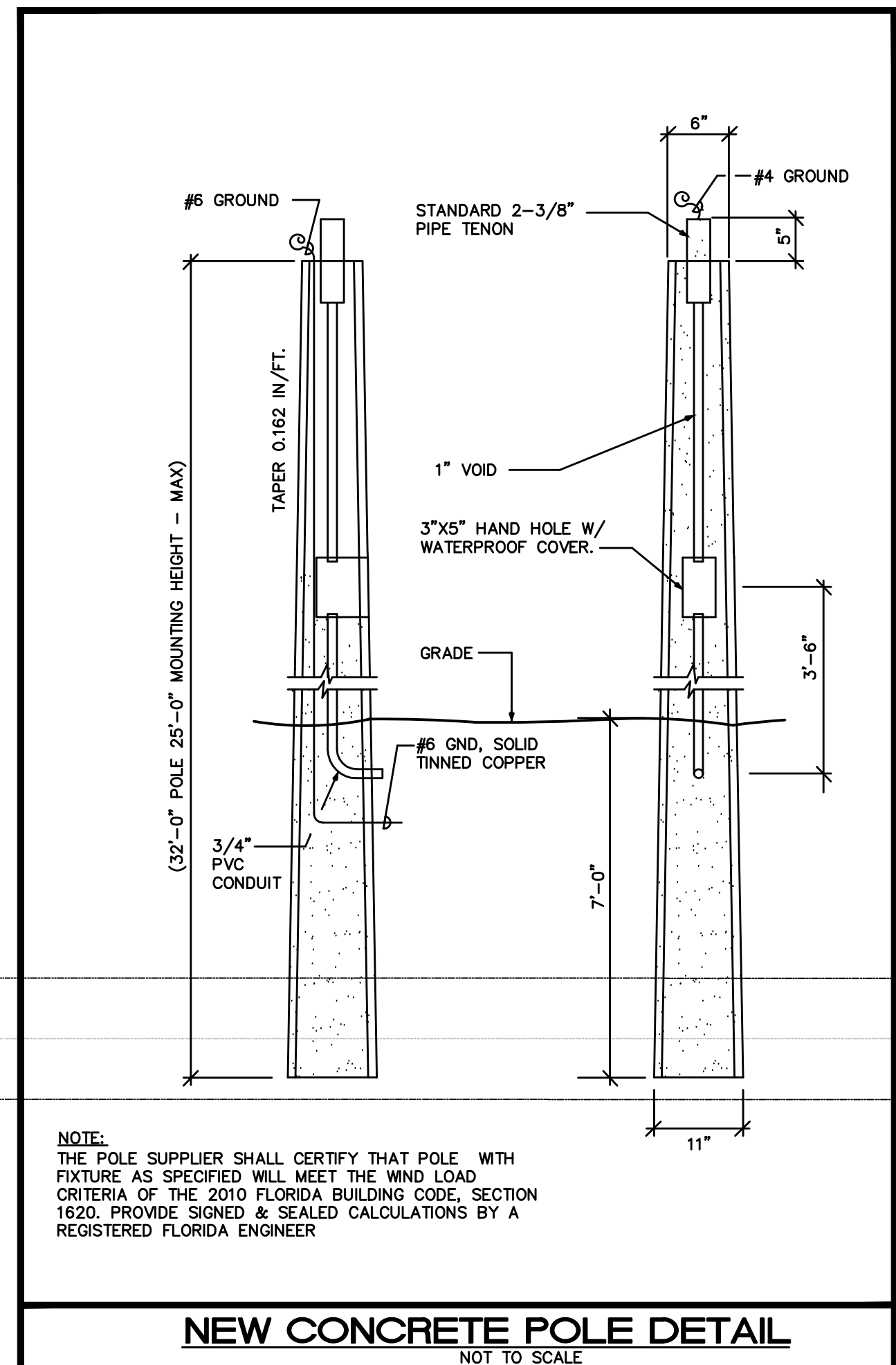

NOTE:
THE POLE SUPPLIER SHALL CERTIFY THAT POLE WITH FIXTURE AS SPECIFIED WILL MEET THE WIND LOAD CRITERIA OF THE 2010 FLORIDA BUILDING CODE, SECTION 1620. PROVIDE SIGNED & SEALED CALCULATIONS BY A REGISTERED FLORIDA ENGINEER

NEW CONCRETE POLE DETAIL
NOT TO SCALE

ZONING: AR
LAND USE: LR3
EXISTING USE: VACANT
CONTROL # N/A
RESO # N/A

KEY NOTES

- ① WIRE CIRCUIT THROUGH LIGHTING CONTROL PANEL. SEE DETAIL ON SHEET ES.1.
- ② SEE SHEET ES.1 FOR SITE LIGHTING VOLTAGE DROP CALCULATIONS.

REVISIONS	BY

Slattery & Associates
ARCHITECTS PLANNERS
2060 NW BOCA RATON BLVD.
SUITE 2
BOCA RATON, FL 33431
TEL: 561-392-3848
FAX: 561-392-5402
WWW.SLATTERYARCHITECTS.COM

ACTIVITY CENTER FOR FLORENCE FULLER CHILD DEVELOPMENT CENTERS WEST CAMPUS S.W. 185TH STREET BOCA RATON, PALM BEACH COUNTY, FLORIDA

BIDDING NOT FOR CONSTRUCTION
DATE OF SEAL: 4/2/08
SLATTERY & ASSOCIATES
FLORIDA REGISTRATION # AA0003381

ISSUED FOR PERMIT
ISSUED FOR CONSTRUCTION
KAMM CONSULTING PROJECT #: 2016-0024
PROJECT MANAGER: JOHN CHIROWIN
KAMM Consulting
1407 West Newport Center Drive
Deerfield Beach, Florida 33442
Phone 954.949.2200 Fax 954.949.2201
engineering@kammconsulting.com
Certification of Authorization #8189
date: 10.21.16
signed: _____

SITE POWER PLAN

DRAWN	JWC/PG/AE
CHECKED	AK/MP
DATE	10-21-16
SCALE	AS NOTED
JOB NO.	2011-64
SHEET	

E1.2

PHASE: C.D. SET 10-21-16