

SECOND FLOOR NOT ACCESSIBLE TO THE PUBLIC

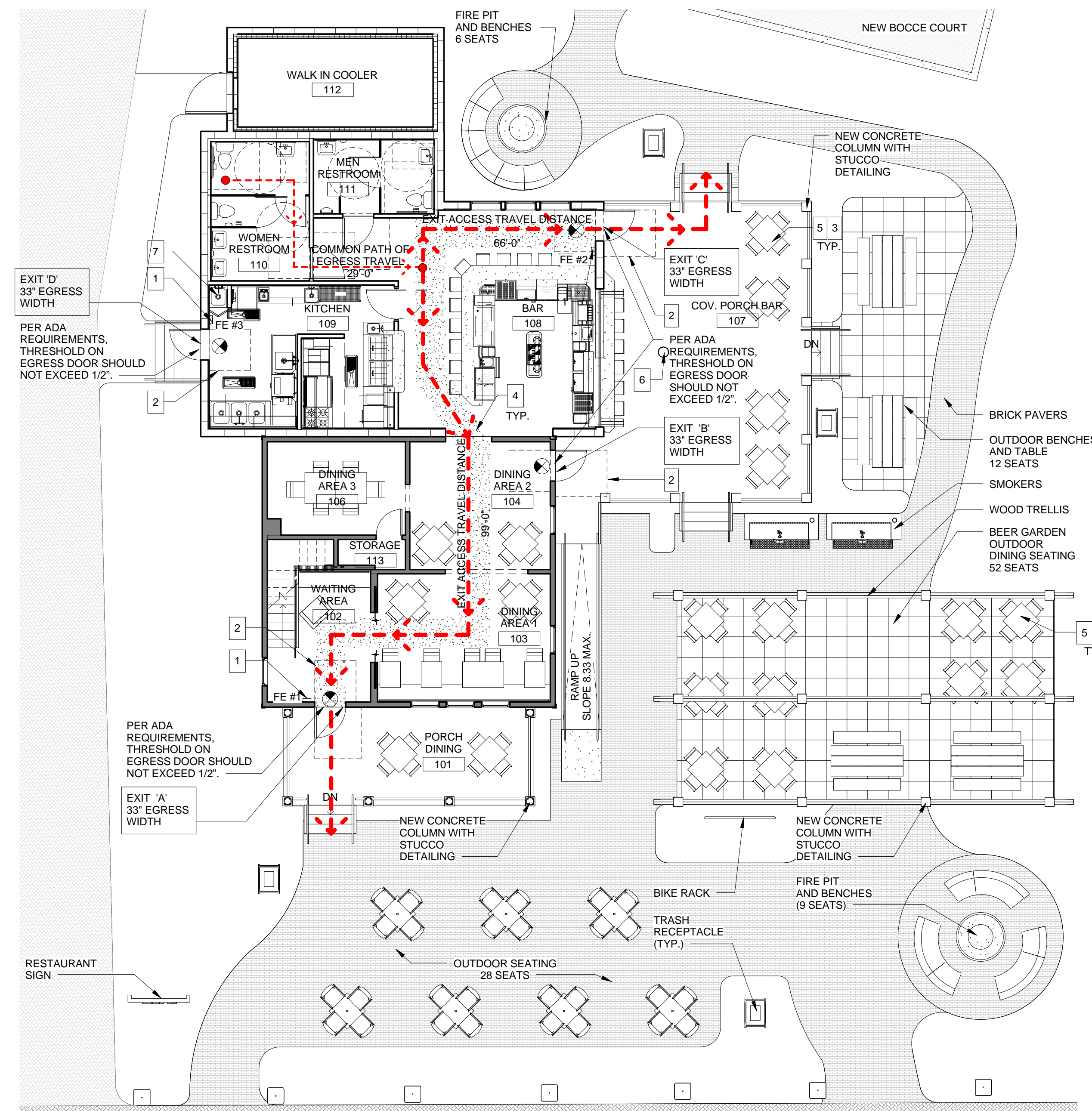

2 2ND FLOOR LIFE SAFETY PLAN  
SCALE: 1/8" = 1'-0"

1 1ST FLOOR LIFE SAFETY PLAN  
SCALE: 1/8" = 1'-0"

LIFE SAFETY PLAN GENERAL NOTES

- OCCUPANCY CLASSIFICATION IS ASSEMBLY 'A2'
- CLASSIFICATION OF HAZARD IS ORDINARY HAZARD IN ACCORDANCE WITH NFPA 6.2.2.3
- IF SPACE IS FITTED WITH A SPRINKLER SYSTEM, SYSTEM IS TO BE FULLY AUTOMATIC SPRINKLER.
- IF SPACE IS FITTED WITH A SPRINKLER SYSTEM, SPRINKLER SYSTEM SHALL BE INSTALLED BY AN APPROVED AUTOMATIC FIRE SPRINKLER CONTRACTOR WHO MUST SUBMIT COMPLETE ENGINEERED SPRINKLER PLANS AND HYDRAULIC CALCULATIONS SIGNED AND SEALED BY A REGISTERED PROFESSIONAL ENGINEER. THE SYSTEM SHALL COMPLY WITH N.F.P.A. SECTIONS 13, 14, 20 AND ALL APPLICABLE SECTIONS OF THE BUILDING CODE.
- IF BUILDING IS FITTED WITH A SPRINKLER SYSTEM, ALL SPRINKLER HEADS IN FINISHED AREAS SHALL BE CHROME PLATED, SEMI RECESSED.
- FURNITURE SHOWN FOR EGRESS INFORMATION ONLY
- ALL FIRE AND/OR SMOKE SEPARATION WALLS MUST BE IDENTIFIED ABOVE DECORATIVE CEILING AND IN CONCEALED SPACES BY STENCILED SIGN READING: "FIRE AND SMOKE BARRIER PROTECT ALL OPENINGS"
- HEADROOM IN ALL MEANS OF EGRESS SHALL BE MINIMUM 7'-6" WITH PROJECTIONS NOT LESS THAN 6'-8"
- ABRUPT CHANGES IN ELEVATION OF WALKING SURFACES SHALL NOT EXCEED 1/4". CHANGES IN ELEVATION BETWEEN 1/4" AND 1/2" SHALL BE LEVELED 1 TO 2
- ANY DOOR IN THE MEANS OF EGRESS SHALL MEET THE REQUIREMENTS UNDER NFPA 101 (SECTION 7.2.1). DOOR LEAVES SHALL BE ARRANGED TO BE OPENED READILY FROM THE EGRESS SIDE WHENEVER THE BUILDING IS OCCUPIED PER NFPA 101 (7.2.1.5.1). LOCKS, IF PROVIDED SHALL NOT REQUIRE THE USE OF A KEY, A TOOL, OR SPECIAL KNOWLEDGE OR EFFORT FOR THE OPERATION FROM THE EGRESS SIDE PER NFPA 101 (7.2.1.5.2).
- EXTERIOR DOOR ASSEMBLIES SHALL BE PERMITTED TO HAVE KEY-OPERATED LOCKS FROM THE EGRESS SIDE, PROVIDED THAT THE FOLLOWING CRITERIA ARE MET PER NFPA 101 (7.2.1.5.1):  
(1) THIS ALTERNATIVE IS PERMITTED IN CHAPTERS 11 THROUGH 43 FOR THE SPECIFIC OCCUPANCY.

- (2) A READILY VISIBLE, DURABLE SIGN IN LETTERS NOT LESS THAN 1 IN. HIGH ON A CONTRASTING BACKGROUND THAT READS AS FOLLOWS IS LOCATED ON OR ADJACENT TO THE DOOR LEAF: "THIS DOOR TO REMAIN UNLOCKED WHEN THE BUILDING IS OCCUPIED."
- (3) THE LOCKING DEVICE IS OF A TYPE THAT IS READILY DISTINGUISHABLE AS LOCKED.
- (4) A KEY IS IMMEDIATELY AVAILABLE TO ANY OCCUPANT INSIDE THE BUILDING WHEN IT IS LOCKED.
- COORDINATE WITH FOR EXACT LOCATION OF FURNITURE AND OUTLETS.
- REFER TO ELECTRICAL ENGINEER'S DRAWINGS FOR EXIT SIGNAGE AND EMERGENCY LIGHTING INFORMATION.
- PER N.F.P.A. 101 CHAPTER 10 AND SECTION 38.3.3
- INTERIOR WALL AND CEILING FINISH MATERIAL SHALL BE CLASS A OR CLASS B IN EXITS AND IN EXIT ACCESS CORRIDORS.
- INTERIOR WALL AND CEILING FINISHES SHALL BE CLASS A, CLASS B, OR CLASS C IN AREAS OTHER THAN EXITS OR EXIT ACCESS CORRIDORS.
- ALL INTERIOR WALL AND CEILING FINISHES SHALL BE CLASSIFIED IN ACCORDANCE WITH ASTM E 84 PER CHAPTER 10 OF NFPA 101. CLASS A SHALL BE CHARACTERIZED BY FLAME SPREAD INDEX OF 0-25 AND SMOKE DEVELOPED INDEX OF 0-450. CLASS B SHALL BE CHARACTERIZED BY FLAME SPREAD INDEX OF 26-75 AND SMOKE DEVELOPED INDEX OF 0-450. CLASS C SHALL BE CHARACTERIZED BY FLAME SPREAD INDEX OF 76-200 AND SMOKE DEVELOPED INDEX OF 0-450
- INTERIOR FLOOR FINISH IN EXIT ENCLOSURES SHALL BE CLASS I OR II. CARPET SHALL COMPLY WITH ASTM D2859. FLOOR COVERINGS OTHER THAN CARPET SHALL HAVE A MINIMUM CRITICAL RADIANT FLUX OF 0.1W/sq. cm.

OCCUPANT LOAD CALCULATIONS

ROOM #	ROOM NAME	FUNCTION OF SPACE	AREA	LOAD FACTOR	OCCUPANT LOAD
108	BAR	18 LINEAR INCHES PER PERSON	324 L. IN	0 SF	18
101	PORCH DINING	ASSEMBLY UNCONCENTRATED	212 SF	15 SF	15
102	WAITING AREA	ASSEMBLY UNCONCENTRATED	103 SF	15 SF	7
103	DINING AREA 1	ASSEMBLY UNCONCENTRATED	208 SF	15 SF	14
104	DINING AREA 2	ASSEMBLY UNCONCENTRATED	169 SF	15 SF	12
106	DINING AREA 3	ASSEMBLY UNCONCENTRATED	119 SF	15 SF	8
107	COV. PORCH BAR	ASSEMBLY UNCONCENTRATED	552 SF	15 SF	37
201	MANAGEMENT OFFICE	BUSINESS	305 SF	100 SF	4
202	LIGHT STORAGE	BUSINESS	117 SF	100 SF	2
203	LIGHT STORAGE	BUSINESS	116 SF	100 SF	2
114	DINING AREA 1	FIXED SEATING	Not Placed	0 SF	5
109	KITCHEN	KITCHEN COMMERCIAL	243 SF	200 SF	3
112	WALK IN COOLER	STORAGE AREA	162 SF	300 SF	1
113	STORAGE	STORAGE AREA	17 SF	300 SF	1
					129

EGRESS REQUIREMENTS

MIN. NUMBER OF EXITS	REQUIRED	PROVIDED
PER FBC 5TH ED. 2014, SECTION 1015.1 FOR ASSEMBLY TYPE 'A2' WITH OCCUPANT LOAD OF 129.	2	4
TOTAL EGRESS WIDTH	REQUIRED	PROVIDED
PER FBC 5TH ED., 2014, TABLE 1016.2 WITHOUT SPRINKLER SYSTEM FOR AN OCCUPANCY TYPE 'A2' (ASSEMBLY)	25'-6"	153"
EXIT ACCESS TRAVEL DISTANCE	MAXIMUM	PROVIDED
PER FBC 5TH ED., 2014, TABLE 1016.2 WITHOUT SPRINKLER SYSTEM FOR AN OCCUPANCY TYPE 'A2' (ASSEMBLY)	200'	99'-0"
MINIMUM CORRIDOR WIDTH	MINIMUM	PROVIDED
PER FBC 5TH ED., 2014, SECTION 1018.2 FOR AN OCCUPANCY TYPE 'A2' (ASSEMBLY)	44"	N/A
MINIMUM CORRIDOR FIRE RATING	MINIMUM	PROVIDED
PER FBC 5TH ED., 2014, TABLE 1018.1 FOR GROUP 'A2' (ASSEMBLY) WITHOUT FIRE SPRINKLER SYSTEM.	N/A	N/A
MAXIMUM COMMON PATH OF EGRESS TRAVEL LENGTH	MAXIMUM	PROVIDED
PER FBC 5TH ED., 2014, SECTION 1014.3 WITHOUT SPRINKLER SYSTEM FOR AN OCCUPANCY TYPE 'A2' (ASSEMBLY)	75'	29'

LIFE SAFETY PLAN LEGEND

- XX' TRAVEL DISTANCE DENOTES PATH OF EGRESS AND TRAVEL DISTANCE
- XX' COMMON PATH DENOTES COMMON PATH OF EGRESS TRAVEL DISTANCE
- FE # WALL MOUNTED FIRE EXTINGUISHER
- EXIT SIGN
- DENOTES EXISTING WALL
- DENOTES PROPOSED WALL

LIFE SAFETY KEY NOTES

- THE CONTRACTOR SHALL PROVIDE AND INSTALL (1) 10 LB. ABC TYPE U.L. LISTED FIRE EXTINGUISHER 1 PER 75'-0" OR 2500 S.F. PROVIDE A CLASS 'K' FIRE EXTINGUISHER AT THE KITCHEN. LOCATION SHALL BE APPROVED BY FIRE MARSHALL PRIOR TO INSTALLATION. FIRE EXTINGUISHERS TO BE WALL MOUNTED.
- CLEAR FLOOR AREA FOR ACCESS OF PERSONS WITH DISABILITIES
- ALL FURNITURE PROVIDED BY OTHERS
- 36" AISLE ACCESS WAY
- PER FBC, 5TH ED., 2014 ACCESSIBILITY, SECTION 226.1. AT LEAST 5% OF THE SEATING SPACES AND STANDING SPACES AT THE DINING SURFACES SHALL COMPLY WITH SECTION 902. IN ADDITION, WHERE WORK SURFACES ARE PROVIDED FOR USE BY OTHER THAN EMPLOYEES, AT LEAST 5% SHALL COMPLY WITH 902 TO WILL BE ADA ACCESSIBLE SEATING CAPACITY IS 212 SEATS, 5% OF 212 = 11 SEATS
- STRUCTURAL COLUMN
- SERVICE SINK



RODOLFO ACEVEDO AIA  
JAMES R. WILLIAMS AIA  
7700 CONGRESS AVE.  
SUITE 1114  
BOCA RATON, FLORIDA 33487  
TEL 561 997 1244  
FAX 561 997 1675  
JAMES R. WILLIAMS - AR0017581  
RODOLFO ACEVEDO - AR0016334

211 E OCEAN AVENUE

BOYNTON BEACH, FL 33435

FLORIDA LICENSEURE:  
AA26002219

PROJECT NO: 15196  
DESIGNED BY: JW  
DRAWN BY: CE/RC/AC/MA  
CHECKED BY: JW/MA/CE

SUBMITTALS:  
PERMIT SET 11.23.2016

REVISIONS:

LIFE SAFETY PLAN

A04