

SECTION 12, TOWNSHIP 46 SOUTH, RANGE 43 EAST

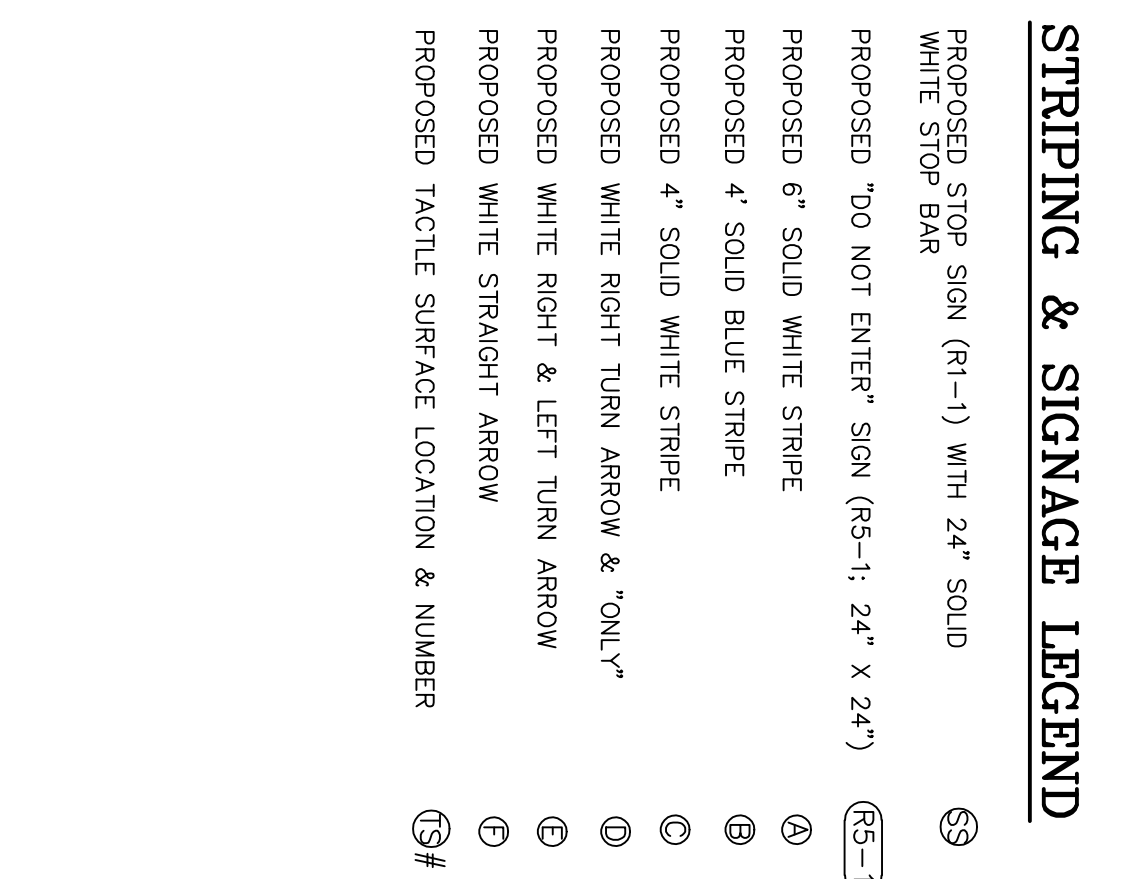

- NOTES:
1. CONTRACTOR TO CONTACT SUNSHINE STATE ONE CALL (811) FOR UTILITY LOCATIONS PRIOR TO COMMENCEMENT OF CONSTRUCTION.
 2. CONSTRUCT CONCRETE SIDEWALK & CURB RAMPS PER FOOT INDEX 304 AND 310.
 3. CONTRACTOR TO REMOVE EXISTING LANDSCAPING VEGETATION (TREES, SHRUBS & GRASS) AS NEEDED TO CONSTRUCT PAVING MODIFICATIONS EXCEPT AS NOTED.
 4. ALL EXISTING UNDERGROUND UTILITIES TO BE LEFT UNDISTURBED.
 5. ALL TYPE "D" CURB TO BE CONSTRUCTED PER FOOT INDEX NO. 300.
 6. REFER TO SHEET 2 THROUGH 4 FOR STORMWATER EROSION CONTROL DETAILS, GENERAL NOTES, CROSS SECTIONS, DRAINAGE DETAILS, PAVING DETAILS AND PAVING SPECIFICATIONS.
 7. REFER TO SHEET 5 FOR APPLICABLE WATER AND SEWER DETAILS.
 8. REFER TO SHEET 7 FOR STRIPING AND SIGNAGE INFORMATION. REFER TO PARKING LOT STRIPING INFORMATION ON SHEET 4 FOR DETAILS.
 9. ELEVATIONS SHOWN HEREON ARE BASED ON THE NATIONAL GEODETIC VERTICAL DATUM OF 1929 (N.G.V.D.).

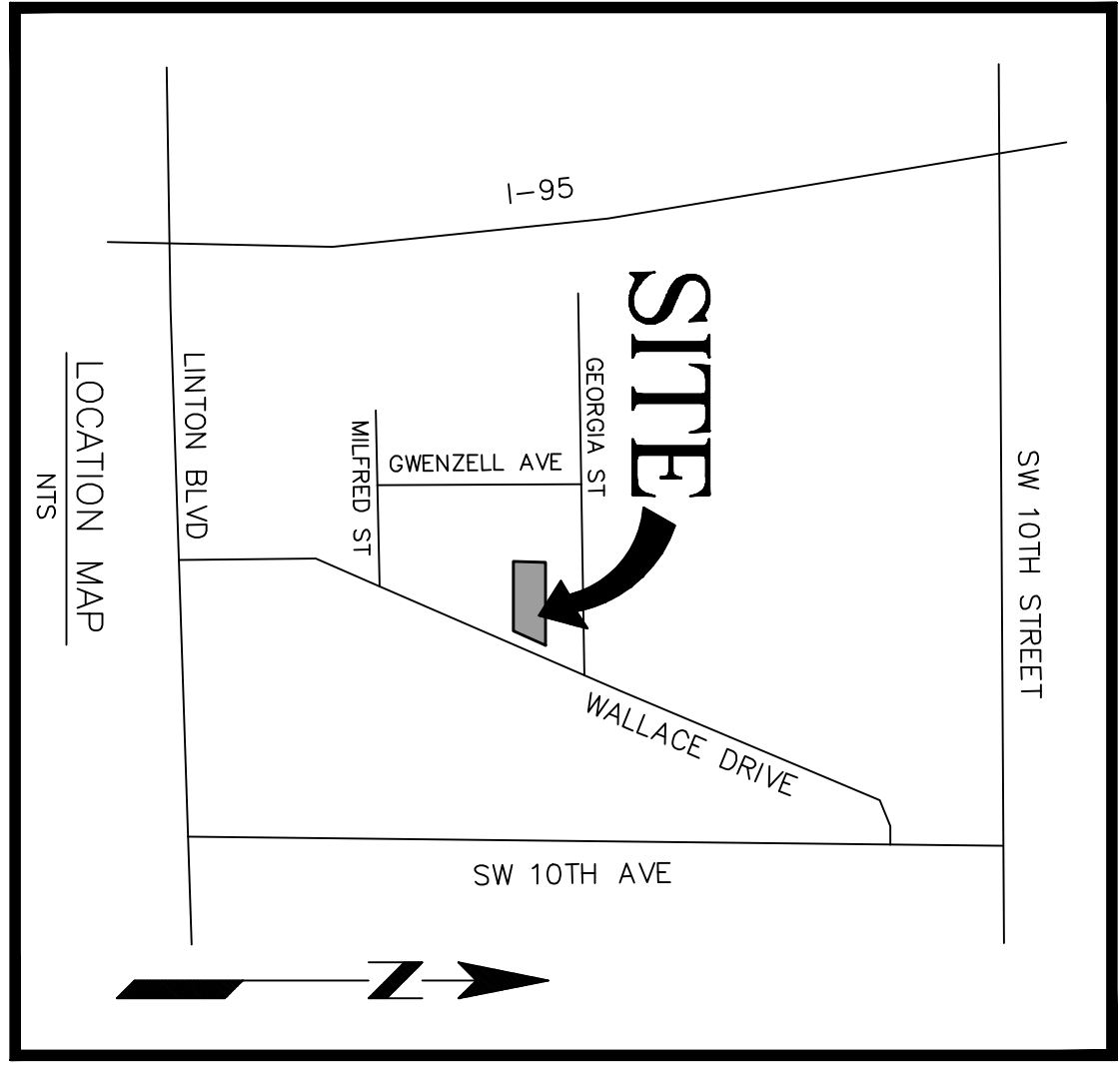
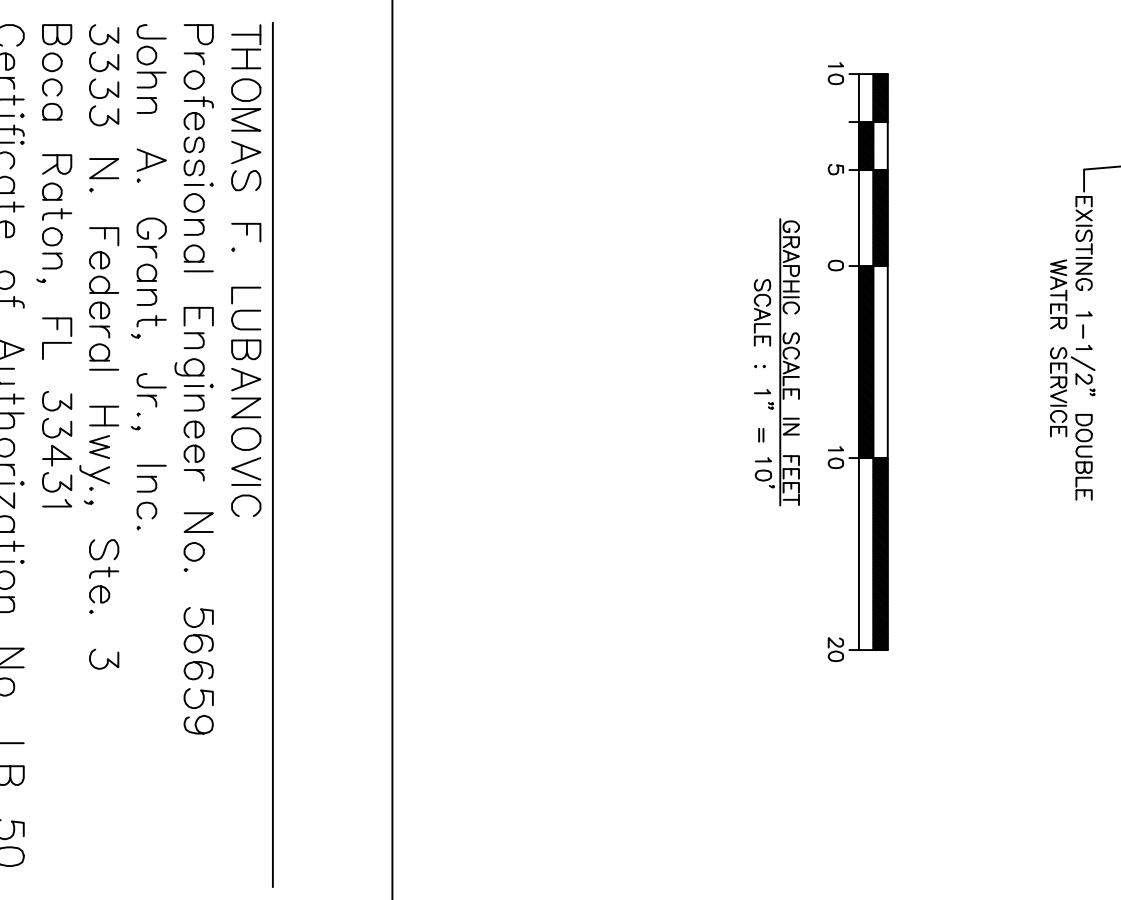
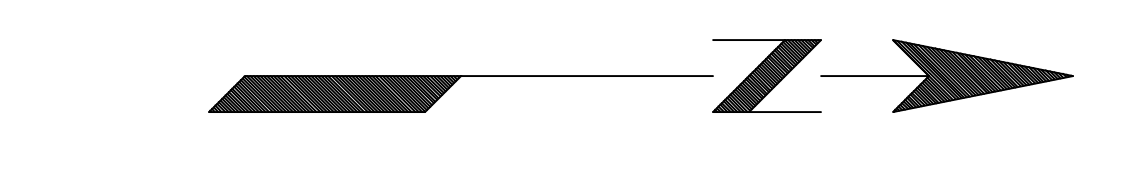

THOMAS F. LUBANOVIC
 Professional Engineer No. 56659
 John A. Grant, Jr., Inc.
 3333 N. Federal Hwy., Ste. 3
 Boca Raton, FL 33431

JOHN A. GRANT, JR., INC.
 CONSULTING ENGINEERS
 3333 NORTH FEDERAL HIGHWAY
 BOCA RATON, FLORIDA 33431
 PH. NO. 561-3951 FAX. NO. 561-395-3315
 LICENSED BUSINESS NO. LB 50

REVISIONS PER REVISED SITE PLAN LAYOUT	CBK	MAR 2016
REVISIONS PER REVISED SITE PLAN LAYOUT	CBK	JAN 2016
REVISIONS PER REVISED SITE PLAN LAYOUT	CBK	AUG 2015
NO. REVISION	BY	DATE

STRIPING & SIGNAGE PLAN

1302 WALLACE DRIVE
DELRAY BEACH, FLORIDA 33444

MADE	DATE	F.B. NO.	SCALE	SHEET	OF
CBK	FEB 2015	7	1" = 10'	7	7

Certificate of Authorization No. LB 50

