

1 LIFE SAFETY AND FURNITURE PLAN
SCALE: 3/32" = 1'-0"

LIFE SAFETY PLAN GENERAL NOTES

- OCCUPANCY CLASSIFICATION IS ASSEMBLY A-2
- CLASSIFICATION OF HAZARD IS ORDINARY ACCORDING TO NFPA 101 - 6.2.2.3
- EXISTING SPACE IS SPRINKLERED.
- FURNITURE SHOWN FOR EGRESS INFORMATION ONLY
- ALL FIRE AND/OR SMOKE SEPARATION WALLS MUST BE IDENTIFIED ABOVE DECORATIVE CEILING AND IN CONCEALED SPACES BY STENCILED SIGN READING: "FIRE AND SMOKE BARRIER PROTECT ALL OPENINGS"
- HEADROOM IN ALL MEANS OF EGRESS SHALL BE MINIMUM 7'-6" WITH PROJECTIONS NOT LESS THAN 6'-8"
- ABRUPT CHANGES IN ELEVATION OF WALKING SURFACES SHALL NOT EXCEED 1/4". CHANGES IN ELEVATION BETWEEN 1/4" AND 1/2" SHALL BE LEVELED 1 TO 2.
- ANY DOOR IN THE MEANS OF EGRESS SHALL MEET THE REQUIREMENTS UNDER NFPA 101 (SECTION 7.2.1). DOOR SHALL BE ARRANGED TO BE OPENED READILY FROM THE EGRESS SIDE WHENEVER THE BUILDING IS OCCUPIED. LOCKS, IF PROVIDED SHALL NOT REQUIRE THE USE OF A KEY, A TOOL OR SPECIAL KNOWLEDGE OR EFFORT FOR THE OPERATION FROM THE EGRESS SIDE PER NFPA 101 (7.2.1.5.1). EXISTING EXIT STAIR DOORS WILL REMAIN EQUIPPED WITH PANIC EXIT HARDWARE OR FIRE EXIT HARDWARE PER (7.2.1.7.1 AND 12.2.2.2.3).
- MAIN ENTRY DOOR IS PERMITTED TO HAVE A KEVED LOCK FROM THE EGRESS SIDE PER NFPA 101 (7.2.1.5.1, EXCEPTION 2) AND HAVE A SIGN POSTED ADJACENT TO THE DOOR IN 1 INCH LETTERS ON A CONTRASTING BACKGROUND "THIS DOOR TO REMAIN UNLOCKED WHEN THE BUILDING IS OCCUPIED."
- MEANS OF EGRESS SHALL NOT BE PERMITTED THROUGH KITCHENS, STOREROOMS, RESTROOMS, CLOSETS, OR HAZARDOUS AREAS NFPA 101 (12.2.5.2).
- COORDINATE WITH OWNER FOR EXACT LOCATION OF FURNITURE AND OUTLETS.
- REFER TO ELECTRICAL ENGINEER'S DRAWINGS FOR EXIT SIGNAGE AND EMERGENCY LIGHTING INFORMATION.

LIFE SAFETY KEY NOTES

- THE CONTRACTOR SHALL PROVIDE AND INSTALL (1) 10 LB. ABC TYPE U.L. LISTED FIRE EXTINGUISHER 1 PER 75'-0" OR 2500 S.F. LOCATION SHALL BE APPROVED BY FIRE MARSHALL PRIOR TO INSTALLATION.
- CLEAR FLOOR AREA FOR ACCESS OF PERSONS WITH DISABILITIES

EGRESS REQUIREMENTS

MIN. NUMBER OF EXITS PER FL BLDG. CODE SECTION 1015.1.1	REQUIRED	PROVIDED
3	3	12
MAIN ASSEMBLY OCCUPANCY EXIT WIDTH SUFFICIENT TO EXIT 50% OF OCCUP. PER SEC. 1028.2 901 OCCUPANT/2 = 450. 453X0.2 = 90" REQ'D WIDTH	MINIMUM	PROVIDED
90"	90"	138"
TOTAL EGRESS WIDTH PER BLDG. CODE SECTION 1005.3.2 IS .2" PER OCCUP. 901 OCCUP. X 2"/OCCUPANT = 180" REQ'D WIDTH	REQUIRED	PROVIDED
180"	180"	696"
EXIT ACCESS TRAVEL DISTANCE TABLE 1016.2 FOR SPRINKLERED A OCCUPANCY	MAXIMUM	PROVIDED
250'	250'	173'-0"
MINIMUM CORRIDOR WIDTH PER SECTION 1014.3, TABLE 1018.2	MINIMUM	PROVIDED
44"	44"	95"
MINIMUM CORRIDOR FIRE RATING PER TABLE 1018.1 FOR SPRINKLERED A OCCUPANCY	MINIMUM	PROVIDED
0 HOURS	0 HOURS	0 HOURS
MAXIMUM COMMON PATH OF EGRESS TRAVEL LENGTH PER SECTION 1014.3, EXCEPTION 1.	MAXIMUM	PROVIDED
75'-0"	75'-0"	47'-0"
MAXIMUM COMMON PATH OF EGRESS TRAVEL LENGTH IN AN ASSEMBLY ROOM. FOR A ROOM OR SPACE USE FOR ASSEMBLY PURPOSES HAVING FIXED SEATING SECTION 1028.8	MAXIMUM	PROVIDED
30'-0"	30'-0"	28'-0"
MAXIMUM DEAD END CORRIDOR PER SECTION 1018.3 (WHERE MORE THAN ONE EXIT OR EXIT ACCESS DOOR IS REQUIRED)	MAXIMUM	PROVIDED
20'	20'	N/A

OCCUPANT LOAD CALCULATIONS

Room	Name	Occupant	Area	Load Factor	Occ. Load	Net Occupant Load
233	ELECTRICAL	Storage/Mech Rm	96 SF	300 SF	0.319	1
206	STO.	Storage/Mech Rm	33 SF	300 SF	0.110	1
231	STORAGE	Storage/Mech Rm	137 SF	300 SF	0.456	1
300 SF: 3			266 SF		0.885	3
224	COOLER	Kitchen	117 SF	200 SF	0.585	1
223	KITCHEN	Kitchen	1743 SF	200 SF	8.714	9
200 SF: 2			1860 SF		9.299	10
219	CONCIERGE	Business/Office	127 SF	100 SF	1.272	1
203	OFFICE	Business/Office	157 SF	100 SF	1.569	2
208	OFFICE	Business/Office	131 SF	100 SF	1.308	1
211	OFFICE	Business/Office	108 SF	100 SF	1.077	1
225	OFFICE	Business/Office	78 SF	100 SF	0.775	1
228	OFFICE	Business/Office	92 SF	100 SF	0.915	1
210	OFFICE	Business/Office	215 SF	100 SF	2.145	2
216	SERVER	Business/Office	199 SF	100 SF	1.987	2
221	SERVER	Business/Office	86 SF	100 SF	0.859	1
207	WORK ROOM	Business/Office	638 SF	100 SF	6.379	6
100 SF: 10			1789 SF		17.885	18
Assembly (Tables and Chairs)						
209	BELLE GROVE	Assembly (Tables and Chairs)	742 SF	15 SF	49.485	49
250	CARD ROOM	Assembly (Tables and Chairs)	1845 SF	15 SF	123.012	123
227	GRILL ROOM	Assembly (Tables and Chairs)	2108 SF	15 SF	140.537	141
200	MAIN DINING ROOM	Assembly (Tables and Chairs)	2949 SF	15 SF	196.605	197
214	PRIVATE FUNCTION	Assembly (Tables and Chairs)	1172 SF	15 SF	78.147	78
215	WEST WING	Assembly (Tables and Chairs)	1161 SF	15 SF	77.387	77
229	WINE BAR	Assembly (Tables and Chairs)	1881 SF	15 SF	125.417	125
213	WOMEN'S CARD RM.	Assembly (Tables and Chairs)	1200 SF	15 SF	79.978	80
15 SF: 8			13059 SF		870.568	870
Grand total: 23			16972 SF		998.637	901

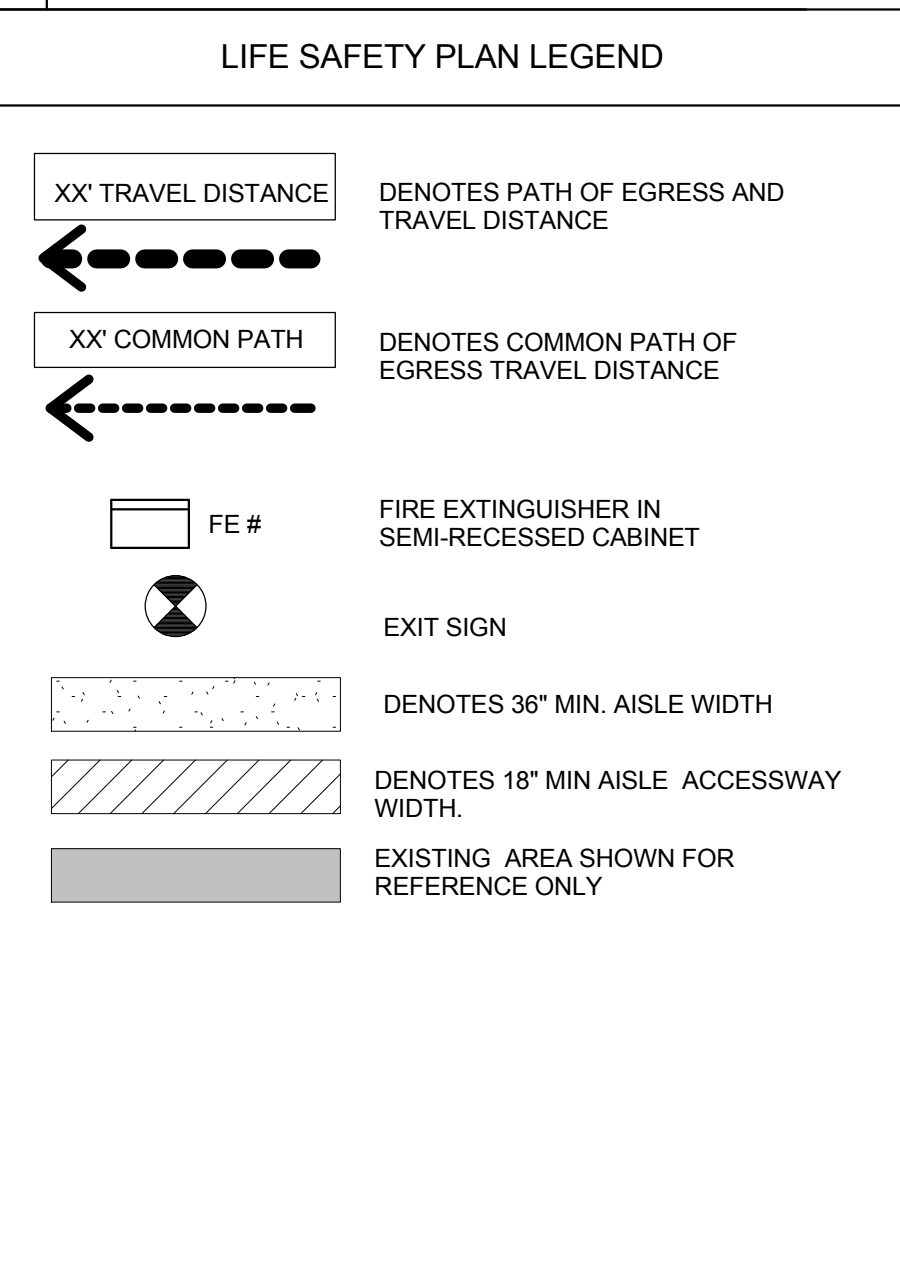

REVISIONS:

Life Safety Plan