

NOTE:

1. 20" HIGH FLOOD BARRIER PANEL SYSTEM TO BE PROVIDED AT ALL DOOR OPENINGS. GENERAL CONTRACTOR SHALL SUBMIT SHOP DRAWINGS WITH ARCHITECT'S OF RECORD APPROVED STAMP TO THE BUILDING DEPARTMENT FOR APPROVAL PRIOR TO INSTALLATION.
2. ALL PERIMETER EXTERIOR WALLS SHALL BE 20" HIGH FLOOD PROOF FROM FINISH FLOOR WITH DRYLOK OIL BASE MASONRY WATERPROOFER OR APPROVED EQUAL. GENERAL CONTRACTOR SHALL SUBMIT PRODUCT DATA SHEET WITH ARCHITECT'S OF RECORD APPROVED STAMP TO THE BUILDING DEPARTMENT FOR APPROVAL PRIOR TO INSTALLATION.

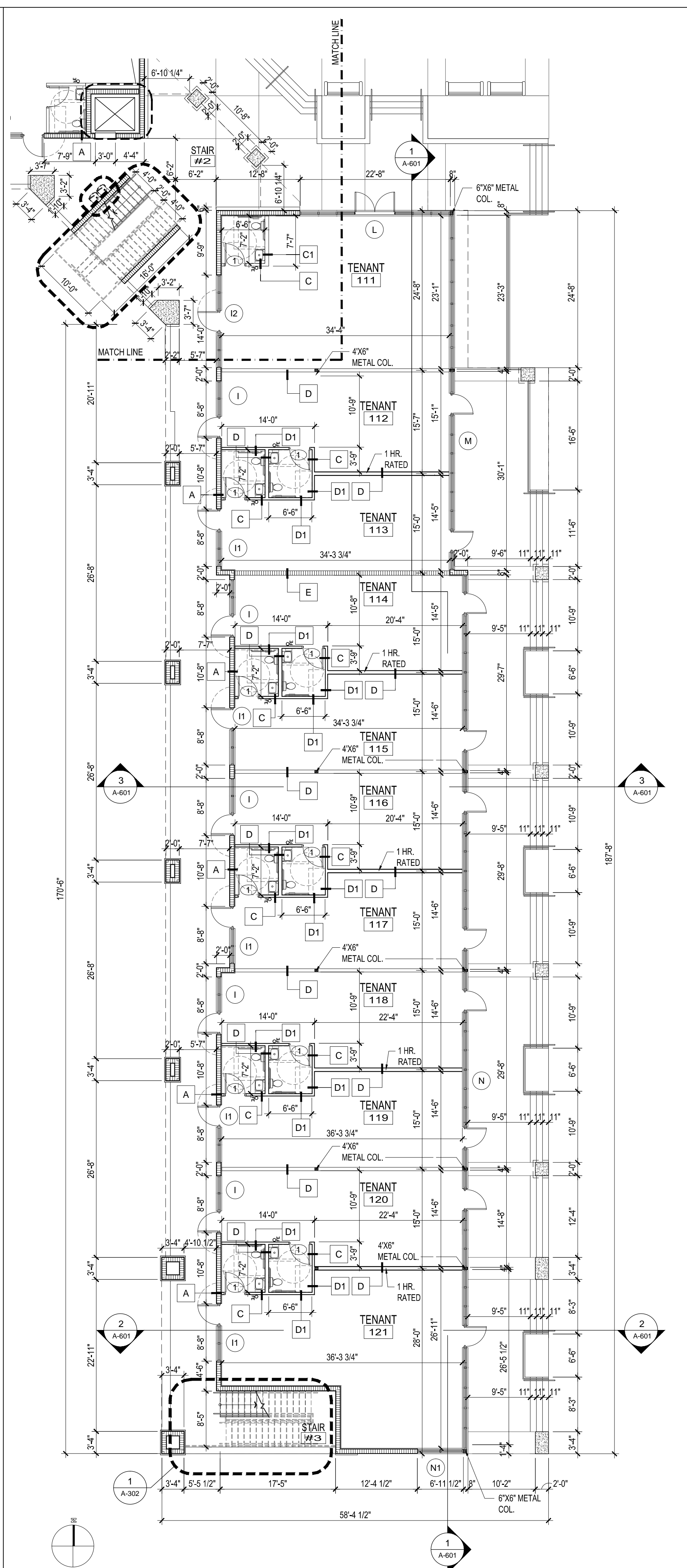

1800 Eller Drive, Suite 500
 Fort Lauderdale, FL 33316
 T 954.961.6806
 F 954.961.6807
 www.synalovskid.com

Manuel Synalovski, AIA
 AR 0011628
 SEAL

LICENSE NO. AA26001863

VILLAGE AT ATLANTIC SHORES
 801 N. FEDERAL HIGHWAY
 HALLANDALE BEACH, FL
 CLIENT: ATLANTIC VILLAGE 1, LLC.

REV	DATE	DESCRIPTION

DESIGN DELIVERABLE: PERMIT SET
 ISSUE DATE: 05-11-16

PROJECT NUMBER: 1177 - 150203
 DRAWN BY: JS
 CHECKED BY: MS

Copyright (c) by SYNALOVSKI ROMANIK SAYE, LLC
 All Rights Reserved.

SHEET TITLE:
FIRST FLOOR PLAN

SHEET NUMBER:
A-101

2 PARTIAL FIRST FLOOR PLAN
 SCALE: 3/32"=1'-0"

1 PARTIAL FIRST FLOOR PLAN
 SCALE: 3/32"=1'-0"

E:\1177-150203 Atlantic Shores Village\Drawings\A-101 FLOOR PLAN.dwg 5/11/2016 4:50:43 PM