

REVISIONS

1	
2	
3	
4	
5	
6	
7	
8	
9	
10	

INDICATED REVISIONS, ADDITIONS AND DELETIONS TO THESE PLANS SHALL BE MADE IN ACCORDANCE WITH THE STANDARD PRACTICES OF THE ARCHITECTURAL PROFESSION. THE ARCHITECT SHALL BE RESPONSIBLE FOR THE ACCURACY OF THE REVISIONS. THE CONTRACTOR SHALL BE RESPONSIBLE FOR THE ACCURACY OF THE CONSTRUCTION. THE ENGINEER SHALL BE RESPONSIBLE FOR THE ACCURACY OF THE ENGINEERING. THE ENGINEER'S LICENSE NO. 593999 IS HEREBY REPRODUCED FOR YOUR INFORMATION.

LIFE FELLOWSHIP
11401 WEST SAMPLE ROAD
CORAL SPRINGS, FL. 33065

1600 SOUTH DIXIE HWY., SUITE 400
BOCA RATON, FLORIDA 33432
PHONE 561-391-0081 FAX 561-391-0085
EMAIL mail@rwb-arch.com



PROJECT # 10024
DATE 05/20/16
SHEET #

SL2.1

JUAN C. LINARES

A. A28000640

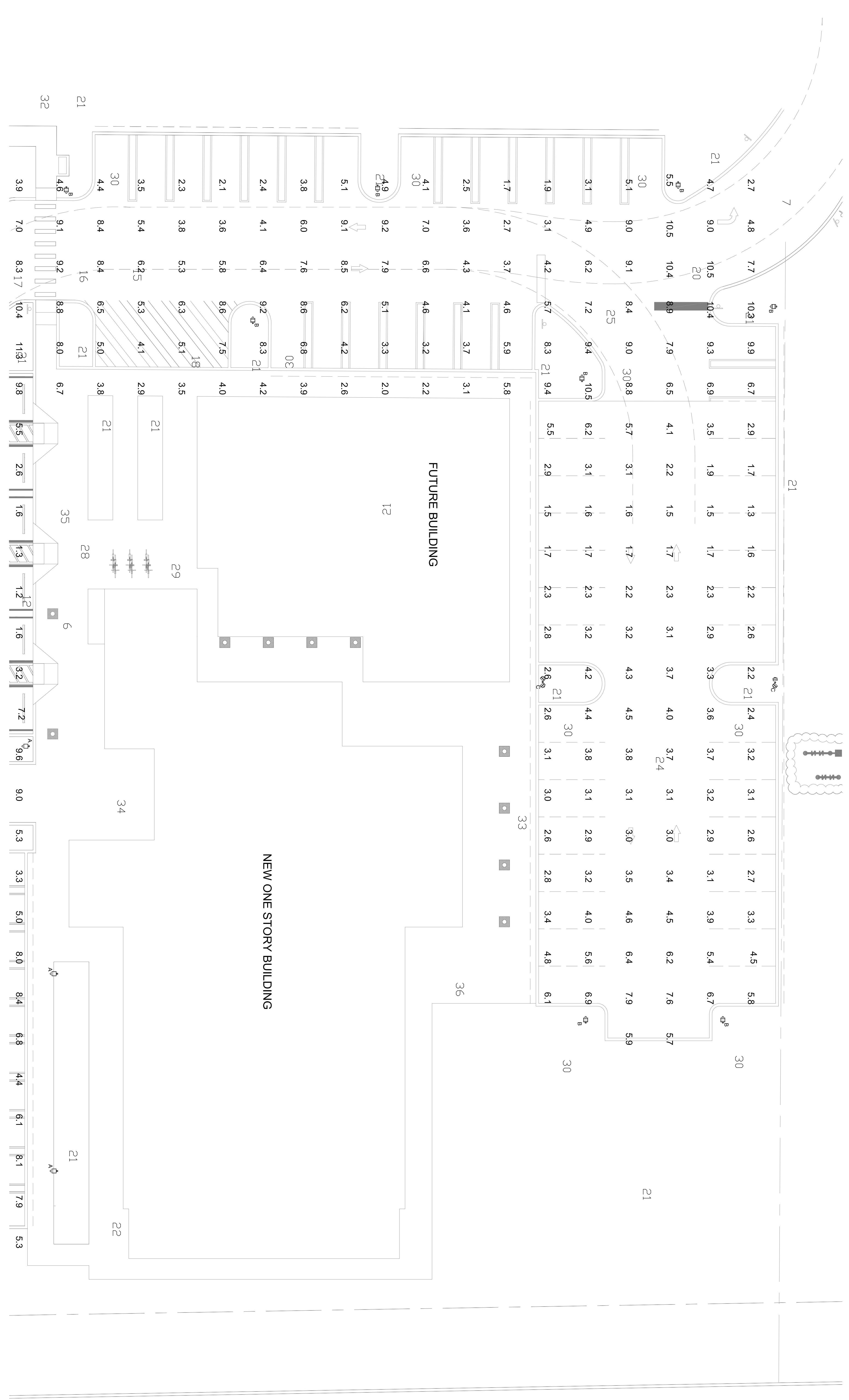

STATISTICS

Description	Symbol	Avg	Max	Min	Max/Min	Avg/Min
Property Line	+	-1.0 fc	0.0 fc	0.0 fc	N/A	N/A
Calc Zone #4	+	5.5 fc	13.6 fc	1.2 fc	11.3:1	4.6:1
Property Line	+	0.0 fc	0.0 fc	0.0 fc	N/A	N/A

SITE LIGHTING PHOTOMETRIC PLAN

SCALE: 3/32" = 1'-0"



PROGRESS OR CHECK SETS, BY THEIR NATURE, MAY BE INCOMPLETE AND ARE NOT TO BE USED FOR BIDDING OR CONSTRUCTION. CONTRACTOR RECOGNIZES HIS SOLE RESPONSIBILITY TO INCLUDE ALL CONTINGENCIES FOR THESE PLANS ARE NOT FINAL UNTIL PERMIT SETS ARE ISSUED.

PRIOR TO SUBMITTING THE BID, THE CONTRACTOR SHALL FIELD VERIFY ALL EXISTING CONDITIONS AND INFORM THE ARCHITECT AND SHALL INCLUDE IN THE BID TO CORRECT THE SAME AS DIRECTED. THE ENGINEER AND THE ARCHITECT, ARE NOT RESPONSIBLE FOR ANY ADDITIONAL COSTS RESULTING FROM VERIFYABLE EXISTING CONDITIONS DISCOVERED AFTER CONTRACT HAS BEEN AWARDED.

RECORD: ALL CHANGES SHALL BE SUBMITTED FOR REVIEW PRIOR TO INSTALLATION. NOT FOR BID UNTIL PERMIT HAS BEEN ISSUED.

CA. LIC. No. 31328

Associated Professional Design Consulting Engineers

500 NE SPANHAMMER BLVD, SUITE 205, BOCA RATON, FLORIDA 33431
PHONE: 561-498-9777, INFO@PPD-ENGINEERING.COM
MARTIN WHITE, OCE. P.E. FLORIDA LICENSE No. 593999