

SCOPE OF WORK -AND- OUTLINE SPECIFICATIONS:

01.0 GENERAL REQUIREMENTS:

THE FOLLOWING SCOPE OF WORK AND GUIDE SPECIFICATIONS ARE INTENDED FOR GENERAL INFORMATION AND TO SUPPLEMENT THE REQUIREMENTS SHOWN ON THE DRAWINGS. THESE SPECS ARE NOT A FULL COMPREHENSIVE CONSTRUCTION SPEC AND SHOULD NOT BE USED AS SUCH. THE GENERAL CONTRACTOR IS REQUIRED TO PROVIDE ALL MATERIALS AND LABOR REQUIRED TO ACHIEVE THE INTENT OF THESE SPECIFICATIONS AND DRAWINGS (AND INCLUDE SUCH IN HIS INITIAL BID TO THE CLIENT)

1. SITE VISIT: PRIOR TO BIDDING OR SUBMITTING ANY PROPOSAL, THE GENERAL CONTRACTOR AND EACH SUBCONTRACTOR SHALL VISIT THE JOB SITE AND VERIFY THE CONDITIONS UNDER WHICH THIS WORK WILL BE PERFORMED. UPON SUBMITTING A BID, IT WILL BE ASSUMED THAT THE CONTRACTOR HAS INVESTIGATED AND IS FULLY INFORMED AS TO THE CONDITIONS TO BE ENCOUNTERED.
2. THE SUCCESSFUL BIDDING CONTRACTOR SHALL SUBMIT THE BUILDING PERMIT APPLICATION, PLANS AND SPECIFICATIONS, NOTICE OF ACCEPTANCES, SUPPORTING SUBCONTRACTOR APPLICATIONS, AND ALL RELATED DOCUMENTATION TO THE COUNTY OF PALM BEACH FOR THE BUILDING PERMITTING AS THE 'QUALIFIER'.
3. THE CONTRACTOR SHALL ASSIST THE OWNER IN THE PREPARATION AND FILING OF A NOTICE OF COMMENCEMENT.
4. THE CONTRACTOR'S "REQUESTS FOR PAYMENT" SHALL INCLUDE RELEASES OF LIEN FROM ALL MATERIAL SUPPLIERS AND SUBCONTRACTORS FOR SUPPLIES AND WORK RELATING TO THE REQUEST FOR PAYMENT.
5. TEMPORARY POWER & WATER ARE AVAILABLE ON-SITE
6. THE GENERAL CONTRACTOR SHALL PROVIDE A TEMPORARY TOILET AND POTABLE DRINKING WATER ON-SITE FOR ALL CONSTRUCTION TRADESMAN (AT NO-TIME DURING CONSTRUCTION SHALL THE EXISTING FACILITIES BE USED BY CONSTRUCTION WORKERS)
7. WORKER'S COMPENSATION: STATE: STATUTORY, EMPLOYER'S LIABILITY: STATUTORY.
8. SAFETY AND OSHA COMPLIANCE IS THE RESPONSIBILITY OF THE GC
9. ALL WORK SHALL BE PERFORMED IN A FIRST CLASS WORKMAN LIKE MANNER IN ACCORDANCE WITH THESE PLANS AND SPECIFICATIONS, THE FLORIDA BUILDING CODE, THE STATE ENERGY EFFICIENCY CODE, INDUSTRY STANDARDS, AND ALL APPLICABLE NATIONAL, STATE, AND LOCAL CODES, ORDINANCES AND RULES.

02.1 SITE WORK SCOPE:

THE PRIMARY SCOPE OF WORK IS INTERIOR - AS A REQUIREMENT FOR OCCUPANCY - THE PROPERTY OWNER MUST COMPLETE WORK FOR PARKING LOT LIGHTING AND ADD A BIKE RACK. (PLEASE COORDINATE FINAL OCCUPANCY WITH THE PROPERTY OWNER'S REQUIRED WORK)

02.3 INTERIOR DEMOLITION: SEE AS-BUILT & DEMO PLAN FOR NOTES

03.0 CONCRETE:

LIMITED TO THE RAISING OF THE FLOOR AND PLUMBING LINE CUTTING INDICATED ON THE DRAWINGS

1. CONCRETE SHALL BE 3,000 PSI STANDARD MIX CONCRETE WITH 6x6 - 10/10 WELDED WIRE FABRIC REINFORCING. - PROVIDE EXPANSION MATERIAL WHERE SLAB MEETS NEW MASONRY WALLS.
2. DOWEL ALL SLABS TO EXISTING ADJACENT CONCRETE WITH 1/2" LONG #4 BARS, DRILL & EMBED 3" INTO EXISTING (TO PREVENT SETTLEMENT) TYPICAL
3. DEFORMED STEEL BARS OF SIZES SHOWN ON THE STRUCTURAL DRAWINGS FOR ALL COLUMNS, BEAMS, AND REINFORCING.
4. FOUR-BACK FOR SLAB CUT(S) SHALL HAVE #4 DOWELS X 1/2" LONG AT 24" O.C. 3" IMBED INTO EXISTING SLAB, ON BOTH SIDES OF TRENCH.
5. BROOM FINISH EXTERIOR SLABS, TROWEL FINISH INTERIOR SLABS TO MATCH EXISTING ADJACENT WORK.
6. WHERE REQUIRED, TREAT THE GROUND WORK BELOW SLABS WITH TERMITTE TREATMENT AND RETAIN THE CERTIFICATE WITH THE PLANS.

04.0 MASONRY: (NO MASONRY IN SCOPE OF WORK)

05.0 METALS (NO-STRUCTURAL METALS REQUIRED)

06.0 WOOD & PLASTIC

06.4 WOOD & PLASTIC LAMINATE CASE WORK
ALL CABINETRY SHOWN ON THE PLANS SHALL BE CUSTOM BUILT COMMERCIAL GRADE, PLASTIC LAMINATE CASEWORK. CASEWORK OR OPEN SHELVING SHALL BE LOCATED IN LAB #06

1. CABINETS SHALL BE FLUSH OVERLAY STYLE, CONSTRUCTED IN ACCORDANCE WITH AWI GUIDELINES.
2. MATERIAL SHALL BE 3/4" LOW PRESSURE MELAMINE OVERLAY WITH 3MM PVC OR ABS EDGING.
3. DRAWER GUIDES - FULL EXTENSION AWI APPROVED
4. HINGES - CONCEALED EUROPEAN STYLE, 120 DEGREE, GRADE II
5. ADJUSTABLE SHELF SUPPORTS
6. PULLS - WIRE STYLE (2-SCREW)

SUBMIT A (1) MOCK CABINET: INCLUDING DRAWER, HINGED DOOR, ADJUSTABLE SHELF & PULLS WITH PROPOSED COMPONENTS. SUBMIT COLOR SAMPLES FOR OWNER & ARCHITECT SELECTION.

06.5 QUARTZ COUNTER TOPS

LABORATORY COUNTER TOP SHALL BE QUARTZ SELECTED BY THE OWNER.

06.6 FOLD-DOWN EXAM-TABLES

OWNER SHALL PROVIDE (3) FOLD-DOWN EXAM TABLES (MODEL # 101-2640-00 BY V551). G.C. SHALL PROVIDE BLOCKING IN THE PARTITIONS AS REQUIRED FOR MOUNTING, AND MOUNT THE OWNER SUPPLIED TABLES.

07.0 THERMAL & MOISTURE PROTECTION (NOT REQUIRED)

08.0 OPENINGS:

08.1 INTERIOR DOORS:

PROVIDE NEW SOLID CORE, PREFINISHED (STAIN-GRADE) BIRCH DOORS & C-TYPE HOLLOW METAL FRAMES FOR ALL INTERIOR DOORS. (SEE SCHEDULE) INSTALL 1/4" TEMPERED PLATE GLASS WHERE INDICATED

1. RECOMMENDED SOLID CORE SHALL BE: AGRIFIBER (GREEN MATERIAL). ALTERNATE - STANDARD PARTICLE CORE.
2. FACE VENEER - STAIN GRADE BIRCH (SUBMIT COLOR CHART AND DOOR SUBMITTAL TO ARCHITECT AND OWNER FOR SELECTIONS)
3. INSTALL DOORS WITH SKILLED, QUALIFIED, EXPERIENCED CRAFTSMAN, TRUE, LEVEL, SQUARE, WITH ALL HARDWARE AS SCHEDULED AND SPECIFIED.

1. DOOR HARDWARE TO BE BRUSHED NICKEL FINISH, SCHLAGE COMMERCIAL SERIES. ADA (APPROVED) LEVER SET(S), 1 1/2 PAIR HINGES, & 10" HIGH BRUSHED NICKEL KICK PLATE ON BOTH TOILET DOORS. (FOLLOW HARDWARE SCHEDULE ON THE DRAWINGS) NOTE: USE SCHLAGE KEY-PAD EXTERIOR LOCK AD-200 ELECTRONIC OR EQUAL.

08.3 INTERIOR GLASS PARTITIONS AND DOORS:

WHERE INDICATED ON DRAWINGS, PROVIDE ALUR-GLASS PARTITION SYSTEM(S):

EXAM ROOM #12 - SHALL BE FULL-HEIGHT SYSTEM (FLOOR TO CEILING) GLASS PARTITION WITH INNOVATIVE GLASS - PRIVACY GLASS (5 LG) 777-1100. 9/16" 1/4-TEMP 1/4" TEMP & CONTROLS AS SPECIFIED BY SUPPLIER.

SURGERY #05 - SHALL BE FULL-HEIGHT SYSTEM (FLOOR TO CEILING) AND - OPENING IN-FILL (SEE DRAWINGS) - GLASS PARTITION AND DOOR SHALL BE FRAMELESS GLASS & DOOR USE 7/16" TEMP GLASS AS PROVIDED BY ALUR.

09.0 FINISHES:

09.1 METAL STUD AND GYPSUM WALL BOARD:

1. INTERIOR METAL STUDS TO BE 3 5/8" 25GA STANDARD INTERIOR STUDS ASSEMBLED WITH TOP & BOTTOM CHANNELS, HORIZONTAL CHANNEL BRIDGING @ 60" AFF. W FASTENERS BY SAME MANUFACTURER.
2. ALL GIBS SHALL BE 5/8" STANDARD THICKNESS IN 12' LENGTHS AND INSTALLED IN ACCORDANCE WITH INDUSTRY-STANDARDS TO BE FINISHED LEVEL-4 READY FOR PAINT.
3. WOOD BLOCKING AT ALL DOOR FRAMES
4. STUD WORK SUBCONTRACTOR SHALL BE RESPONSIBLE TO ADD MISCELLANEOUS WOOD BLOCKING (2X OR 3/4" PLYWOOD) AT ALL LOCATIONS REQUIRING ADDITIONAL SUPPORT. AT A MINIMUM NOTE ALL OF THE FOLLOWING ON THE PLANS:
A CABINET WORK, AND COUNTER TOPS
B TOILET ROOM ACCESSORIES
D LAMINATED DESK TOPS
E DRINKING FOUNTAINS
F LAVATORIES & VANITIES
G SHELVING
H TV (MONITOR) MOUNTS
I OTHER AS DIRECTED BY THE OWNER AND/OR G.C.

09.2 PAINTING:

- ALL PAINT LISTED IN SPECIFICATIONS IS COMMERCIAL GRADE SHERWIN-WILLIAMS (NO SUBSTITUTIONS PERMITTED)
- 1.A. INTERIOR WALLS (GYPSUM - IN ALL TOILET ROOMS)
PRIMER -Multi-Purpose Latex Primer (B51W450)
PAINT - Pro-Mar 200 0 VOC Semi-Gloss Latex Enamel
 - 1.B. INTERIOR WALLS (TYPICAL FLAT PAINTED GYPSUM BOARD)
PRIMER -Multi-Purpose Latex Primer (B51W450)
PAINT - Pro-Mar 200 0 VOC Latex Flat
 - 1.C. INTERIOR STAINED WOOD (WHERE NOTED)
PRIMER -Multi-Purpose Latex Primer (B51W450)
PAINT -Pro-Mar 200 0 VOC Semi-Gloss Latex Enamel
 - 1.D. INTERIOR METAL FRAMES (PRIMED STEEL)
PRIMER -Pro-Cryl Universal Metal Primer (BGGW310)
PAINT - Pro-Mar 200 0 VOC Semi-Gloss Latex Enamel
 - 1.E. CEILING (PAINTED GYPSUM (TOILET ROOMS)
PRIMER -Multi-Purpose Latex Primer (B51W450)
PAINT -Pro-Mar 200 0 VOC Latex Flat

09.3 FLOOR TILE:

ALL ROOMS SHALL HAVE A PORCELAIN TILE FLOOR FINISH, TILE SHALL BE LONG-PLANK FLOOR TILE SELECTED BY THE OWNER.

1. TILE WORK SHALL BE COMPLETED BY AN EXPERIENCED APPROVED TILE INSTALLATION CONTRACTOR. ALL WORK SHALL BE THIN-SET, GROUTED AND SEALED ACCORDING TO THE MANUFACTURERS STANDARDS FOR INSTALLATION OVER CONCRETE.

09.7 NEW PAINTED WOOD BASE (TYPICAL THROUGH-OUT) SELECTED BY OWNER.

10.0 SPECIALTIES:

- 10.1 TOILET ACCESSORIES SHALL INCLUDE THE FOLLOWING: TOILET TISSUE DISPENSER, PAPER-TOWEL DISPENSER / WAIST COMBINATION UNIT, SOAP DISPENSER, SPECIMEN PASS-THROUGH AND MIRROR. MOUNT ALL ACCESSORIES IN ACCORDANCE WITH ADA-ACCESS GUIDELINES. PRODUCTS SHALL BE BOBRICK OR APPROVED EQUAL.

- 10.2 SIGNAGE - ADA WOMEN'S, ADA MEN'S, AND ADA UNISEX SIGNAGE SHALL BE INSTALLED IN REQUIRED LOCATIONS AT ALL PROPOSED TOILET ROOMS.

11.0 EQUIPMENT: (NO EQUIPMENT IN THIS SCOPE)

12.0 FURNISHINGS: (ARE NOT PART OF THIS SCOPE)

13.0 SPECIAL CONSTRUCTION:

14.0 CONVEYING SYSTEMS: (NOT REQUIRED)

15.0 PLUMBING: (SEE PLUMBING DRAWINGS FOR SCOPE, SPECIFICATIONS, NOTES AND DETAILS)

16.0 ELECTRICAL: (SEE ELECTRICAL DRAWINGS FOR SCOPE, SPECIFICATIONS, NOTES AND DETAILS)

END-OF-SCOPE AND SPECIFICATIONS

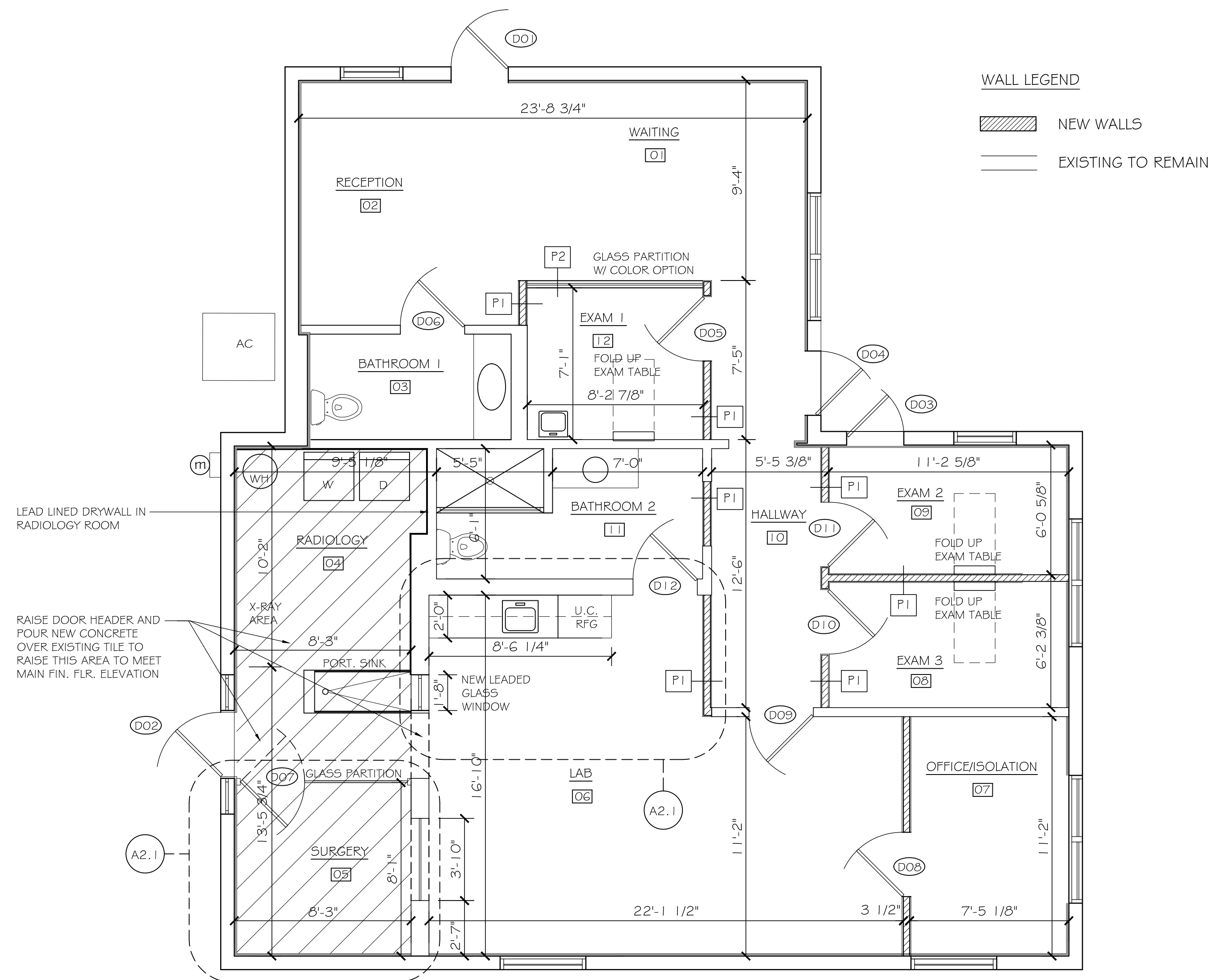

FLOOR PLAN
1/4" = 1'-0"

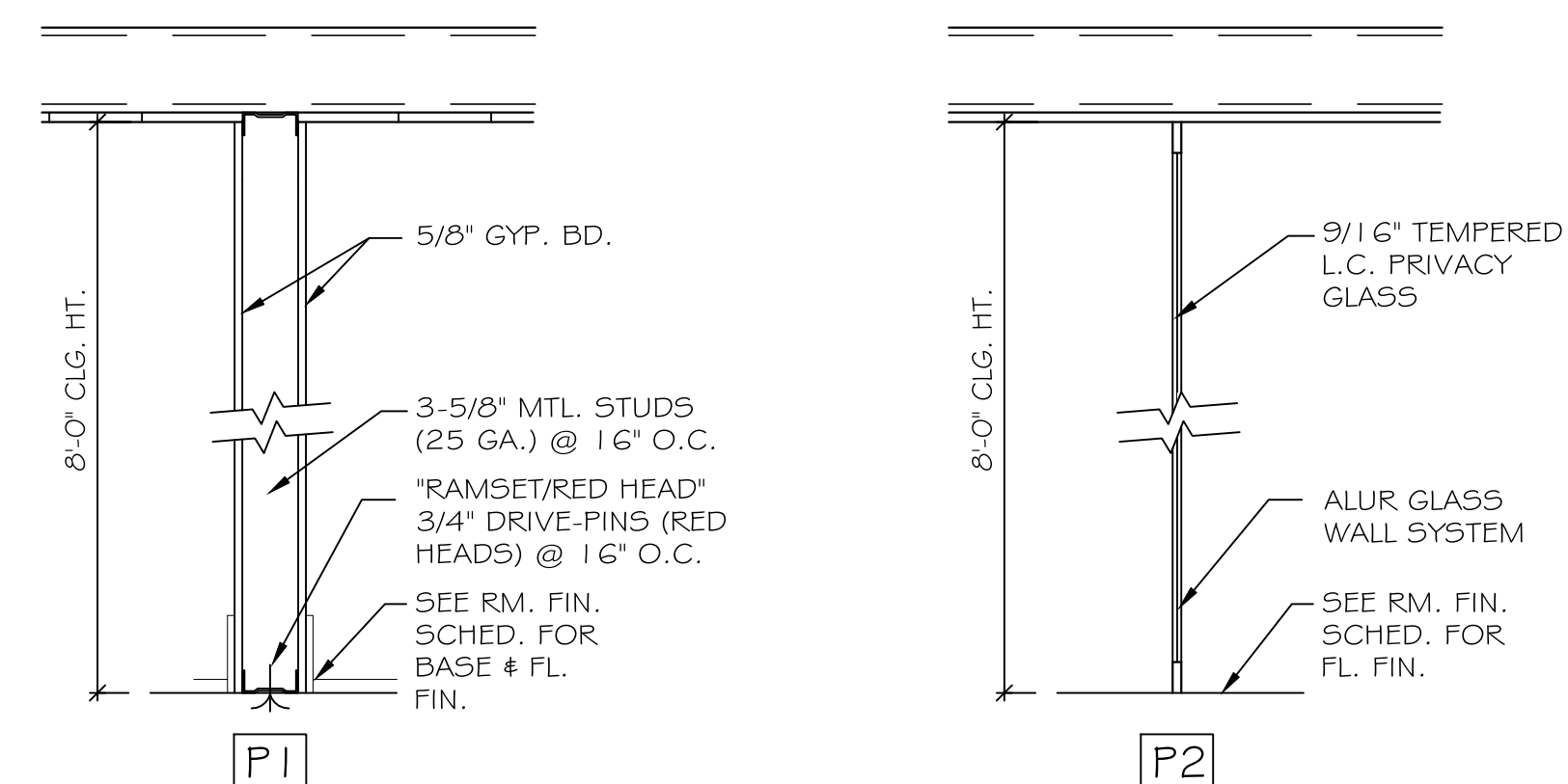

PARTITION DETAILS
1" = 1'-0"

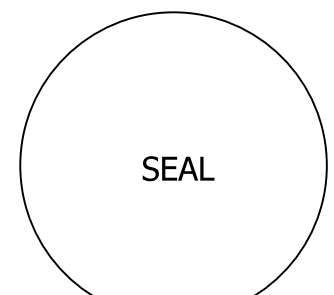

Steven W Siebert
AR0017834



STEVE SIEBERT
ARCHITECTURE

110 SE 4th Avenue, Suite 106
DELRAY BEACH, FL 33483
ph. 561.680.7894
steve@stevsiebert.com

TENANT IMPROVEMENT FOR:
Oceanside Veterinary Center
836 SE 5th Avenue
Delray Beach Florida, 33483

WRITTEN DIMENSIONS ON THESE DRAWINGS SHALL HAVE PRECEDENCE OVER SCALE DIMENSIONS. CONTRACTOR SHALL VERIFY AND BE RESPONSIBLE FOR ALL DIMENSIONS AND CONDITIONS ON THE JOB, AND THIS OFFICE MUST BE NOTIFIED OF ANY VARIATION FROM THE DIMENSIONS. COPYRIGHT STEVE SIEBERT ARCHITECTURE - UNAUTHORIZED REPRODUCTION OR OTHER USE OF THIS DRAWING IS PROHIBITED.

PROJECT NO.: 16-093
DATE: 6.27.16
DRAWN BY: S.W.S.
CHECKED BY: B.K.
REVISIONS:

FLOOR PLAN & SPECS

A1.1
SHEET NO.