

S:\101_Projects\2016\16.049_Camp_Canine_Mergate\16.049_CD\16.049_CampCanine_Mergate_CD.dwg

StevenVitek

7/27/2016 5:25:03 PM

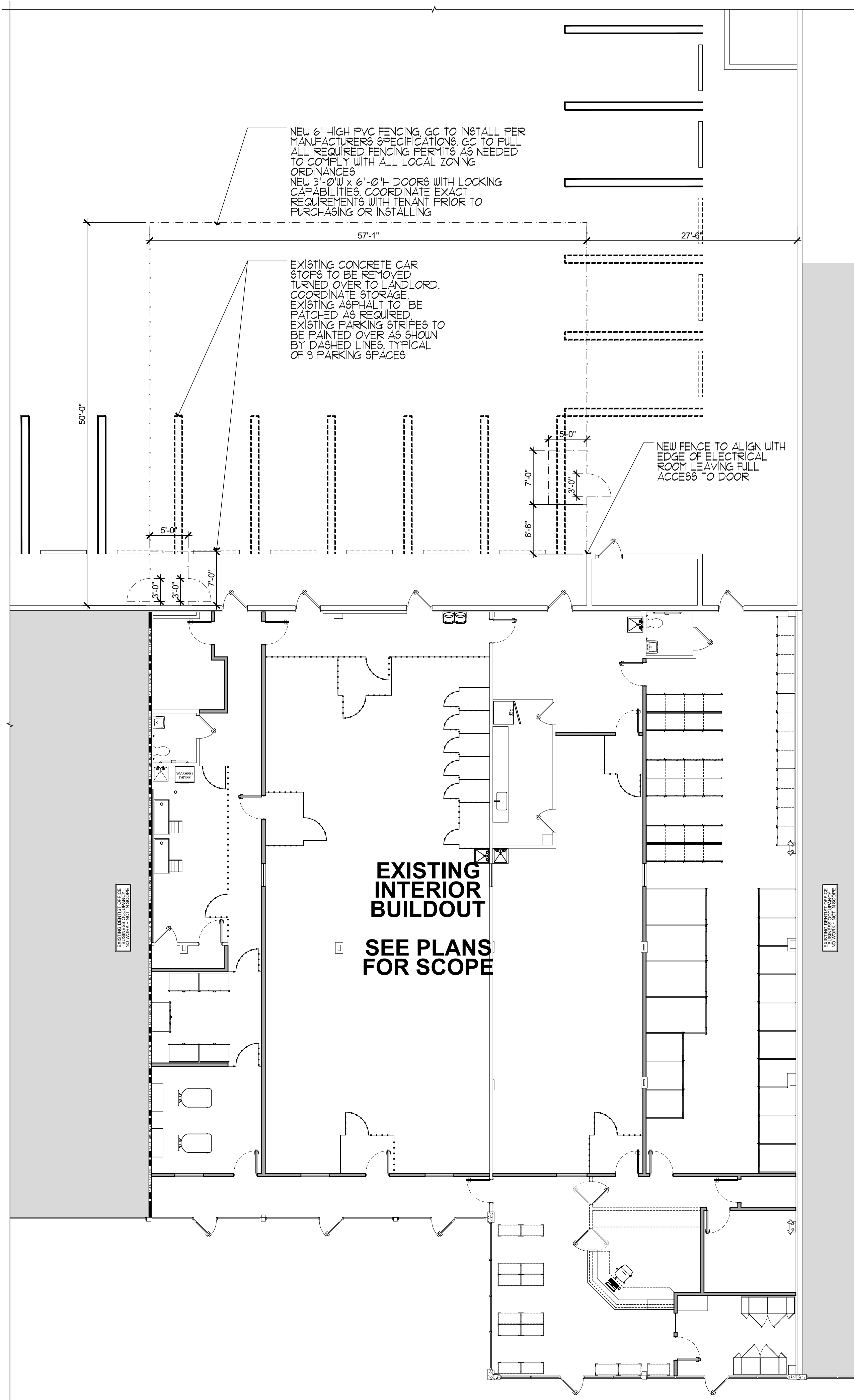

NEW 6' HIGH PVC FENCING, GC TO INSTALL PER MANUFACTURER'S SPECIFICATIONS, GC TO PULL ALL REQUIRED FENCING PERMITS AS NEEDED TO COMPLY WITH ALL LOCAL ZONING ORDINANCES
 NEW 3'-0" X 6'-0" DOORS WITH LOCKING CAPABILITIES, COORDINATE EXACT REQUIREMENTS WITH TENANT PRIOR TO PURCHASING OR INSTALLING

EXISTING CONCRETE CAR STOPS TO BE REMOVED
 TURNED OVER TO LANDLORD.
 COORDINATE STORAGE
 EXISTING ASPHALT TO BE PATCHED AS REQUIRED
 EXISTING PARKING STRIPES TO BE PAINTED OVER AS SHOWN BY DASHED LINES, TYPICAL OF 3 PARKING SPACES

NEW FENCE TO ALIGN WITH EDGE OF ELECTRICAL ROOM LEAVING FULL ACCESS TO DOOR

EXISTING INTERIOR BUILDOUT
SEE PLANS FOR SCOPE

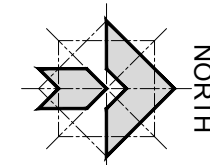

OVERALL FLOOR PLAN SHOWING OUTDOOR PLAY AREA 1
 SCALE: 1/8" = 1'-0"

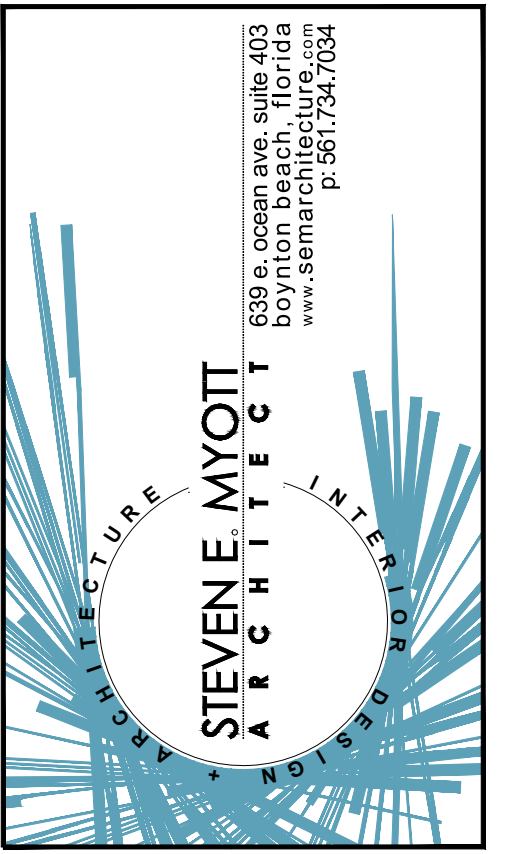

Camp Canine
 - INTERIOR RENOVATION -
 PENN DUTCH PLAZA
 3191 SR7
 MARGATE, FLORIDA 33063

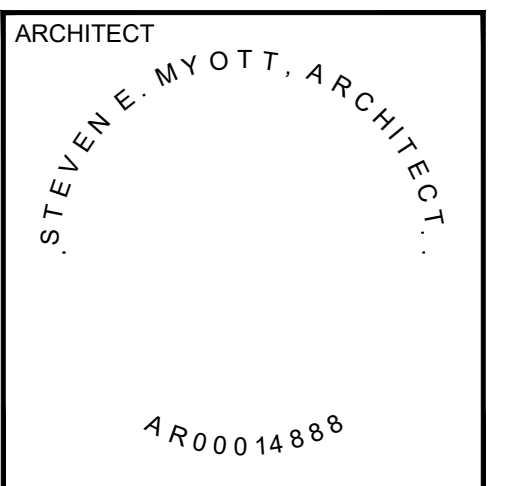

ALL DRAWINGS AND WRITTEN MATERIAL APPEARING HEREIN CONSTITUTE ORIGINAL AND UNPUBLISHED WORK OF THE ARCHITECT AND MAY NOT BE USED, REPRODUCED OR DISCLOSED IN ANY FORM WITHOUT THE EXPRESSED WRITTEN CONSENT OF THE ARCHITECT

PROJECT NO: 16.049
 DRAWN BY: SV
 CHECKED BY: SM

NO.	DATE	ISSUED FOR
1	02.10.2016	PRELIMINARY REVIEW

OVERALL PLAN SHOWING OUTDOOR PLAY AREA

A140
 PRINTED ON: 5/20/2016