

GENERAL NOTES

1. ALL MATERIAL, INSTALLATION, TESTING AND SPECIFICATIONS SHALL BE IN ACCORDANCE WITH THE REQUIREMENTS OF THE CITY OF BOCA RATON, THE FLORIDA DEPARTMENT OF TRANSPORTATION AND THE PALM BEACH COUNTY HEALTH DEPARTMENT.
2. LOCATION OF EXISTING UNDERGROUND UTILITIES HAS BEEN PREPARED FROM THE MOST RELIABLE INFORMATION AVAILABLE TO THE ENGINEER. THE CONTRACTOR SHALL BE RESPONSIBLE TO VERIFY LOCATION AND DEPTH OF ALL EXISTING UTILITIES. ANY DAMAGE DONE TO EXISTING UTILITIES SHALL BE REPAIRED BY THE CONTRACTOR AT HIS OWN EXPENSE TO THE SUBJECT UTILITY. CALL "SUNSHINE" (1-800-432-4770) 48 HOURS BEFORE DIGGING.
3. CONTRACTOR SHALL TAKE ALL NECESSARY PRECAUTIONS TO SAFEGUARD ALL EXISTING UTILITIES AND STRUCTURES. ANY DAMAGE DONE TO EXISTING UTILITIES SHALL BE REPAIRED BY THE CONTRACTOR AT HIS OWN EXPENSE TO THE SUBJECT UTILITY. CALL "SUNSHINE" (1-800-432-4770) 48 HOURS BEFORE DIGGING.
4. CONTRACTOR SHALL VERIFY LOCATION AND DEPTH OF ALL EXISTING UTILITIES. ANY DAMAGE DONE TO EXISTING UTILITIES SHALL BE REPAIRED BY THE CONTRACTOR AT HIS OWN EXPENSE TO THE SUBJECT UTILITY. CALL "SUNSHINE" (1-800-432-4770) 48 HOURS BEFORE DIGGING.
5. WATER SAMPLES FOR BACTERIOLOGICAL ANALYSIS SHALL BE TAKEN ONLY AFTER THE PRESSURE TESTS HAVE BEEN APPROVED BY CITY OF BOCA RATON UTILITIES DEPARTMENT.
6. ALL PIPE, FITTINGS, ETC. SHALL BE TESTED UNDER A CONSTANT PRESSURE REQUIREMENT AS PER AASHTO/M6 AND EXCEED THE LEAKAGE MAXIMUM ALLOWABLE LEAKAGE RATE:
 - L = ALLOWABLE LEAKAGE, GALLONS PER HOUR
 - L = LENGTH OF PIPE TEST SECTION, IN FEET
 - P = AVERAGE TEST PRESSURE, IN POUNDS PER SQUARE INCH

7. COMPLIANCE TO THE "TRENCH SAFETY ACT" IS REQUIRED FOR ALL EXCAVATION IN ACCESS OF FIVE FEET DEEP.
8. MINIMUM PIPE COVER SHALL BE 30" FOR D.I.P.
9. THE WATER SYSTEM SHALL BE CLEANED AND DISINFECTED ACCORDING TO AWWA C651-03.
10. WATER MAIN INSULATION SHALL COMPLY WITH THE REQUIREMENTS OF AWWA C900-03.
11. CONTRACTOR SHALL COORDINATE WITH CITY OF BOCA RATON, UTILITY SERVICES, AND PALM BEACH COUNTY, WATER DEPARTMENT. ANY DAMAGE DONE TO EXISTING UTILITIES SHALL BE REPAIRED BY THE CONTRACTOR AT HIS OWN EXPENSE TO THE SUBJECT UTILITY. CALL "SUNSHINE" (1-800-432-4770) 48 HOURS BEFORE DIGGING.
12. CONTRACTOR SHALL BE RESPONSIBLE FOR THE SUPPLY AND INSTALLATION OF WATER MAIN AND FORCE MAIN LINE STOPS TO CONTROL FLOWS DURING CUTTING, PLUGGING, OR ABANDONMENT OF EXISTING MAINS.
13. THE CONTRACTOR SHALL COORDINATE WITH THE CITY OF BOCA RATON, UTILITY SERVICES, TWO WEEKS PRIOR TO THE INSTALLATION OF ANY LINE STOPS. THE CITY RESERVES THE RIGHT TO HAVE A REPRESENTATIVE PRESENT DURING THE LINE STOPS INSTALLATION.
14. CONTRACTOR TO MAINTAIN AND ADJUST ALL EXISTING SANITARY MANHOLE COVERS, WATER METER BOXES AND VALVE BOXES TO FINISHED GRADE.

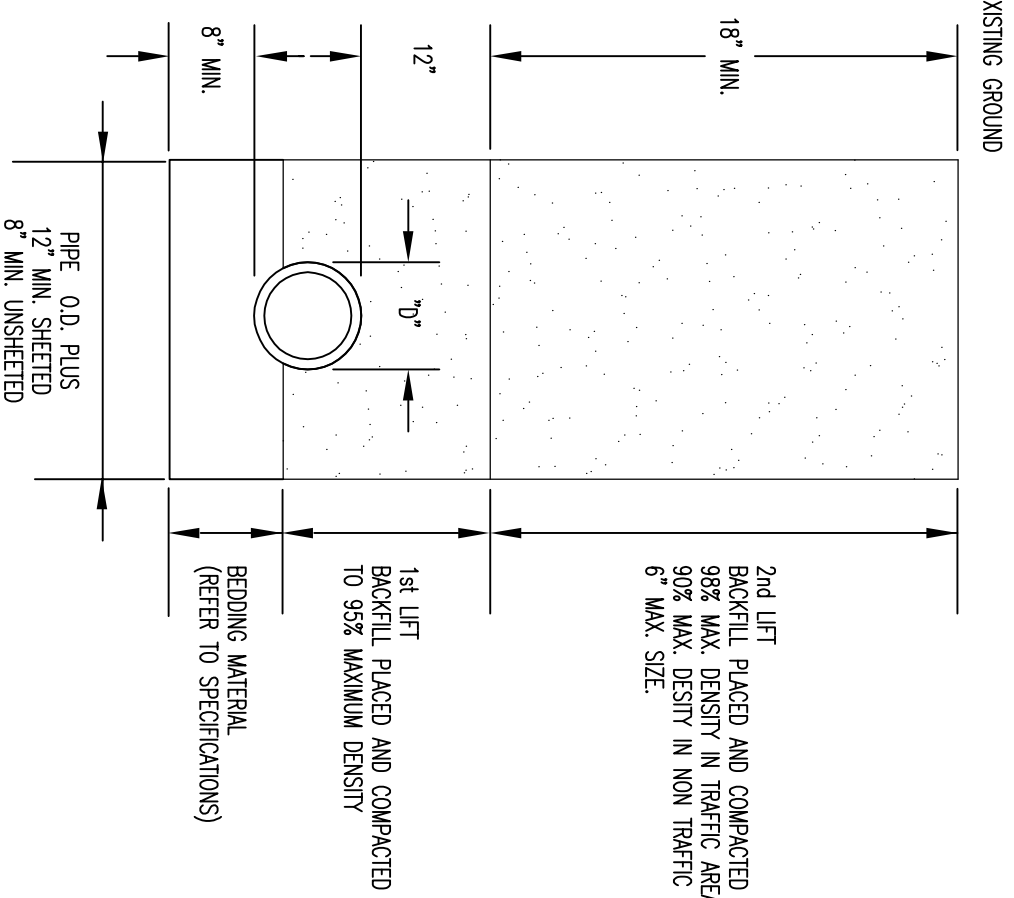

TYPICAL TRENCH EXCAVATION

1. FOR EXCAVATION AND BACKFILL AROUND MANHOLES, APPROPRIATE, OR IN ACCORDANCE WITH THE SPECIFICATIONS.
2. UNLESS OTHERWISE SPECIFIED, BACKFILL SHALL CONSIST OF WASHED AND GRADED LIMELOCK (3/8"-7/8").
3. SPECIFIC GRADE, SLOPING, AND SPOILING SHALL BE IN ACCORDANCE WITH THE SPECIFICATIONS.
4. REFER TO SPECIFICATIONS FOR EXCAVATION IN MUCK OR OTHER UNSUBSANTIAL MATERIAL.

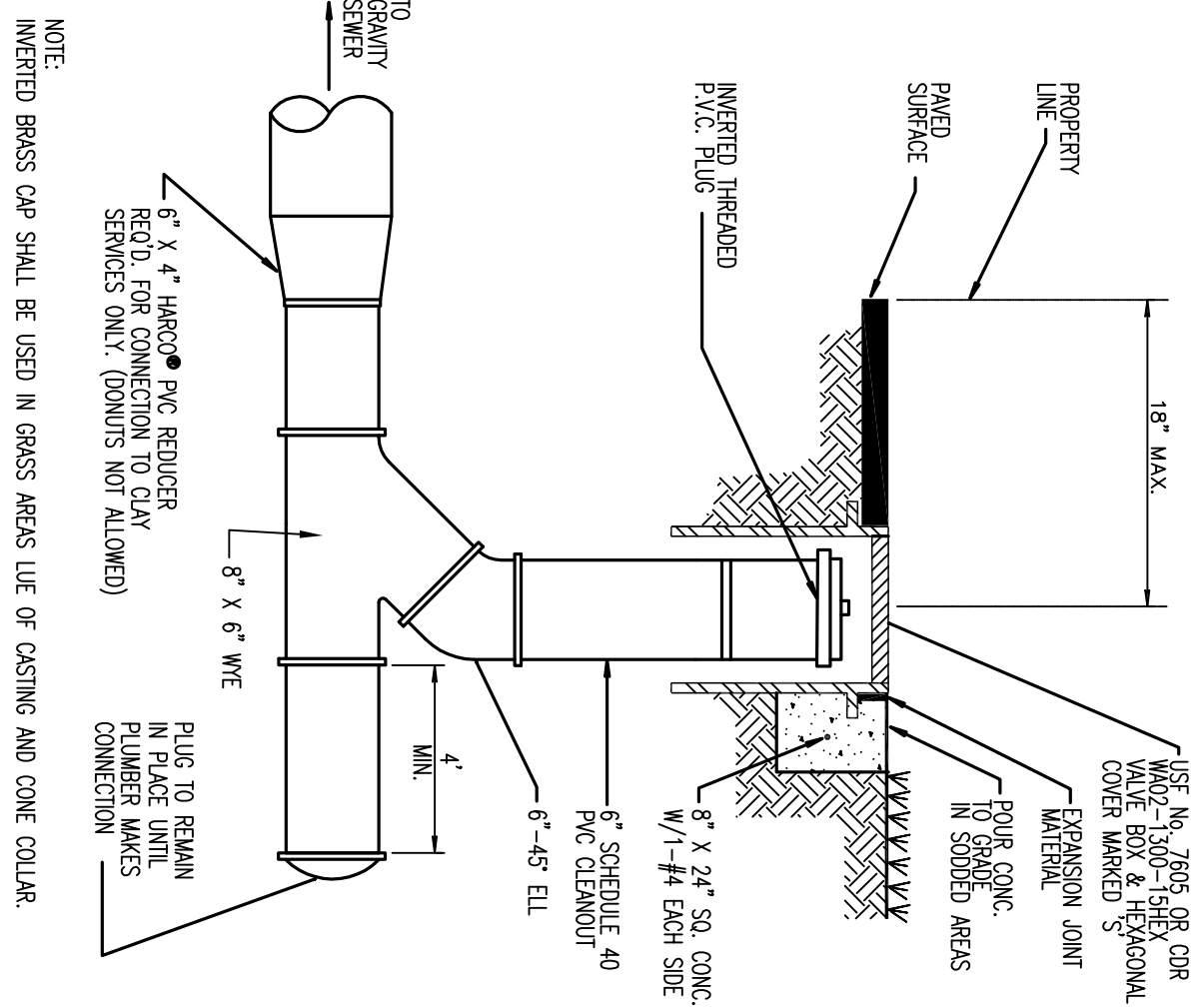

TYPICAL CLEANOUT DETAIL

NOTE: INSERTED BRASS CAP SHALL BE USED IN GRASS AREAS LIE OF CURBING AND CONCRE CURB.

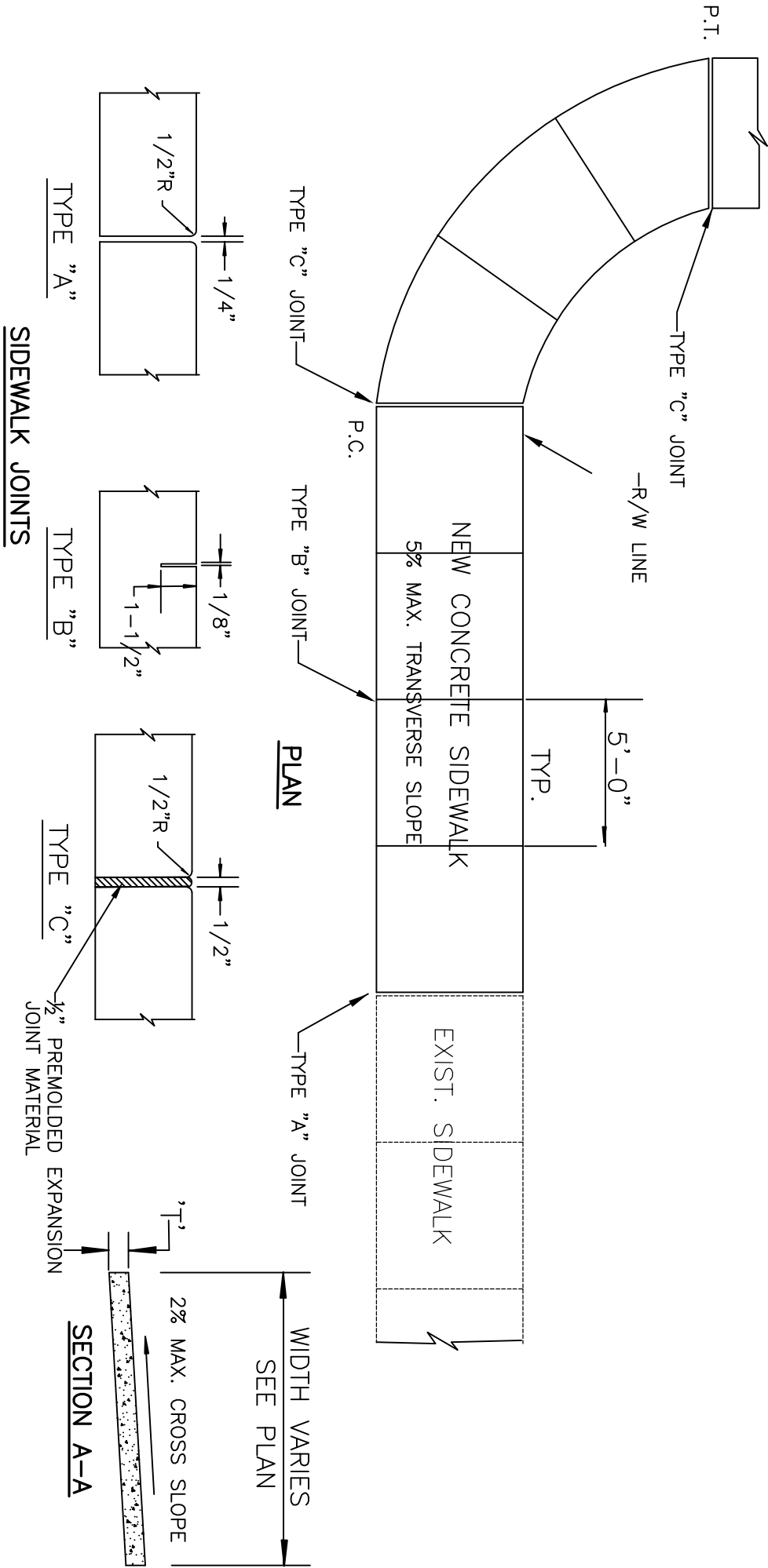

SIDEWALK JOINTS

| TABLE OF SIDEWALK JOINTS | TYPE | LOCATION |
|--------------------------|---|-----------------------------|
| "A" | P.C. AND P.T. OF CURBS AND DRIVEWAYS | AT DRIVEWAYS & 5' EACH SIDE |
| "B" | 5'-0" CENTER TO CENTER ON SIDEWALKS | |
| "C" | WHERE SIDEWALK ABUTS AGAINST BUILDINGS AND SIMILAR STRUCTURES | |

SIDEWALK DETAIL

N.T.S.

NOTE: CONCRETE SHALL HAVE 28 DAYS COMPRESSIVE STRENGTH OF 2500 PSI. ALL WALKS SHALL BE MARKED IN SECTIONS NOT TO EXCEED FIVE FEET. THE EDGE OF THE SIDEWALK SHALL HAVE A RADIUS OF 1/2". A SLOPE OF 1/4" PER FOOT SHALL BE MAINTAINED TOWARD THE STREET. JOINT TELLERS OF 1/4" THICKNESS SHALL BE PLACED AT 30" ON CENTER. A PERMIT IS REQUIRED BEFORE STARTING CONSTRUCTION. THE BASE SHALL BE STABILIZED AND DAMPPED PRIOR TO PLACEMENT OF THE CONCRETE. PROFILE GRADE IS THE CROWN OF THE ROAD UNLESS OTHERWISE SPECIFIED ON THE APPROVED PLANS.

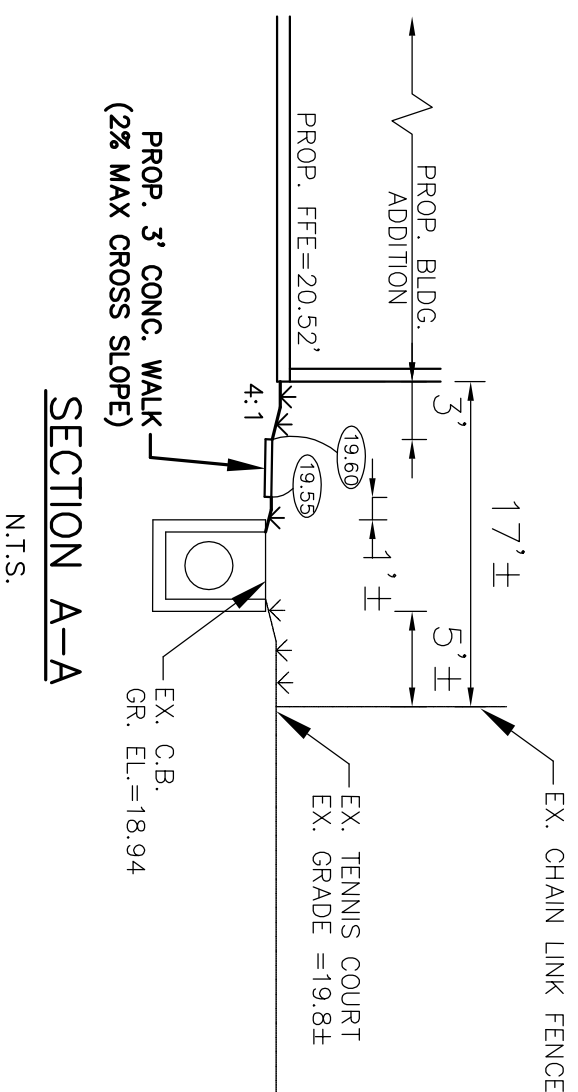

SECTION A-A

N.T.S.

- GENERAL NOTES:**
1. ALL MATERIAL, INSTALLATION, TESTING AND SPECIFICATIONS SHALL BE IN ACCORDANCE WITH THE REQUIREMENTS OF THE CITY OF BOCA RATON STANDARDS AND THE GOVERNING PERMITTING AND LICENSING AGENCIES WHERE APPLICABLE.
 2. ALL ELEVATIONS REFER TO N.G.V.D., NATIONAL GEODETIC VERTICAL DATUM.
 3. CONTRACTOR SHALL TAKE ALL NECESSARY PRECAUTIONS TO SAFEGUARD ALL EXISTING UTILITIES AND STRUCTURES. ANY DAMAGE DONE TO EXISTING UTILITIES SHALL BE REPAIRED BY THE CONTRACTOR AT HIS OWN EXPENSE TO THE SUBJECT UTILITY. CALL "SUNSHINE" (1-800-432-4770) 48 HOURS BEFORE DIGGING.
 4. LOCATIONS OF EXISTING UNDERGROUND UTILITIES SHOWN ON PLANS HAVE BEEN VERIFIED BY THE CONTRACTOR. THE CONTRACTOR SHALL BE RESPONSIBLE TO VERIFY THE LOCATION AND DEPTH OF ALL PERTINENT UTILITIES PRIOR TO COMMENCEMENT OF CONSTRUCTION.
 5. CONTRACTOR SHALL VERIFY LOCATION OF ALL UNDERGROUND UTILITIES PRIOR TO COMMENCEMENT OF CONSTRUCTION. ANY DAMAGE DONE TO EXISTING UTILITIES SHALL BE REPAIRED BY THE CONTRACTOR AT HIS OWN EXPENSE TO THE SUBJECT UTILITY. CALL "SUNSHINE" (1-800-432-4770) 48 HOURS BEFORE DIGGING.
 6. EXCAVATION SHALL BE SLOPED OR OTHERWISE SUPPORTED IN A SAFE MANNER IN ACCORDANCE WITH APPLICABLE STATE SAFETY REQUIREMENTS AND REQUIREMENTS OF OSHA SAFETY AND HEALTH STANDARD FOR CONSTRUCTION (29 CFR 1926).
 7. PRIOR TO THE CONSTRUCTION OR INSTALLATION, SHOP DRAWINGS SHALL BE SUBMITTED TO AND APPROVED BY THE ENGINEER OF RECORD FOR THE FOLLOWING: MANHOLES, CATCH BASINS, FIRE HYDRANTS, VALVES, PIPE MATERIAL, AND ALL REQUIRED ACCESSORIES FOR FIRE, WATER, STORM & SANITARY SEWER. IT IS THE RESPONSIBILITY OF THE CONTRACTOR TO OBTAIN ALL OTHER AGENCY APPROVALS, IF REQUIRED.

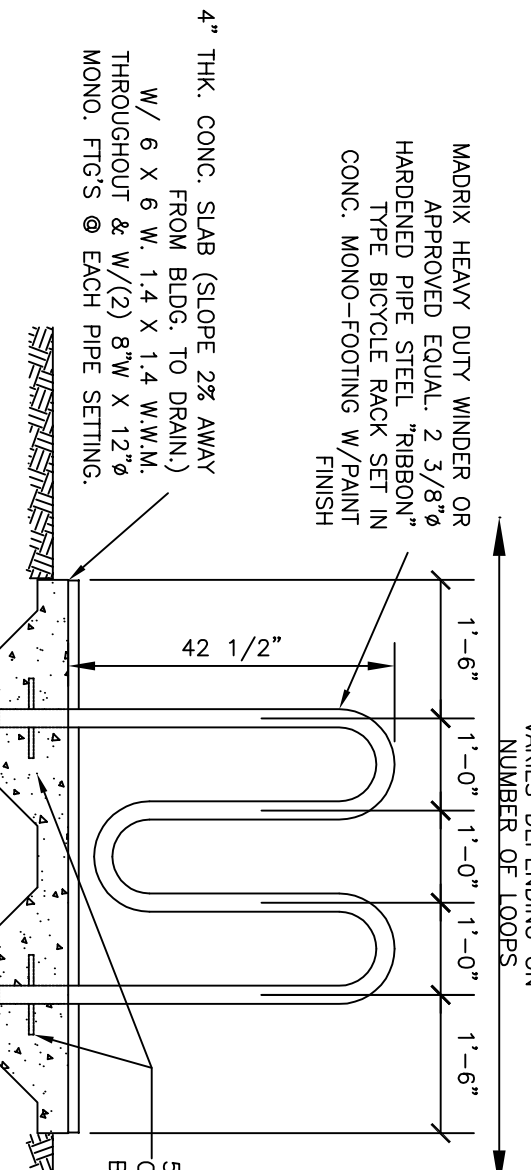

SHORT TERM BICYCLE PARKING DETAIL (TYP.)

- NOTES:
- ALL SHORT TERM BICYCLE PARKING SPACES SHALL BE MAINTAINED BY THE MUNICIPAL SERVICES DEPARTMENT. CONTRACTOR SHALL PROVIDE ADEQUATELY SUPPORTED CONCRETE SURFACE WHICH ADEQUATELY SUPPORTS THE WEIGHT AND WHEEL LOAD AT LEAST 180 LBS.
 - ALL LONG TERM FACILITIES SHALL CONFORM TO THE CITY OF BOCA RATON FACILITIES STANDARDS AND CONSTRUCTION STANDARDS.
 - FIXED OBJECTS WHICH ARE INTENDED TO SERVE AS BICYCLE PARKING SHALL BE CONSISTENT WITH THE CITY OF BOCA RATON FACILITIES STANDARDS AND CONSTRUCTION STANDARDS.
 - BICYCLE PARKING SHALL BE CONSISTENT WITH THE CITY OF BOCA RATON FACILITIES STANDARDS AND CONSTRUCTION STANDARDS.
 - BICYCLE PARKING SHALL BE CONSISTENT WITH THE CITY OF BOCA RATON FACILITIES STANDARDS AND CONSTRUCTION STANDARDS.
 - PRINCIPAL ENTRANCE OF THE BUILDING AS PRACTICABLE, SHALL BE LOCATED IN A CONVENIENT AND ACCESSIBLE LOCATION TO THE BICYCLE PARKING. THE BICYCLE PARKING SHALL BE LOCATED SO AS NOT TO IMPED FURNITURE MOVEMENT.

BIKE RACK DETAIL

N.T.S.

PAVEMENT MARKING AND SIGNING NOTES

1. PAVEMENT MARKING AND SIGNING SHALL BE IN ACCORDANCE WITH THE FLORIDA DEPARTMENT OF TRANSPORTATION TRAFFIC OPERATIONS STANDARDS MANUAL AND THE CITY OF BOCA RATON TRAFFIC ENGINEERING REQUIREMENTS.
2. ALL PAVEMENT MARKINGS SHALL BE PAINTED UNLESS OTHERWISE NOTED.

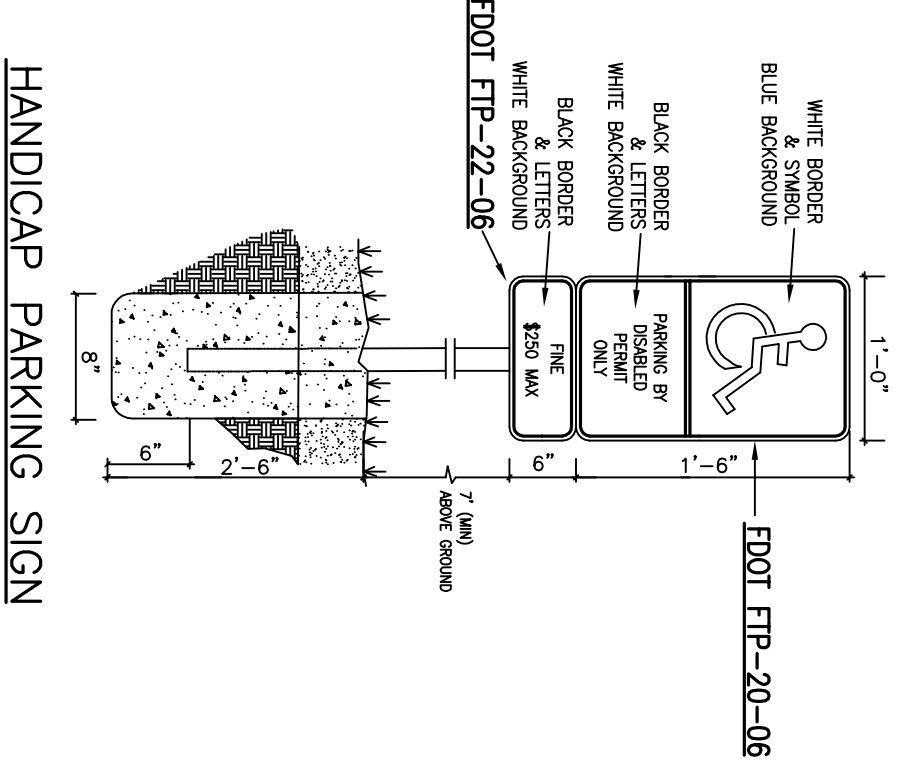

HANDICAP PARKING SIGN

N.T.S.

NOTE: ALL LETTERS "I" SERIES "C"

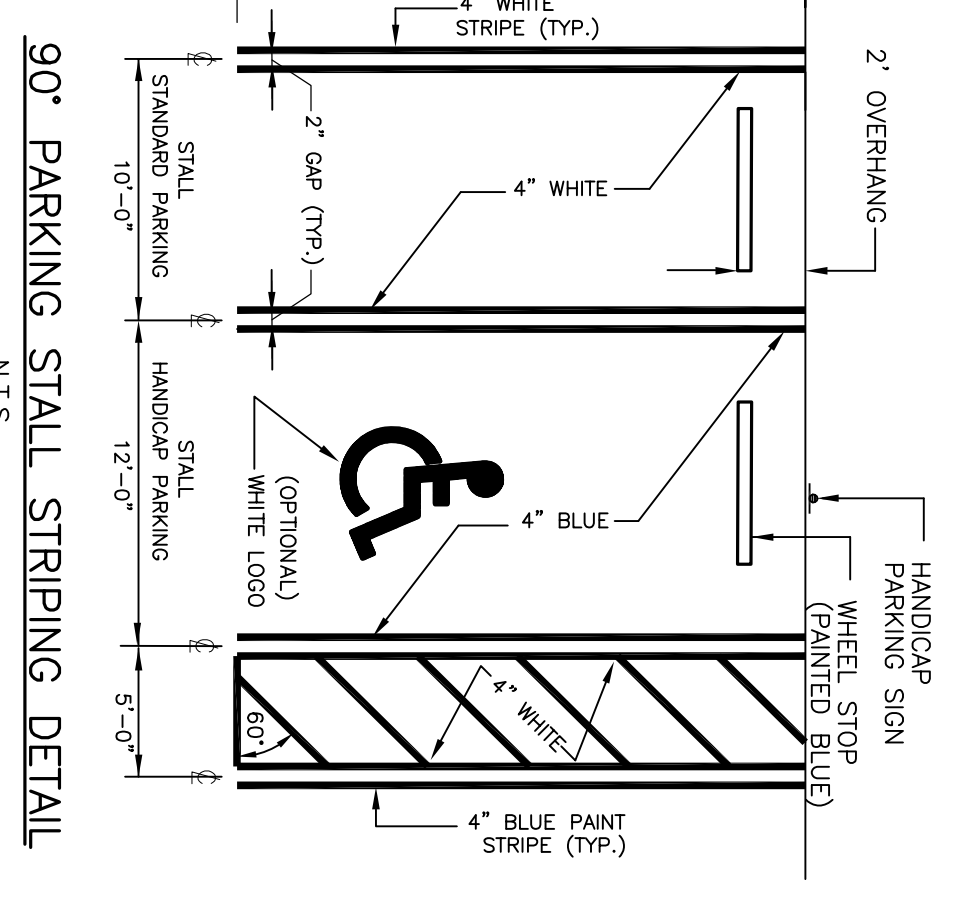

90° PARKING STALL STRIPING DETAIL

N.T.S.

"PROGRESS PRINT"
 PROJECT # _____
 THIS PLAN IS FOR REVIEW PURPOSES ONLY AND IS SUBJECT TO GOVERNMENTAL APPROVAL. NOT FOR CONSTRUCTION.

CITY OF BOCA RATON

NEAL B. JANOV #219958

DIVERSIFIED CONSTRUCTION
DCES
 & ENGINEERING SERVICES
 2295 N.W. CORPORATE BLVD, #125, BOCA RATON, FL 33431
 561-750-3717 FAX 561-750-3686
 EB #6459

| REVISIONS | DATE: | DWN.: | CHK.: |
|-----------|-------|-------|-------|
| 1 | | | |
| 2 | | | |
| 3 | | | |
| 4 | | | |
| 5 | | | |
| 6 | | | |
| 7 | | | |
| 8 | | | |

WOODFIELD HUNT CLUB
CLUBHOUSE RENOVATION AND EXPANSION
 4420 WOODFIELD BLVD.
 BOCA RATON, FLORIDA
 SITE ENGINEERING DETAILS

DCES
 SCALE: NONE
 DATE: 6-2-16
 DWN. BY: S.T.
 CHK. BY: N.B.J.
 F.B. PG.
 JOB NO.: 2121-15
 SHEET: C-2 OF 2