

GENERAL NOTES

1. ALL DIMENSIONS ARE NOMINAL TO FACE OF STUDS/MASONRY.
2. ALL VERTICAL DIMENSIONS ARE FROM FINISH FLOOR SLAB. AFF. ABBREVIATES "ABOVE FINISH FLOOR."
3. THE ARCHITECT AND ENGINEER ACCEPT NO RESPONSIBILITY FOR WORK WHICH IS NOT IN COMPLIANCE WITH THE INTENT AND REQUIREMENTS OF THE DRAWINGS, OR WHICH HAS BEEN PERFORMED BASED UPON THE INTERPRETATION OF INTENT OF THE DRAWINGS BY PARTIES OTHER THAN THE ARCHITECT AND ENGINEER.
4. THE GENERAL CONTRACTOR SHALL VERIFY ALL DIMENSIONS AND EXISTING CONDITIONS PRIOR TO BIDDING AND STARTING CONSTRUCTION. NOTIFY ARCHITECT OF ANY DISCREPANCIES OR INCONSISTENCIES.
5. ALL WORK SHALL BE DONE IN STRICT ACCORDANCE WITH THE FLORIDA BUILDING CODE 2014, INCLUDING ADOPTED LOCAL AMENDMENTS.
6. DIMENSIONS TAKE PRECEDENCE OVER SCALING OF PLANS, SECTIONS, AND DETAILS. DIMENSIONS ARE NOMINAL AND TO FACE OF STUDS/MASONRY UNLESS NOTED OTHERWISE.
7. CONTRACTOR SHALL BE RESPONSIBLE FOR CUTTING, PATCHING AND FITTING OF ALL WORK IN A NEAT AND WORKMANLIKE MANNER. PROTECT ALL ADJACENT SURFACES FROM DAMAGE. PATCH AND REPAIR ALL WORK DAMAGED DURING CONSTRUCTION TO ITS ORIGINAL OR BETTER CONDITION. MATCH ADJACENT FINISHES, MATERIALS, TEXTURES, SHEEN, ETC.
8. THE SCOPE OF WORK SHALL NOT HINDER OR INTERFERE WITH EMERGENCY ACCESS TO THE SAID PROPERTY OR THE VICINITY THEREOF (INCLUDING STREETS, ROADS, FIRE LANES).

PALM BEACH COUNTY STATE OF FLORIDA



PBC R.G. KREUSLER PARK RESTROOM BUILDING AND ENTRY DRIVE MODIFICATIONS

COUNTY PROJECT NO. 14204
BID DOCUMENTS
DATE: JULY 22, 2016

BOARD OF COUNTY COMMISSIONERS

MARY LOU BERGER, MAYOR
HAL R. VALECHE, VICE MAYOR
PAULETTE BURDICK
SHELLEY VANA
STEVEN L. ABRAMS
MELISSA MCKINLAY
PRISCILLA A. TAYLOR

DISTRICT 5
DISTRICT 1
DISTRICT 2
DISTRICT 3
DISTRICT 4
DISTRICT 6
DISTRICT 7

FACILITIES DEVELOPMENT & OPERATIONS
CAPITAL IMPROVEMENTS DIVISION
WEST PALM BEACH, FLORIDA

INDEX OF DRAWINGS

COVER	MECHANICAL
SURVEY	M-1 LEGEND, GENERAL NOTES AND SCHEDULES
1 SPECIFIC PURPOSE SURVEY COVER SHEET	M-2 HVAC FLOOR PLANS
2 SPECIFIC PURPOSE SURVEY	M-3 MECHANICAL DETAILS
ARCHITECTURAL	PLUMBING
SP-1 NOT USED	P-1 LEGEND AND FIXTURE SCHEDULE
SP-2 SITE PLAN AND CONSTRUCTION FACILITIES PLAN	P-2 SANITARY PLAN AND RISER DIAGRAMS
LS-1 LIFE SAFETY PLAN	P-3 WATER PLAN AND RISER DIAGRAM
A-1 FLOOR PLAN AND SCHEDULES	ELECTRICAL
A-2 REFLECTED CEILING PLAN AND INTERIOR ELEVATIONS	E-1 PARTIAL ELECTRICAL SITE PLAN
A-3 BUILDING ELEVATIONS AND DETAILS	E-2 LIGHTING, POWER AND SYSTEMS PLAN
A-4 ROOF PLAN	E-3 SCHEDULE, LEGEND AND DETAILS
A-5 SECTIONS	CIVIL
STRUCTURAL	C-1 ROADWAY ALTERATION PLAN
S-1 FOUNDATION PLAN	C-2 DETAILS AND NOTES
S-2 ROOF PLAN	
S-3 WIND PRESSURES, STRUCTURAL NOTES, SCHEDULES	
S-4 TYP DETAILS AND SECTIONS	

LOCATION MAP

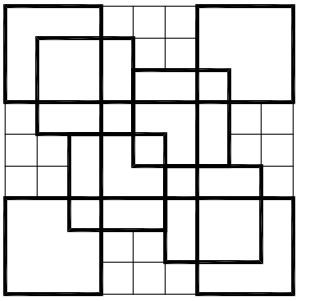
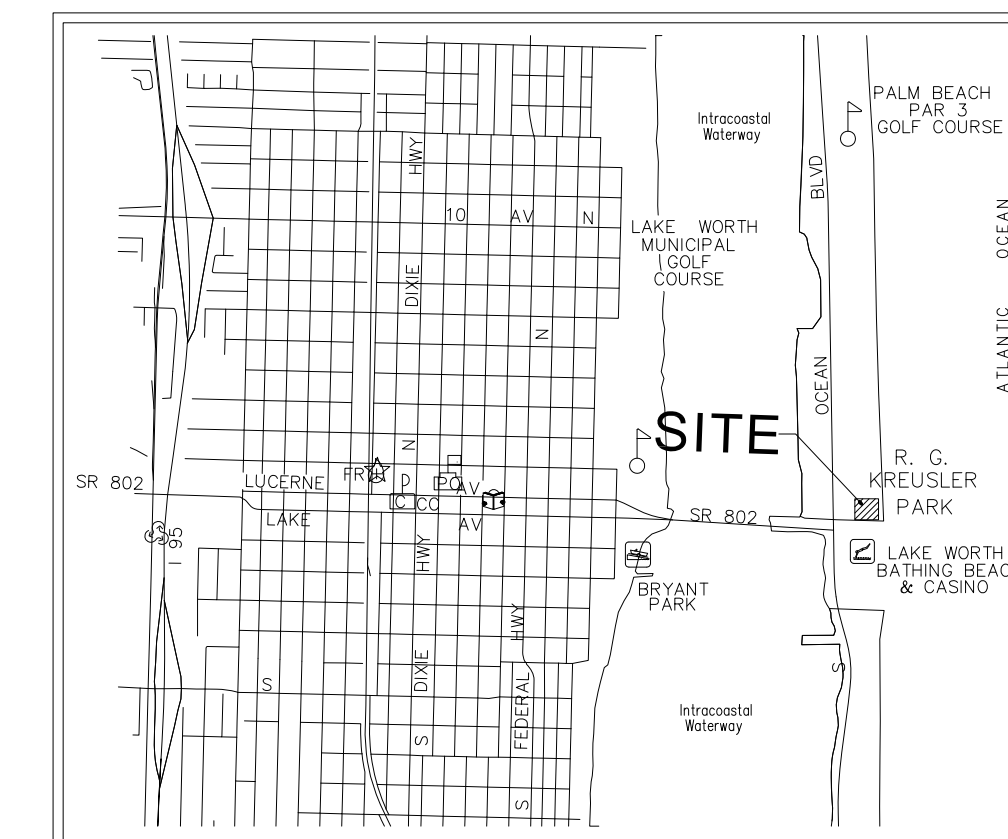

COLOME & Associates, Inc.
AA 0003439
530 24TH STREET
WEST PALM BEACH
FLORIDA 33407
(561) 833-9147
ARCHITECT: ELIZABETH A. G. COLOME
REG. NUMBER: AR 0014839

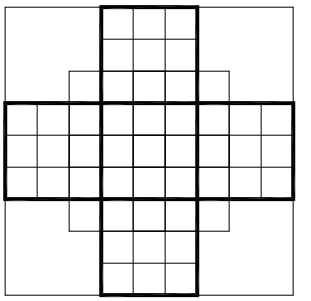

P. B. C.
R.G. KREUSLER PARK
RESTROOM BUILDING
AND ENTRY DRIVE
MODIFICATIONS

PBC NO 14204
2016

LAKE WORTH
FLORIDA

PROJECT NO.
201402

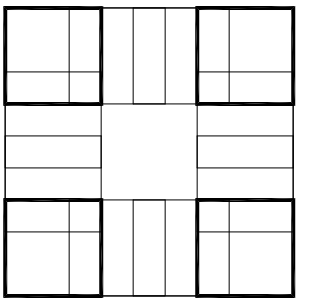

SHEET TITLE
COVER

REVISIONS:

DATE
11/20/15
DRAWN BY:
DM
CHECKED BY:
EAC

SHEET
NUMBER

COVER