

Landmark Summary

Project: GOODWILL VEH. - PHASE 1 SITE - JUL. 28, 2018

Symbol	ID	Land	Description	Comments	GLD	LR	MP	LP	Loc. Wtch	Total Wtch
□	5	SA	PELPE GARAGE 101-2-2024-2024-000 POLE MOUNT TO A.F.A.		K.A.	8.000	8.000	8.000	216.3	1081.6
□	1	SA1	PELPE GARAGE 101-2-2024-2024-000 POLE MOUNT TO A.F.A.		K.A.	8.000	8.000	8.000	216.3	426.8
□	1	SA	PELPE GARAGE 101-2-2024-2024-000 POLE MOUNT TO A.F.A.		K.A.	8.000	8.000	8.000	191.1	191.1
□	3	SC	PELPE GARAGE 101-2-2024-2024-000 POLE MOUNT TO A.F.A.		K.A.	8.000	8.000	8.000	210	630
□	1	SC1	PELPE GARAGE 101-2-2024-2024-000 POLE MOUNT TO A.F.A.		K.A.	8.000	8.000	8.000	192.2	192.2
□	1	SA	PELPE GARAGE 101-2-2024-2024-000 POLE MOUNT TO A.F.A.		K.A.	8.000	8.000	8.000	216.7	216.7
□	1	W	PELPE GARAGE 101-2-2024-2024-000		K.A.	8.000	8.000	8.000	210	210
□	1	W1	PELPE GARAGE 101-2-2024-2024-000		K.A.	8.000	8.000	8.000	210	210

Calculation Summary

Project: GOODWILL VEH. - PHASE 1 SITE - JUL. 28, 2018

Land	GLD	LR	MP	LP	Loc. Wtch	Total Wtch
PELPE & DRIVE	2.24	8.3	1.0	2.26	2.26	8.30

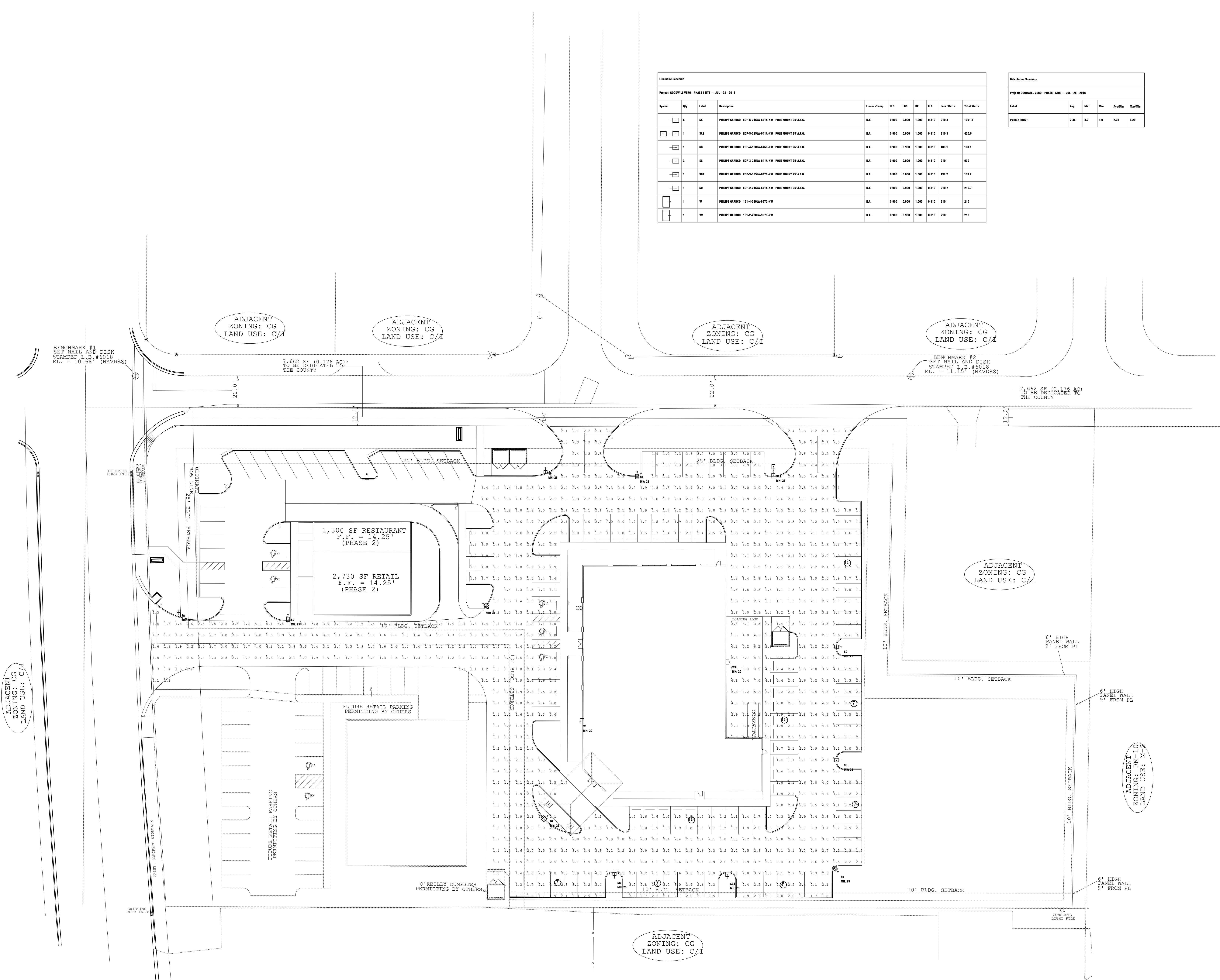

BENCHMARK #1
SET WALL AND DISK
STAMPED L.B.#6018
E.L. = 10.88' (NAVD88)

7,662 SF (0.176 AC)
TO BE DEDICATED TO
THE COUNTY

BENCHMARK #2
SET WALL AND DISK
STAMPED L.B.#6018
E.L. = 11.15' (NAVD88)

7,662 SF (0.176 AC)
TO BE DEDICATED TO
THE COUNTY

ADJACENT
ZONING: CG
LAND USE: C/I

ADJACENT
ZONING: CG
LAND USE: C/I

ADJACENT
ZONING: RM-10
LAND USE: R-2