

SYMBOL LEGEND	
	ACCESSIBILITY RATED ILLUMINATED EXIT SIGN WITH BATTERY BACK-UP BY BEGHELLI MODAL VA4-R-SA-AT
	2 HEAD EMERGENCY FLOOD LIGHT WITH BATTERY BACK-UP BY BEGHELLI MODAL FEH-AT
	NEW COMBO EMERGENCY/EXIT LIGHT WITH BATTERY BACK-UP BY BEGHELLI MODAL PCH-G-AT

INTERIOR FINISHES CLASSIFICATION NOTE
 ALL INTERIOR FINISHES TO BE MINIMUM CLASS "C" (FLAMES/PREAR 16-200, SMOKE DEVELOPED 0-450 AS NFPA TABLE A.102.2).

GOVERNING CODE
 FLORIDA BUILDING CODE 2014.

SIGNAGE
 SIGNAGE IS NOT IN THIS SCOPE OF WORK.

OCCUPANCY SUMMARY

USE	AREA S. F.	S.F. / PERSON	OCCUPANTS
STORAGE	5,000	500 (GROSS)	10
MERCANTILE	10,000	30 (GROSS)	334
TOTAL LEASABLE AREA 15,000 SQ FT			TOTAL OCCUPANTS: 344

LIFE SAFETY CRITERIA

OCCUPANCY: (TABLE - 1004.12 OF F.B.C.-2014) 344 PERSONS

MEANS OF EGRESS REQUIRED: (SECTION 1009.3.2 OF F.B.C.-2014) 2 INCHES PER PERSON x 344 = 688"

MEANS OF EGRESS PROVIDED: 4 @ 36" = 144" AT FRONT
 3 @ 36" = 108" AT REAR
 252" TOTAL

FIRE EXTINGUISHER SPECIFICATION

INSTALL MINIMUM CLASS 3A-40BC CERTIFIED DRY CHEMICAL TYPE B 5 POUND MANUAL FIRE EXTINGUISHER RATED TO COMPLY WITH ANSI/UL299 ULC-8904 AND TO MEET ALL REQUIREMENTS OF NFPA10 AND ALL APPLICABLE CODES. INSTALL SUCH THAT TOP OF UNIT IS NO HIGHER THAN 5'-0" AND BOTTOM IS NOT LOWER THAN 4". COORDINATE INSTALLATION WITH FIRE DEPARTMENT.

EMERGENCY LIGHTING

THE SHADED AREAS INDICATE A ZONE OF LIGHTING ALONG THE PATH OF EGRESS SHOWN WHICH PROVIDES A MINIMUM OF ONE FOOT-CANDLE OF LIGHTING AT THE FLOOR LEVEL. THIS LIGHTING PATTERN IS FOR THE SPECIFICATIONS PROVIDED BY THE MANUFACTURER OF THE EMERGENCY LIGHTING FIXTURE SPECIFIED. ADJUST HEADS DIRECTIONALLY TO INSURE A CENTERED FOCUS ALONG THE VARIOUS PATHS OF EGRESS SHOWN.

EGRESS DOORS HARDWARE

EGRESS EXTERIOR DOORS SHALL COMPLY WITH FLORIDA BUILDING CODE 2014 - BUILDING, 1008.1.3 DOORS SHALL BE READILY OPERABLE FROM THE EGRESS SIDE WITHOUT THE USE OF A KEY OR SPECIAL KNOWLEDGE OR EFFORT. SECTION 1008.1.3.1 DOOR HANDLES, PULLS, LATCHES, LOCKS AND OTHER OPERATING DEVICES ON DOORS REQUIRED TO BE ACCESSIBLE BY CHAPTER 11 SHALL NOT REQUIRE TIGHT GRASPING, TIGHT PINCHING OR TWISTING OF THE WRIST TO OPERATE. SECTION 1008.1.3.4 MANUALLY OPERATED FLUSH BOLTS OR SURFACE BOLTS ARE NOT PERMITTED. ALL HARDWARE MUST BE DIRECT ACTING REQUIRING NO MORE THAN ONE OPERATION. CONTRACTOR WILL VERIFY THAT THE LOCKS ON THE EGRESS DOORS COMPLY WITH THESE CODE. IF NOT, CONTRACTOR WILL INSTALL LOCKS PER THESE CODE.

EGRESS DOORS REQUIREMENTS

DOORS THAT ARE UTILIZED AS A MEANS OF EGRESS SHALL MEET THE REQUIREMENTS OF NFPA 101, 7.2.1.3. NOTE: SECURITY ACCESS MECHANISMS ARE ONLY LOCATED ON THE FULL SIDE OF THE DOOR FOR SECURITY ACCESS TO AREAS. CONTINUOUS EXIT ACCESS WITHOUT SECURITY SWIPE IS PROVIDED ON EGRESS (PUSH) SIDE.

THE SPRINKLER SYSTEM SHALL BE BY A LICENSED CONTRACTOR UNDER A SEPARATE PERMIT, INCLUDING SHOP DRAWINGS AND CALCULATIONS.

THE FIRE ALARM SYSTEM SHALL BE BY A LICENSED CONTRACTOR UNDER A SEPARATE PERMIT, INCLUDING SHOP DRAWINGS AND CALCULATIONS.

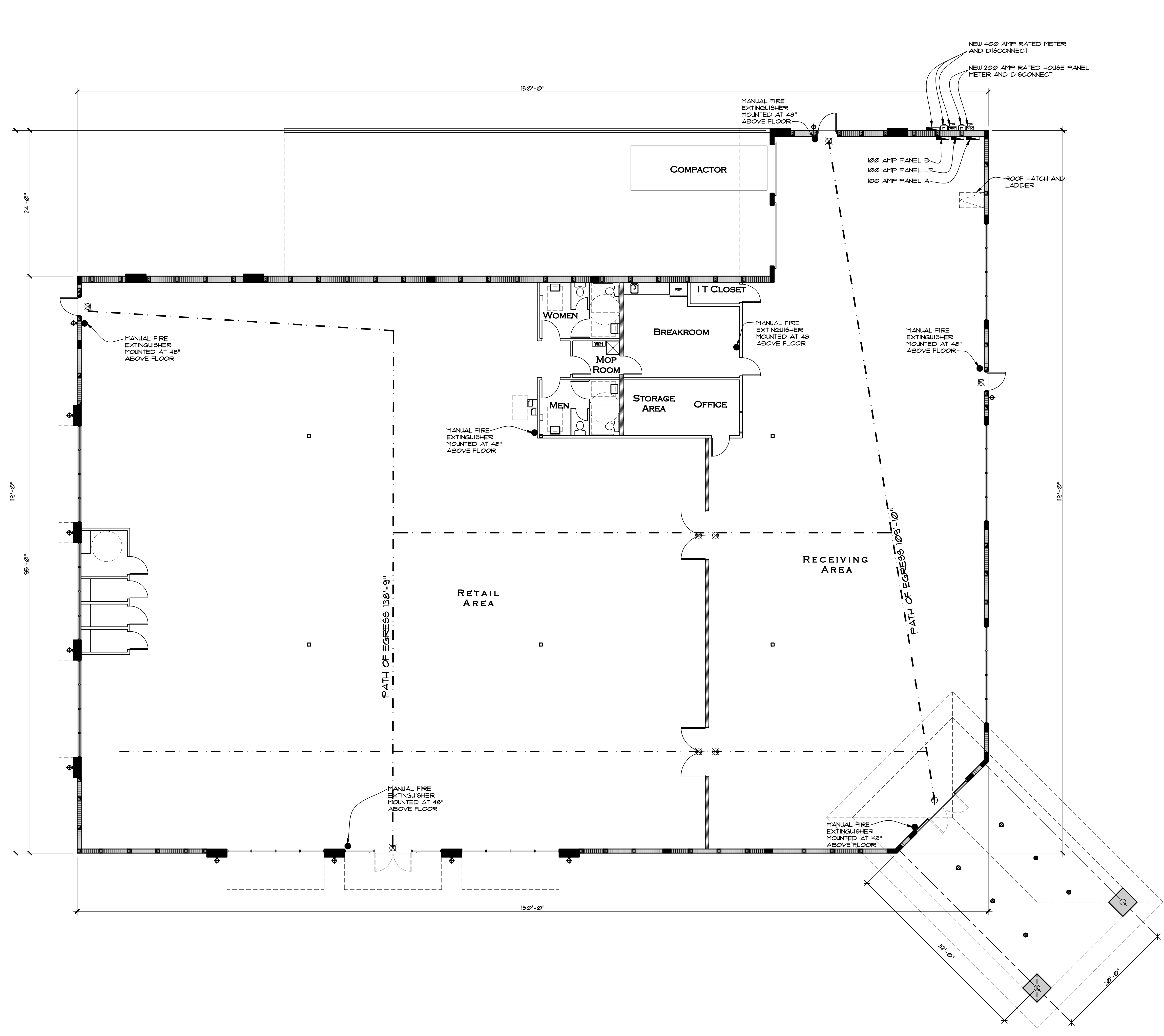

LIFE SAFETY PLAN
 SCALE: 1/8" = 1'-0"

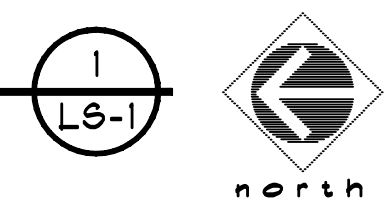

- Revisions:
- 1
 - 2
 - 3
 - 4
 - 5

Project Number
160412

1066 U.S. HIGHWAY 1
NEW RETAIL BUILDING - GOODWILL
1066 U.S. HIGHWAY 1
VERO BEACH, FLORIDA

Project Name
NEW RETAIL BUILDING

STEPHEN BRASGALLA, ARCHITECT
 STATE OF FLORIDA
 REGISTRATION NO. AR12239
 6901 WEST BROWARD BOULEVARD SUITE 100
 PLANTATION, FLORIDA 33317
 TELEPHONE 954.614.3801
 TELEFAX 954.208.0800
 ARCHITECT @ DESIGN23.NET

AS ISSUED FOR PERMIT 7-29-16 (NOT FOR CONSTRUCTION)

Drawn By: RSS	Checked By: STB
Scale: SHOWN	Date: 7-29-16

Project Number
160412

Sheet:
LS - 1