

# ELECTRICAL NOTES

- GENERAL: ALL WORK SHALL CONFORM TO THE LATEST APPROVED EDITION OF THE NATIONAL ELECTRICAL CODE (NEC) AND ALL LOCAL JURISDICTIONAL CODES.  
THE CONSTRUCTION SHALL BE IN ACCORDANCE WITH THE DRAWINGS AND ANY APPLICABLE SPECIFICATIONS. IF A PROBLEM IS ENCOUNTERED IN COMPLYING WITH THIS REQUIREMENT, THE CONTRACTOR SHALL NOTIFY THE OWNER OR HIS REPRESENTATIVE AS SOON AS POSSIBLE AFTER DISCOVERY OF THE PROBLEM, AND SHALL NOT PROCEED WITH THAT PORTION OF THE WORK UNTIL THE OWNER HAS DIRECTED THE CORRECTIVE ACTION TO BE TAKEN.  
THE CONTRACTOR SHALL COORDINATE THE PROPOSED LOCATIONS OF ALL ELECTRICAL MATERIALS AND EQUIPMENT WITH THE REPRESENTATIVES OF THE OTHER TRADES INVOLVED BEFORE STARTING INSTALLATION OF THOSE ITEMS.  
COORDINATE THE INSTALLATION OF REQUIRED SUPPORTING DEVICES, CONDUIT, AND SLEEVES TO BE SET IN CAST-IN-PLACE CONCRETE AND OTHER STRUCTURAL COMPONENTS, AS THEY ARE CONSTRUCTED.  
UNLESS OTHERWISE SPECIFIED ON THE PLANS, ALL SPECS ARE NOT INTENDED TO BE PROPRIETARY, SUBSTITUTIONS WILL BE ACCEPTABLE FOR EQUAL RATED AND LISTED UNITS.
- SCOPE: EXCEPT WHERE OTHERWISE SPECIFICALLY INDICATED ON THE DRAWINGS BY "FUTURE", "BY OTHERS" OR BY A SIMILAR NOTATION, IT IS THE INTENT THAT THE CONTRACTOR FURNISH ALL LABOR, MATERIALS, EQUIPMENT AND TOOLS NECESSARY TO PROVIDE ALL SYSTEMS IN COMPLETE AND OPERATING CONDITION.
- EXCAVATE AS NECESSARY FOR THE INSTALLATION OF ELECTRICAL MATERIALS AND EQUIPMENT. VERIFY THE LOCATIONS OF UNDERGROUND UTILITIES OR STRUCTURES BEFORE EXCAVATING AND EXERCISE CARE TO AVOID DAMAGE TO SUCH ITEMS DURING EXCAVATION. BACKFILL WITH EARTH FREE OF LARGE CLODS, LARGE STONES AND FOREIGN DEBRIS, DEPOSITED IN 6" LAYERS AND COMPACTED TO A DENSITY OF NOT LESS THAN THAT OF THE SURROUNDING UNDISTURBED MATERIAL.
- MATERIALS: THE MATERIALS AND EQUIPMENT FURNISHED SHALL BE AS INDICATED ON THE DRAWINGS; SUBSTITUTIONS SHALL NOT BE MADE EXCEPT WHERE EXPRESSLY APPROVED BY THE OWNER OR HIS REPRESENTATIVE PRIOR TO STARTING INSTALLATION OF THE ITEMS. THE ELECTRICAL MATERIALS AND EQUIPMENT FURNISHED SHALL BE LISTED OR LABELED BY UNDERWRITERS LABORATORIES OR OTHER RECOGNIZED TESTING ORGANIZATION, AND SHALL BE ACCEPTABLE TO THE LOCAL BUILDING AUTHORITY.
- GROUNDING: GROUNDING SHALL BE IN ACCORDANCE WITH ARTICLE 250, NEC.
- CONDUITS: PROVIDE CONDUITS WHERE CALLED FOR ON PANEL SCHEDULES; ELECTRICAL METALLIC TUBING (EMT) SHALL BE INSTALLED ONLY IN DRY LOCATIONS, IN CONCRETE ABOVE GRADE, AND WHERE NOT SUBJECT TO PHYSICAL DAMAGE.  
CONDUITS INSTALLED UNDERGROUND SHALL BE POLYVINYLCHLORIDE (PVC) AND SHALL NOT BE SMALLER THAN 3/4" TRADE SIZE. WHERE PVC CONDUIT IS INSTALLED UNDERGROUND, ELBOWS TURNING UP AND CONDUIT EMERGING ABOVE GRADE SHALL BE RSC. THE TOPS OF CONDUITS SHALL NOT BE LESS THAN 24" BELOW FINISHED GRADE. PVC CONDUIT INSTALLED ABOVE GRADE OR DIRECT-BURIED IN EARTH SHALL BE NEMA TC2 TYPE EPC-40-PVC (SCHEDULE 40) EXCEPT THAT WHERE UNDER AREAS SUBJECT TO HEAVY VEHICULAR TRAFFIC, IT SHALL BE NEMA TC2 TYPE EPC-80-PVC (SCHEDULE 80).  
ALL ARMOR CLAD CABLE (AC CABLE) WIRING SHALL MEET OR EXCEED ALL NEC, OSHA AND HUD STANDARDS.
- CONDUCTORS: CONDUCTORS SHALL BE AS SCHEDULED ON PANEL SCHEDULES. ALL POWER CONDUCTORS SHALL NOT BE SMALLER THAN #14 AWG (CU) OR #12 AWG (AL). CONTROL CIRCUIT CONDUCTORS SHALL NOT BE SMALLER THAN #18 AWG CU. CONDUCTORS SHALL BE CONTINUOUS FROM OUTLET TO OUTLET WITHOUT SPLICES EXCEPT WITHIN WIREWAY OR JUNCTION BOXES. MARK CONDUCTORS IN PANELS, FULL BOXES OR WIREWAYS AND TERMINAL STRIP TERMINALS FOR IDENTIFICATION OF CIRCUITS. CONDUCTORS SHALL BE JOINED USING COMPRESSION SPLICES, EXCEPT THAT CONDUCTORS #10 AND SMALLER MAY BE JOINED USING WIRE NUT TYPE CONNECTORS. CONDUCTORS SHALL BE TERMINATED USING COMPRESSION OR PRESSURE TYPE TERMINAL LUGS, OR IN PRESSURE TERMINALS. COMPRESSION SPLICES USED ON CONDUCTORS #10 AWG AND SMALLER, SHALL BE THE SELF-INSULATED TYPE; OTHER SPLICES SHALL BE INSULATED USING 3M 93+ OR #80 PLASTIC TAPE. SPLICES IN WET LOCATIONS SHALL BE INSULATED WITH ELECTRICAL TAPE AND ENCAPSULATED WITH SCOTCHCAST OR EQUAL POTTING COMPOUND.
- PROVIDE AND INSTALL JUNCTION AND FULL BOXES WHERE INDICATED AND WHERE NECESSARY TO TERMINATE, TAP OFF, OR REDIRECT MULTIPLE CONDUIT RUNS, OF SIZE INDICATED OR AS REQUIRED BY NEC. WHERE FEEDER SPLICES ARE TO BE MADE, INSTALL BOXES LARGE ENOUGH TO PROVIDE AMPLE WORK SPACE.
- LIGHTING FIXTURES: LIGHTING FIXTURES SHALL BE AS INDICATED ON THE DRAWINGS, AND SHALL BE INSTALLED COMPLETE WITH LAMPS.  
FIXTURES WITH ADJUSTMENTS AFFECTING LIGHT DISTRIBUTION SHALL BE SET TO PROVIDE THE REQUIRED LIGHT PATTERNS PRIOR TO THE FINAL DEMONSTRATION TEST.
- TESTS: AFTER EACH SYSTEM HAS BEEN COMPLETED, A FUNCTIONAL TEST SHALL BE PERFORMED TO DEMONSTRATE THAT THE SYSTEM OPERATES IN ACCORDANCE WITH THE REQUIREMENTS OF THE DRAWINGS. THE TEST SHALL BE PERFORMED BY THE CONTRACTOR IN THE PRESENCE OF THE OWNER OR HIS REPRESENTATIVE.
- TERMINALS: ALL ELECTRICAL EQUIPMENT FURNISHED ON THIS PROJECT IS TO HAVE TERMINALS RATED FOR 15" C. OPERATION.

## SYMBOL LEGEND

- ⊕ INDICATES TYPICAL QUAD 110 VOLT RECEPTACLE
- ⊕ INDICATES TYPICAL DUPLEX 110 VOLT RECEPTACLE
- ⊕ INDICATES TYPICAL DUPLEX 110 VOLT RECEPTACLE MOUNTED 36" AFF.
- ⊕ INDICATES SPECIALTY HIGH VOLTAGE APPLIANCE RECEPTACLE
- ▭ INDICATES ELECTRICAL DISTRIBUTION PANEL
- ▼ INDICATES TYPICAL TELEPHONE OUTLET BY OTHERS
- ▼ INDICATES TYPICAL DATA OUTLET BY OTHERS

DELETED

NOTE  
EXTERIOR SIGNAGE J-BOX SHALL BE ON A 20 AMP CIRCUIT WITH NO OTHER LOADS.

NOTE  
PROVIDE ARC-FLASH HAZARD WARNING MARKING ON ALL ELECTRICAL AND MECHANICAL EQUIPMENT. LOCATE WARNING IN CLEARLY VISIBLE AREA.

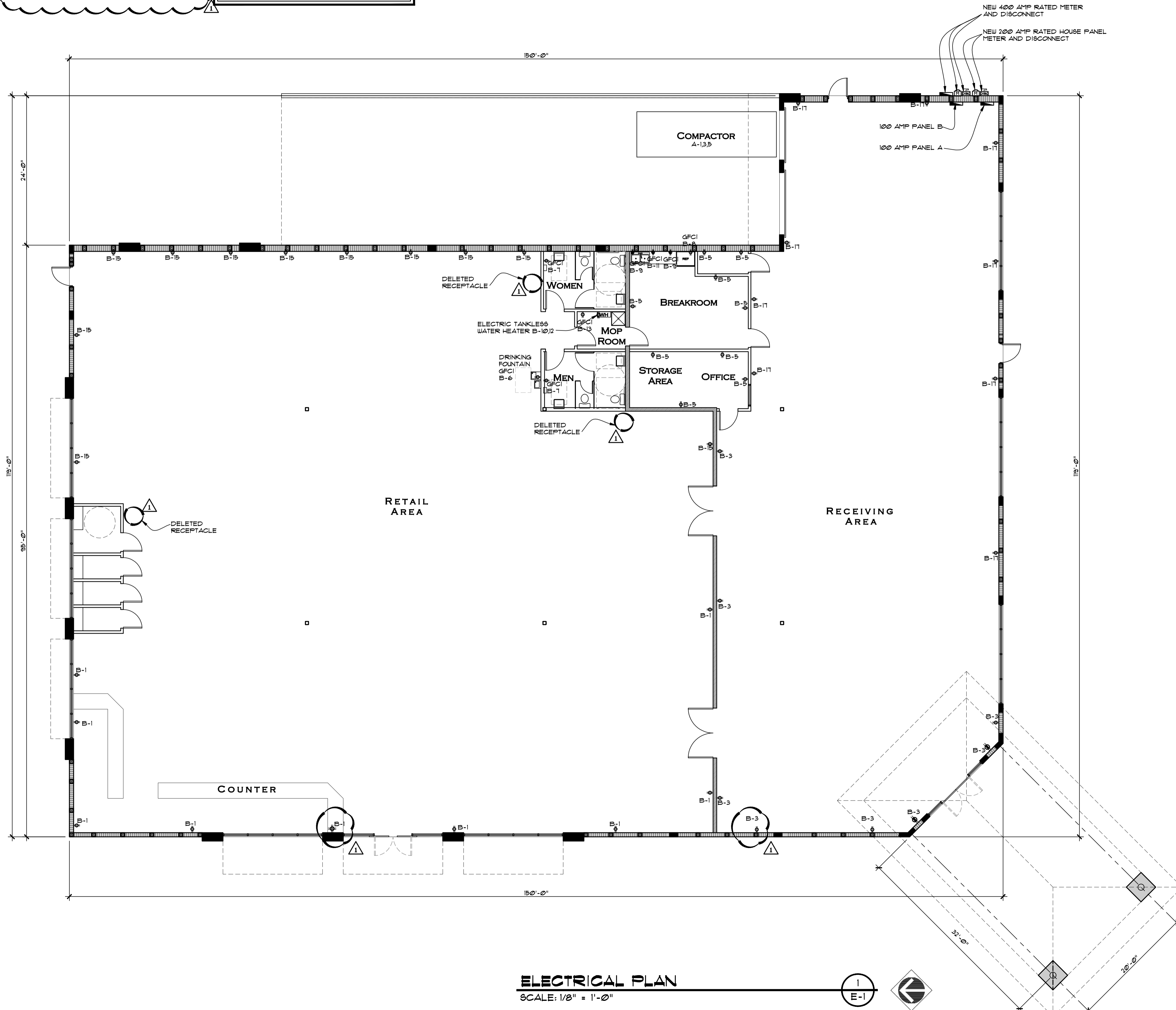

**ELECTRICAL PLAN**  
SCALE: 1/8" = 1'-0"



Revisions:	
1	9-19-16 BUILDING DEPARTMENT COMMENTS
2	
3	
4	
5	

Project Number  
**160412**

**1066 U.S. HIGHWAY 1**  
**NEW RETAIL BUILDING - GOODWILL**  
**1066 U.S. HIGHWAY 1**  
**VERO BEACH, FLORIDA**

Project Name  
**NEW RETAIL BUILDING**

**STEPHEN BRASGALLA, ARCHITECT**  
STATE OF FLORIDA  
REGISTRATION NO. AR12239  
6901 WEST BROWARD BOULEVARD  
SUITE 100  
PLANTATION, FLORIDA 33317  
TELEPHONE 954.614.3901  
TELEFAX 954.209.0900  
ARCHITECT © DESIGN23.NET

**CLIENT APPROVAL SET**  
9-19-16  
(NOT FOR CONSTRUCTION)

Drawn By: <b>RSS</b>	Checked By: <b>STB</b>
Scale: <b>SHOWN</b>	Date: <b>7-29-16</b>

Project Number  
**160412**

Sheet:  
**E - 1**