

1. IRRIGATION MAIN IS PRESSURIZED.
2. CONTRACTOR TO POTHOLE LOCATE IRRIGATION MAIN PRIOR TO CONSTRUCTION.

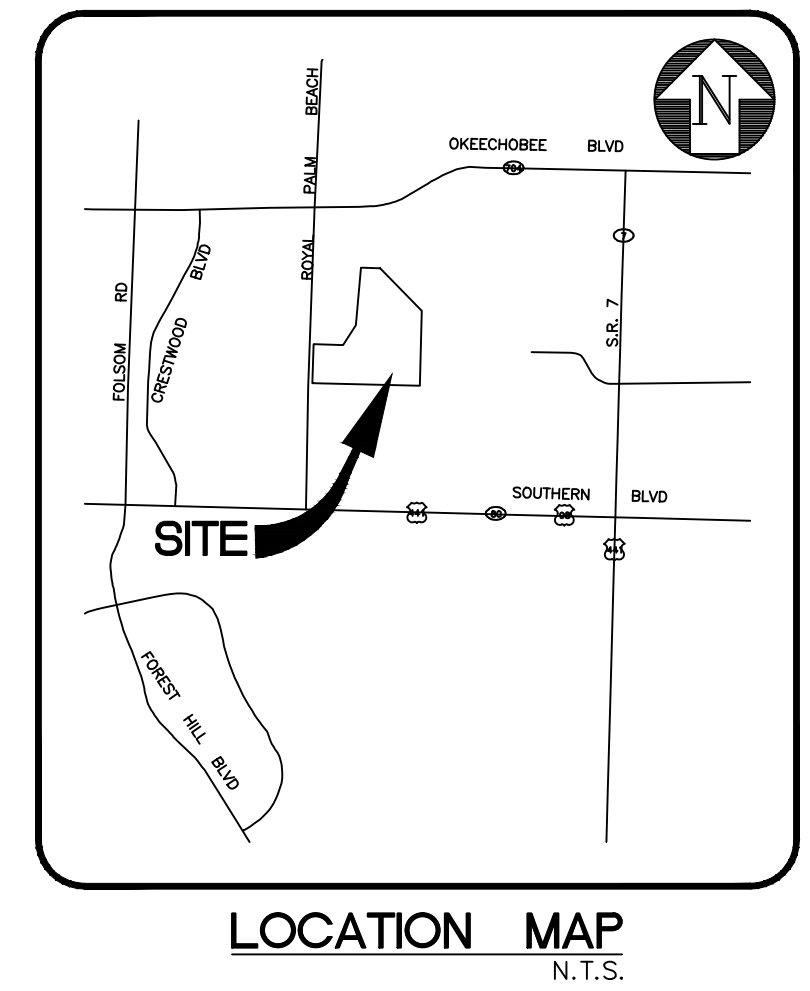
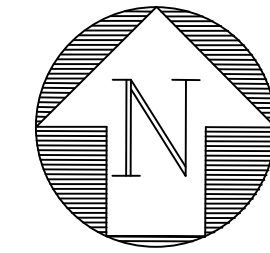

1. ALL APPLICABLE PERMITS MUST BE OBTAINED PRIOR TO COMMENCEMENT OF CONSTRUCTION.
2. ALL APPLICABLE FEES AND CHARGES MUST BE PAID PRIOR TO COMMENCEMENT OF CONSTRUCTION.
3. THE LOCATIONS OF EXISTING UTILITIES AS SHOWN ON THE APPROVED PLANS ARE TO BE VERIFIED IN THE FIELD BY THE CONTRACTOR. APPROVAL OF DEVELOPMENT PLANS BY THE VILLAGE IN NO WAY IMPLIES VERIFICATION OF THE ACCURACY OF THOSE PLANS OR FEATURES DEPICTED THEREON. ANY DISCREPANCY IN OR VARIATION FROM THE APPROVED PLANS IS TO BE BROUGHT TO THE ATTENTION OF THE CITY ENGINEER BY THE DEVELOPERS ENGINEER.
4. THE CONTRACTOR SHALL BE RESPONSIBLE AT ALL TIMES THROUGHOUT THE DURATION OF CONSTRUCTION FOR THE PROTECTION OF EXISTING AND NEWLY INSTALLED UTILITIES AND IMPROVEMENTS FROM DAMAGE, DISRUPTION OF SERVICE OR DESTRUCTION. THE CONTRACTOR SHALL BE RESPONSIBLE FOR TAKING SUCH MEASURES AS NECESSARY TO PROTECT THE HEALTH, SAFETY, AND WELFARE OF THOSE PERSONS HAVING ACCESS TO THE WORK SITE.
5. THE CONTRACTOR SHALL INFORM VILLAGE OF ROYAL PALM BEACH UTILITY DEPARTMENT AT LEAST 48 HOURS IN ADVANCE OF COMMENCING CONSTRUCTION.
6. THE CONTRACTOR SHALL BE RESPONSIBLE FOR OBTAINING LOCATIONS OF ALL UTILITIES.
7. THE CONTRACTOR SHALL INFORM THE VILLAGE UTILITY DEPARTMENT A MINIMUM OF 48 HOURS IN ADVANCE OF COMMENCEMENT OF CONNECTING TO A CITY FACILITY.
8. A PRE-CONSTRUCTION MEETING IS TO BE HELD AT THE VILLAGE AND ATTENDED BY THE CONTRACTOR, DEVELOPERS' ENGINEER AND OTHER INTERESTED PARTIES.
9. THE CONTRACTOR SHALL BE RESPONSIBLE FOR THE SCHEDULING OF AND PAYMENT FOR SUCH TESTS AS MAY BE DEEMED NECESSARY BY THE UTILITY DIRECTOR AND AS CALLED FOR IN THE PLANS AND SPECIFICATIONS.
10. CONSTRUCTION SHALL BE CARRIED OUT IN STRICT COMPLIANCE WITH THE VILLAGE OF ROYAL PALM BEACH UTILITIES STANDARDS.
11. THE CONTRACTOR SHALL MAINTAIN A CURRENT APPROVED SET OF CONSTRUCTION PLANS ON SITE. THE PLANS ARE TO BE MADE AVAILABLE TO THE UTILITY DIRECTOR OR HIS DESIGNEE UPON REQUEST.
12. ALL GRAVITY SEWER SHALL BE PVC OR EPOXY LINED DIP, CLASS 52.
13. THE DEVELOPERS' ENGINEER SHALL MAKE SUFFICIENT INSPECTIONS OF THE WORK TO ENABLE HIM TO CERTIFY THE INSTALLATION AS BEING IN CONFORMANCE WITH THE APPLICABLE STANDARDS AND SPECIFICATIONS.
14. THE UTILITY DIRECTOR OR HIS DESIGNEE WILL CARRY OUT INSPECTIONS ON THE WORKS ON A DAY TO DAY BASIS AND WILL INFORM THE CONTRACTOR WHEN TO BACKFILL AND WILL WITNESS PRESSURE, BACTERIOLOGICAL, INFILTRATION/EXFILTRATION TESTS.
15. THE FOLLOWING DOCUMENTS ARE TO BE ON FILE AT THE UTILITY DEPARTMENT PRIOR TO THE CONNECTION OF THE FIRST WATER METER:

- A. FINAL APPROVAL BY THE VILLAGE OF ROYAL PALM BEACH
- B. LETTER OF ACCEPTANCE FROM PALM BEACH COUNTY HEALTH DEPT.
- C. CERTIFICATION BY ENGINEER OF RECORD.
- D. LETTER FROM DEVELOPER STATING ACTUAL COST OF CONSTRUCTION.
- E. LETTER FROM DEVELOPER STATING THAT NO LIENS HAVE BEEN FILED RELATING TO INSTALLATION OF UTILITIES.
- F. BILL OF SALE ABSOLUTE FOR SYSTEM.
- G. GRANT OF EASEMENT OR LETTER STATING EASEMENTS ARE ON PLAT.
- H. AS-BUILT MYLAR AND FOUR SEALED COPIES OF AS-BUILTS CERTIFIED BY A LAND SURVEYOR REGISTERED IN THE STATE OF FLORIDA.
- I. MEMO FROM VILLAGE ENGINEER STATING THAT ALL FEES DUE TO DATE HAVE BEEN PAID.

16. NO DEVIATION FROM APPROVED PLANS SHALL BE PERMITTED WITHOUT THE WRITTEN CONSENT OF THE UTILITY DIRECTOR.

REVISIONS					
N0.	DATE	REMARKS			BY

© COPYRIGHT 2016 BY
ENGINEUTY GROUP, INC. THIS
DRAWING IS PROVIDED FOR
INFORMATIONAL PURPOSES ONLY,
UNLESS SIGNED AND SEALED BY
A LICENSED PROFESSIONAL
ENGINEER REPRESENTING
ENGINEUTY GROUP, INC.

DAM SWANEY, P.E.
FLORIDA LICENSE
No. 72235

ROYAL PALM BEACH AMPHITHEATRE

ROYAL PALM BEACH COMMONS PARK

ENGINEERING PLAN



PH (561)655-1151 • FAX (561)832-9390 •
WWW.ENGINEITYGROUP.COM CERTIFICATE OF AUTHORIZATION #7095

1 2 3 4 5 6 7 8 9 10 11 12 13 14 15 16 17 18 19 20 21 22 23 24 25 26 27 28 29 30 31 32 33 34 35 36 37 38 39 40 41 42 43 44 45 46 47 48 49 50 51 52 53 54 55 56 57 58 59 60 61 62 63 64 65 66 67 68 69 70 71 72 73 74 75 76 77 78 79 80 81 82 83 84 85 86 87 88 89 90 91 92 93 94 95 96 97 98 99 100 101 102 103 104 105 106 107 108 109 110 111 112 113 114 115 116 117 118 119 120 121 122 123 124 125 126 127 128 129 130 131 132 133 134 135 136 137 138 139 140 141 142 143 144 145 146 147 148 149 150 151 152 153 154 155 156 157 158 159 160 161 162 163 164 165 166 167 168 169 170 171 172 173 174 175 176 177 178 179 180 181 182 183 184 185 186 187 188 189 190 191 192 193 194 195 196 197 198 199 200 201 202 203 204 205 206 207 208 209 210 211 212 213 214 215 216 217 218 219 220 221 222 223 224 225 226 227 228 229 230 231 232 233 234 235 236 237 238 239 240 241 242 243 244 245 246 247 248 249 250 251 252 253 254 255 256 257 258 259 260 261 262 263 264 265 266 267 268 269 270 271 272 273 274 275 276 277 278 279 280 281 282 283 284 285 286 287 288 289 290 291 292 293 294 295 296 297 298 299 300 301 302 303 304 305 306 307 308 309 310 311 312 313 314 315 316 317 318 319 320 321 322 323 324 325 326 327 328 329 330 331 332 333 334 335 336 337 338 339 340 341 342 343 344 345 346 347 348 349 350 351 352 353 354 355 356 357 358 359 360 361 362 363 364 365 366 367 368 369 370 371 372 373 374 375 376 377 378 379 380 381 382 383 384 385 386 387 388 389 390 391 392 393 394 395 396 397 398 399 400 401 402 403 404 405 406 407 408 409 410 411 412 413 414 415 416 417 418 419 420 421 422 423 424 425 426 427 428 429 430 431 432 433 434 435 436 437 438 439 440 441 442 443 444 445 446 447 448 449 450 451 452 453 454 455 456 457 458 459 460 461 462 463 464 465 466 467 468 469 470 471 472 473 474 475 476 477 478 479 480 481 482 483 484 485 486 487 488 489 490 491 492 493 494 495 496 497 498 499 500 501 502 503 504 505 506 507 508 509 510 511 512 513 514 515 516 517 518 519 520 521 522 523 524	DATE	06/17/2016	
	1 2 3 4 5 6 7 8 9 10 11 12 13 14 15 16 17 18 19 20 21 22 23 24 25 26 27 28 29 30 31 32 33 34 35 36 37 38 39 40 41 42 43 44 45 46 47 48 49 50 51 52 53 54 55 56 57 58 59 60 61 62 63 64 65 66 67 68 69 70 71 72 73 74 75 76 77 78 79 80 81 82 83 84 85 86 87 88 89 90 91 92 93 94 95 96 97 98 99 100 101 102 103 104 105 106 107 108 109 110 111 112 113 114 115 116 117 118 119 120 121 122 123 124 125 126 127 128 129 130 131 132 133 134 135 136 137 138 139 140 141 142 143 144 145 146 147 148 149 150 151 152 153 154 155 156 157 158 159 160 161 162 163 164 165 166 167 168 169 170 171 172 173 174 175 176 177 178 179 180 181 182 183 184 185 186 187 188 189 190 191 192 193 194 195 196 197 198 199 200 201 202 203 204 205 206 207 208 209 210 211 212 213 214 215 216 217 218 219 220 221 222 223 224 225 226 227 228 229 230 231 232 233 234 235 236 237 238 239 240 241 242 243 244 245 246 247 248 249 250 251 252 253 254 255 256 257 258 259 260 261 262 263 264 265 266 267 268 269 270 271 272 273 274 275 276 277 278 279 280 281 282 283 284 285 286 287 288 289 290 291 292 293 294 295 296 297 298 299 300 301 302 303 304 305 306 307 308 309 310 311 312 313 314 315 316 317 318 319 320 321 322 323 324 325 326 327 328 329 330 331 332 333 334 335 336 337 338 339 340 341 342 343 344 345 346 347 348 349 350 351 352 353 354 355 356 357 358 359 360 361 362 363 364 365 366 367 368 369 370 371 372 373 374 375 376 377 378 379 380 381 382 383 384 385 386 387 388 389 390 391 392 393 394 395 396 397 398 399 400 401 402 403 404 405 406 407 408 409 410 411 412 413 414 415 416 417 418 419 420 421 422 423 424 425 426 427 428 429 430 431 432 433 434 435 436 437 438 439 440 441 442 443 444 445 446 447 448 449 450 451 452 453 454 455 456 457 458 459 460 461 462 463 464 465 466 467 468 469 470 471 472 473 474 475 476 477 478 479 480 481 482 483 484 485 486 487 488 489 490 491 492 493 494 495 496 497 498 499 500 501 502 503 504 505 506 507 508 509 510 511 512 513 514 515 516 517 518 519 520 521 522 523 524	DRAWN	ETLB
		PROJECT ENGINEER	ACS
		PROJECT MANAGER	ACS
	CHECKED		

JOB NO.
16035.01



Know what's **below**.
Call before you dig.

1. ALL ELEVATIONS ARE REFERENCED TO THE 1929 NATIONAL GEODETIC VERTICAL DATUM (NGVD)
2. BENCHMARKS: "AUD PBC BM"
3. ALL AREAS DISTURBED BY CONSTRUCTION SHALL BE RESTORED TO THEIR ORIGINAL CONDITION.
4. TOPOGRAPHIC SURVEY PERFORMED BY ENGENUITY GROUP. ON xxx.

ELEV.
N
S
E
W
RCP
LF
 TBM





— DRN —



CONCRETE SIDEWALK

DRAINAGE FLOW DIRECTION