

N. E. 10th STREET

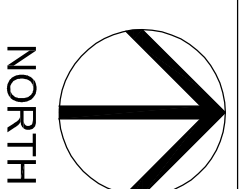

SCALE 1" = 20'-0"  
SECTION 31, TOWNSHIP 48S, RANGE 43E

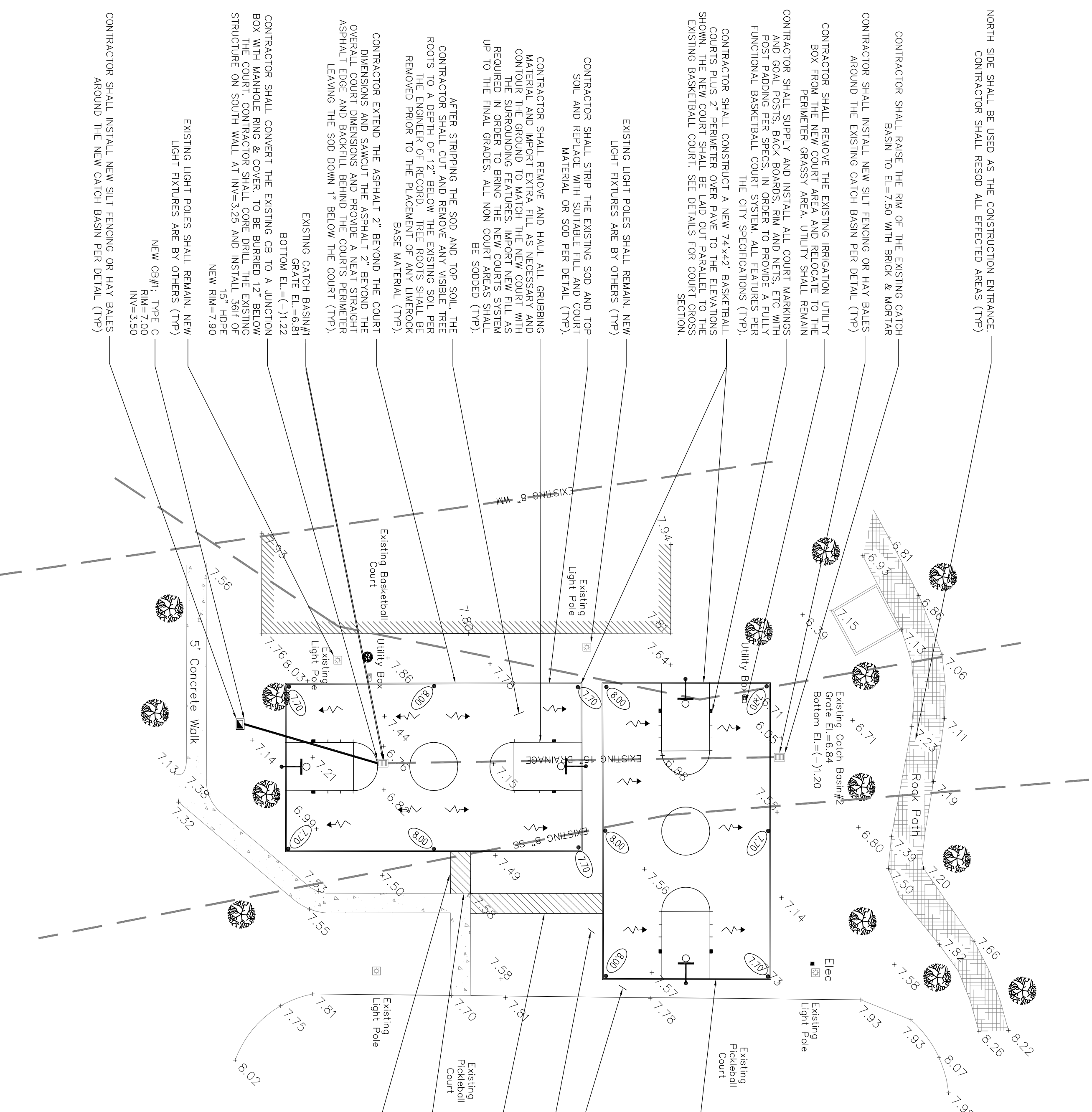

**GRADING AND DRAINAGE NOTES:**

PROJECT CONSOLE: STIRRING THE EXISTING SOIL REMOVE AND Haul, REPAIRING STRUCTURAL FILL AND UNDERROCK BASE AND ASPHALT, INSTALLING NEW SOIL AROUND PERIMETER AND DISTURBED AREAS AND PROVIDING SITE AMENITIES AS SHOWN.

CONTRACTOR SHALL PROVIDE LABOR AND MATERIAL, ETC. IN ORDER TO FINISH A COMPLETE WORKING SYSTEM BASED ON THE LAYOUT SHOWN ON THESE PLANS.

LANDSCAPE AREAS SHALL BE GRADED TO DRAIN TO THE CATCH BASIN INLETS. FIELD ADJUST ELEVATIONS SHOWN ARE THE GRADES AFTER THE SOO HAS BEEN PLACED.

CONTRACTOR SHALL PROVIDE A MAXIMUM SLOPE OF 3:1 (H:V) FOR ALL SLOPES SIDE SLOPES AND A MAXIMUM SLOPE OF 4:1 (H:V) FOR PERIMETER TRANSITIONS IN GRADES.

ALL INSPECTIONS AND CERTIFICATION REQUIREMENTS SHALL FOLLOW THE CITY'S STANDARDS AND UDC'S MINIMUM ENGINEERING AND CONSTRUCTION STANDARDS.

AFTER THE GRADING AND GRUBBING OPERATION, THE CONTRACTOR SHALL CLEAR THE NEW AREAS OF ALL STUMP REMAINS AND BRUSH AND STUMP REMAINS SHALL BE REMOVED AND DISPOSED OF OFF-SITE. THE CONTRACTOR SHALL COMPACT THE SOIL WITH VIBRATORY ROLLER. AFTER ROLLING, ALL DEPRESSIONS AND FIELD AREAS IS ROLLED AND GRADED UNTIL A SMOOTH, EVEN SURFACE IS ACHIEVED AT THE REQUIRED GRADES BEFORE UNDERROCK BASE AND ASPHALT INSTALLATION.

THE CONTRACTOR IS RESPONSIBLE FOR THE FOR THE REPAIR AND MAINTENANCE OF THE IRRIGATION AND LAWN INCLUDING FILING AND RESPONDING ANY SINKED OR ERODED AREAS, BARE SPOTS AND DEAD SOO.

CONTRACTOR SHALL BE RESPONSIBLE FOR ESTABLISHING AND MAINTAINING THE SOO UNTIL ACCEPTANCE BY THE OWNER OR OWNER'S REPRESENTATIVE.

LASER GRADE SUB-GRADE AND COMPACT TO 98% DENSITY PER AASHTO T-180

SUPPLY AND INSTALL 6" UNDERROCK BASE PER DETAILS(S) AND COMPACT TO 98% DENSITY PER AASHTO T-180

PRIME ROCK BASE WITH AEP-225

SUPPLY AND INSTALL MINIMUM 1" OF IRON TYPE S-3 ASPHALT PER FOOT SPECIFICATIONS PER DETAILS(S)

FINISH AND INSTALL SPALDING BRAND, MODEL 884616 60" GLASS IN-GROUND, ADJUSTABLE BASKETBALL SYSTEM FOR 6" TO 8" RIM HEIGHTS.

FIRST ASPHALT AND PATCH FOR PONDING GREATER THAN 1/2"

CONTRACTOR SHALL RAISE THE RIM OF THE EXISTING CATCH BASIN TO ELV.=7.50 WITH BRICK OR HAY BALES AROUND THE EXISTING CATCH BASIN PER DETAIL (TYP)

CONTRACTOR SHALL REMOVE THE EXISTING IRRIGATION UTILITY BOX FROM PERIMETER GRASSY AREA AND RELOCATE. REPAIR CONTRACTOR SHALL SUPPLY AND INSTALL ALL COURT MARKINGS AND GOAL POSTS, BACK BOARDS, RIM AND NETS, ETC WITH POST PADDING PER SPEC. IN ORDER TO PROVIDE A FULLY FUNCTIONAL BASKETBALL COURT SYSTEM. PERIMETER (TYP)

CONTRACTOR SHALL CONSTRUCT A NEW 24'x40' BASKETBALL COURT PLUS 2" PERIMETER OVER PAVE TO THE ELEVATIONS SHOWN. THE NEW COURT SHALL BE LAID OUT PARALLEL TO THE EXISTING BASKETBALL COURT. SEE DETAILS FOR COURT CROSS SECTION.

EXISTING LIGHT POLES SHALL REMAIN. NEW LIGHT FIXTURES ARE BY OTHERS (TYP)

CONTRACTOR SHALL STAMP THE EXISTING SOO AND TOP SOIL AND NEW MATERIAL OR SOO PER DETAIL (TYP)

CONTRACTOR SHALL REMOVE AND HAUL ALL GRUBBING AND SOO TO MATCH THE NEW COURT WITH THE SURROUNDING FEATURES. IMPORT NEW FILL AS REQUIRED IN ORDER TO BRING THE NEW COURTS SYSTEM UP TO THE FINAL GRADES. ALL NON GRASSY AREAS SHALL BE SOOED (TYP)

AFTER STIRRING THE SOO AND TOP SOIL, THE CONTRACTOR SHALL SOO AND BREAK AND REPAIR THE ROOTS TO A DEPTH OF 12" BELOW THE EXISTING SOIL PER THE ENGINEER OF RECORD. TREE ROOTS SHALL BE REMOVED PRIOR TO THE PLACEMENT OF BRICK MATERIAL (TYP)

CONTRACTOR EXTEND THE ASPHALT 2' BEYOND THE COURT PERIMETER TO PROVIDE A NEAT STRAIGHT ASPHALT EDGE AND BACKFILL BEHIND THE COURT'S PERIMETER LEAVING THE SOO DOWN 1" BELOW THE COURT (TYP)

EXISTING CATCH BASIN#1  
GRATE ELV.=6.81  
BOTTOM ELV.=(-)1.22

CONTRACTOR SHALL CONVERT THE EXISTING CB TO A JUNCTION BOX WITH MANHOLE RING & COVER. TO BE BURIED 12" BELOW THE EXISTING GRASSY AREA. THE STRUCTURE SHALL BE 15'-7" HIGH OF STRUCTURE ON SOUTH WALL AT INV.=3.25 AND INSTALL 56" OF NEW RIM=7.90

EXISTING LIGHT POLES SHALL REMAIN. NEW LIGHT FIXTURES ARE BY OTHERS (TYP)

NEW GRP#1: TYPE C  
RIM=7.00  
INV.=3.50

CONTRACTOR SHALL INSTALL NEW SILT FENCING OR HAY BALES AROUND THE NEW CATCH BASIN PER DETAIL (TYP)

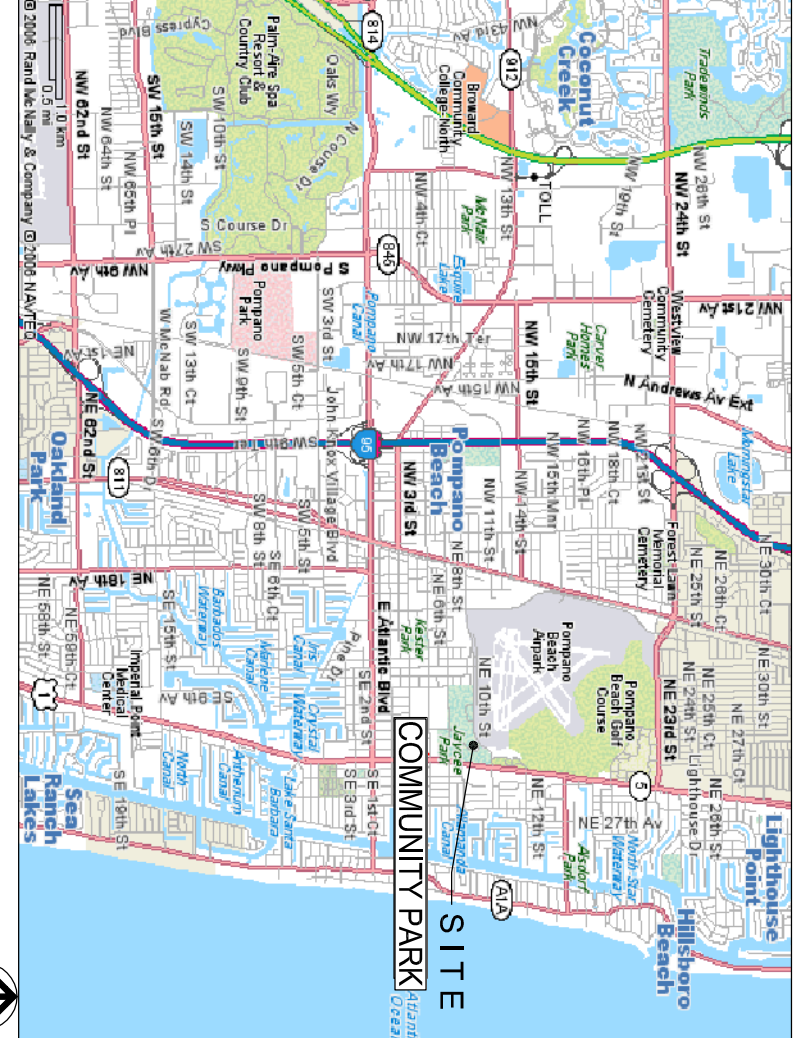

LEGEND:

- EXISTING TREE
- EXISTING WOOD LIGHT POLE
- EXISTING CLEAN OUT
- EXISTING ANCHOR
- EXISTING WATER METER
- EXISTING ELEVATION
- PROPOSED ELEVATION
- EXISTING FIRE HYDRANT
- EXISTING MANHOLE
- EXISTING SIGN
- EXISTING POWER POLE
- EXISTING CATCH BASIN
- EXISTING UTILITY MAIN
- EXISTING WATER VALVE
- DIRECTION OF SURFACE DRAINAGE

LEGAL DESCRIPTION:

A PORTION OF PARCEL 7B OF "POMPANO BEACH AIR PARK AND RECREATION FACILITIES PLAT" ACCORDING TO THE PLAT THEREOF, AS RECORDED IN PLAT BOOK 149, PAGE 20, OF THE PUBLIC RECORDS OF BROWARD COUNTY, FLORIDA.

SURVEYORS NOTES:

FLDK.A FLOOD DESIGNATION EFFECTIVE 8-18-2015  
FLOOD PANEL: 120100236H  
NEW ELEVATION: 78 ELEVATION: N/A  
ELEVATIONS SHOWN HEREON ARE REFERENCED TO THE NATIONAL GEODETIC VERTICAL DATUM (NGVD) OF 1929.

BENCHMARK REFERENCE: ELEVATIONS SHOWN HEREON WERE OBTAINED BY GPS OBSERVATION. NO ATTEMPT WAS MADE TO LOCATE ANY UNDERGROUND UTILITIES EXCEPT AS SHOWN.

NO ATTEMPT WAS MADE TO DETERMINE ANY METADANS.

THIS SURVEY WAS PREPARED WITHOUT BENEFIT OF A TITLE COMMITMENT.

ALL RECORDS SHOWN HEREON ARE REFERENCED TO THE PUBLIC RECORDS OF BROWARD COUNTY, FLORIDA.

THE SPECIFIC PURPOSE OF THIS SURVEY IS TO SHOW THE EXISTING HORIZONTAL AND VERTICAL FOR REFERENCE PURPOSES ONLY. THIS IS NOT A BOUNDARY SURVEY AND NO FIELD WORK WAS PERFORMED TO VERIFY EXISTING BOUNDARY OR RIGHT-OF-WAY INFORMATION.

SITE DATA:

CITY: POMPANO BEACH  
ZONING: CF (COMMUNITY FACILITIES)  
BROWARD COUNTY 100 YEAR FLOOD ELEVATION: 4.0 (NAVD)  
SEASONAL HIGH WATER TABLE ELEVATION: UNDER TOTAL INFLUENCE: 1.5 (NAVD)  
WATER SYSTEM AUTHORITY: CITY OF POMPANO BEACH  
WASTEWATER SYSTEM AUTHORITY: CITY OF POMPANO BEACH

PROJECT DATA:

THIS PROJECT INVOLVES THE CONSTRUCTION OF TWO NEW YOUTH SIZE BASKETBALL COURTS WITH TOTAL AREA OF 3108 SQ. FT. EACH - TOTAL=6216<sup>2</sup>

COURT COLOR SHALL BE OF APPROVED COATING MATERIAL FOR BASKETBALL COURTS. COLOR OF OWNER'S CHOICE. PROVIDE SHOP DRAWINGS AND SPECIFICATIONS.

ALL BASKETBALL FEATURES SHALL BE SUPPLIED BY THE CONTRACTOR SUCH AS GOAL POSTS, BACK BOARDS, RIMS, NETS, ETC. PROVIDE SHOP DRAWINGS FOR EACH COMPONENT.

LASER GRADE SUB-GRADE AND COMPACT TO 98% DENSITY PER AASHTO T-180

SUPPLY AND INSTALL 6" UNDERROCK BASE PER DETAILS(S) AND COMPACT TO 98% DENSITY PER AASHTO T-180

PRIME ROCK BASE WITH AEP-225

SUPPLY AND INSTALL MINIMUM 1" OF IRON TYPE S-3 ASPHALT PER FOOT SPECIFICATIONS PER DETAILS(S)

FINISH AND INSTALL SPALDING BRAND, MODEL 884616 60" GLASS IN-GROUND, ADJUSTABLE BASKETBALL SYSTEM FOR 6" TO 8" RIM HEIGHTS.

FLOOD TEST ASPHALT AND PATCH FOR PONDING GREATER THAN 1/2"

SUPPLY AND INSTALL TWO COATS OF LAYKOD INSUR-ACRYLIC SURFACES

SUPPLY AND INSTALL TWO COATS OF TROPICCAT ATHLETIC SURFACE COATINGS

SUPPLY AND INSTALL SEAL-4-LINE BRAND LINE MARKING COATING

SUPPLY AND INSTALL NOVATEX BRAND PAINT LINES AS SHOWN ON PLANS

SWPP NOTES:

SILT SCREENS, HAY BALES OR OTHER SEDIMENT CONTROL MEASURES SHALL BE UTILIZED DURING CONSTRUCTION TO PREVENT EROSION AND SEDIMENTATION. ALL AREAS SHALL BE STABILIZED AND SOOED IMMEDIATELY AFTER CONSTRUCTION TO PREVENT EROSION INTO SAND AREAS.

CONTRACTOR SHALL INSTALL A STORM SILT FENCE AROUND ALL WORK AREAS.

CONTRACTOR SHALL PROTECT ALL EXISTING DRAINAGE INLETS FROM ACCEPTING SILTY/SANDY RUNOFF BY INSTALLING A FILTER MECHANISM OVER THE INLET GRATES.

CONTRACTOR SHALL PROVIDE DAILY CLEAN UP OF ALL SEDIMENT AND PROVIDE DAILY DUST CONTROL MEASURES.

**MDC**  
MINSON DESIGN AND CONSULTING, INC.  
PO BOX 771058  
CORAL SPRINGS FL 33077  
PHONE: 954-340-5291  
AUTH. NO. 9327 & 7958

**PAVING, GRADING AND DRAINAGE PLAN**  
**STORMWATER POLLUTION PREVENTION PLAN**

**POMPANO BEACH COMMUNITY PARK**  
**YOUTH BASKETBALL COURT INSTALLATION**  
**FOR**  
**THE CITY OF POMPANO BEACH**

PROJECT ADDRESS:  
IN BETWEEN NE 10 STREET AND NE 18 STREET, WEST OF FEDERAL HWY  
POMPANO BEACH, FL

Scale: 1" = 20'  
Sheet No. 4 of 6  
Date: 07/19/2016  
Appr. by: [Signature]