

SCALE 1" = 20'-0"  
SECTION 31 TOWNSHIP 48S RANGE 43E

# N. E. 10th STREET



### LEGEND:

- EXISTING TREE
- EXISTING FIRE HYDRANT
- EXISTING WOOD LIGHT POLE
- EXISTING MANHOLE
- EXISTING CLEAN OUT
- EXISTING SIGN
- EXISTING ANCHOR
- EXISTING POWER POLE
- EXISTING WATER METER
- EXISTING CATCH BASIN
- EXISTING ELEVATION
- DIRECTION OF SURFACE DRAINAGE
- PROPOSED ELEVATION
- EXISTING UTILITY MAIN
- EXISTING WATER VALVE

### LEGAL DESCRIPTION:

A PORTION OF PARCEL 7B OF 'POMPAÑO BEACH AIR PARK AND RECREATION FACILITIES PLAT' ACCORDING TO THE PLAT THEREOF, AS RECORDED IN PLAT BOOK 149, PAGE 20, OF THE PUBLIC RECORDS OF BROWARD COUNTY, FLORIDA.

### SURVEYORS NOTES:

F.E.L.A. FLOOD DESIGNATION EFFECTIVE 8-18-2015  
FLOOD PANEL: 120102376  
NEW 1/4 INCH 76 ELEVATION N/A  
ELEVATIONS SHOWN HEREON ARE REFERENCED TO THE NATIONAL GEODETIC VERTICAL DATUM (NGVD) OF 1929.  
BENCHMARK REFERENCE: ELEVATIONS SHOWN HEREON WERE OBTAINED BY GPS OBSERVATION. NO ATTEMPT WAS MADE TO LOCATE ANY UNDERGROUND UTILITIES EXCEPT AS SHOWN.  
NO ATTEMPT WAS MADE TO DETERMINE ANY METADANS.  
THIS SURVEY WAS PREPARED WITHOUT BENEFIT OF A TITLE COMMITMENT.  
ALL RECORDS SHOWN HEREON ARE REFERENCED TO THE PUBLIC RECORDS OF BROWARD COUNTY, FLORIDA.  
THE SPECIFIC PURPOSE OF THIS SURVEY IS TO SHOW THE EXISTING HORIZONTAL AND VERTICAL FOR REFERENCE PURPOSES ONLY. THIS IS NOT A BOUNDARY SURVEY AND NO FIELD WORK WAS PERFORMED TO VERIFY EXISTING BOUNDARY OR RIGHT-OF-WAY INFORMATION.

### SITE DATA:

CITY: POMPAÑO BEACH  
ZONING: OF (COMMUNITY FACILITIES)  
BROWARD COUNTY 100 YEAR FLOOD ELEVATION: 4.0 (NAVD)  
SEASONAL HIGH WATER TABLE ELEVATION: UNDER TOTAL INFLUENCE: 1.5 (NAVD)  
WATER SYSTEM AUTHORITY: CITY OF POMPAÑO BEACH  
WASTEWATER SYSTEM AUTHORITY: CITY OF POMPAÑO BEACH

### PROJECT DATA:

THIS PROJECT INVOLVES THE CONSTRUCTION OF TWO NEW YOUTH SIZE BASKETBALL COURTS WITH TOTAL AREA OF 3106 SQ. FT. EACH - TOTAL 6212 SF.  
CONTRACTOR SHALL BE OF APPROVED COATING MATERIAL FOR BASKETBALL COURTS. COLOR OF OWNER'S CHOICE. PROVIDE SHOP DRAWINGS AND SPECIFICATIONS.  
ALL BASKETBALL FEATURES SHALL BE SUPPLIED BY THE CONTRACTOR SUCH AS GOAL POSTS, BACK BOARDS, RIMS, NETS, ETC. PROVIDE SHOP DRAWINGS FOR EACH COMPONENT.  
LASER GRADE SUB-GRADE AND COMPACT TO 98% DENSITY PER AASHTO T-180  
SUPPLY AND INSTALL 6" LIMEROCK BASE PER DETAILS(S) AND COMPACT TO 98% DENSITY PER AASHTO T-180  
PRIME ROCK BASE WITH AEP-225

### SWPP NOTES:

SILT SCREENS, HAY BALES OR OTHER SEDIMENT CONTROL MEASURES SHALL BE UTILIZED DURING CONSTRUCTION OF THIS PROJECT TO PREVENT EROSION AND SEDIMENTATION FROM THE PROJECT AREA. ALL AREAS SHALL BE STABILIZED IMMEDIATELY AFTER CONSTRUCTION TO PREVENT EROSION INTO SLOD AREAS.  
CONTRACTOR SHALL INSTALL A STYREX SILT FENCE AROUND ALL WORK AREAS.  
CONTRACTOR SHALL PROTECT ALL EXISTING DRAINAGE INLETS FROM ACCEPTING SILTY/SANDY RUNOFF BY INSTALLING A FILTER MECHANISM OVER THE INLET GRATES.  
CONTRACTOR SHALL PROVIDE DAILY CLEAN UP OF ALL SEDIMENT AND PROVIDE DAILY DUST CONTROL MEASURES.

### SWPP NOTES:

LASER GRADE SUB-GRADE AND COMPACT TO 98% DENSITY PER AASHTO T-180  
SUPPLY AND INSTALL 6" LIMEROCK BASE PER DETAILS(S) AND COMPACT TO 98% DENSITY PER AASHTO T-180  
PRIME ROCK BASE WITH AEP-225  
SUPPLY AND INSTALL MINIMUM 1" OF IRON TYP E-3 ASPHALT PER FOOT SPECIFICATIONS PER DETAILS(S)  
AFTER THE GRADING AND GRUBBING OPERATION, THE CONTRACTOR SHALL CLEAR THE NEW AREAS OF ANY AND ALL ROCKS AND DEBRIS.  
INSTALL THE NEW SOIL IN A UNIFORM SLOPE FOR THE GRADDES ON THE PLAN. CONTRACTOR SHALL COMPACT THE SOIL WITH VIBRATORY ROLLER. AFTER ROLLING, ALL DEPRESSIONS AND FIELD AREAS IS ROLLED AND GRADDED UNTIL A SMOOTH, EVEN SURFACE IS ACHIEVED AT THE REQUIRED GRADDES BEFORE LIMEROCK BASE AND ASPHALT INSTALLATION.  
THE CONTRACTOR IS RESPONSIBLE FOR THE FOR THE REPAIR AND MAINTENANCE OF THE IRRIGATION AND LAWN INCLUDING FLUSHING AND RESPONDING ANY SINKERS OR ERODED AREAS, BARE SPOTS AND DEAD SOG.  
CONTRACTOR SHALL BE RESPONSIBLE FOR ESTABLISHING AND MAINTAINING THE SOG UNTIL ACCEPTANCE BY THE OWNER OR OWNER'S REPRESENTATIVE.

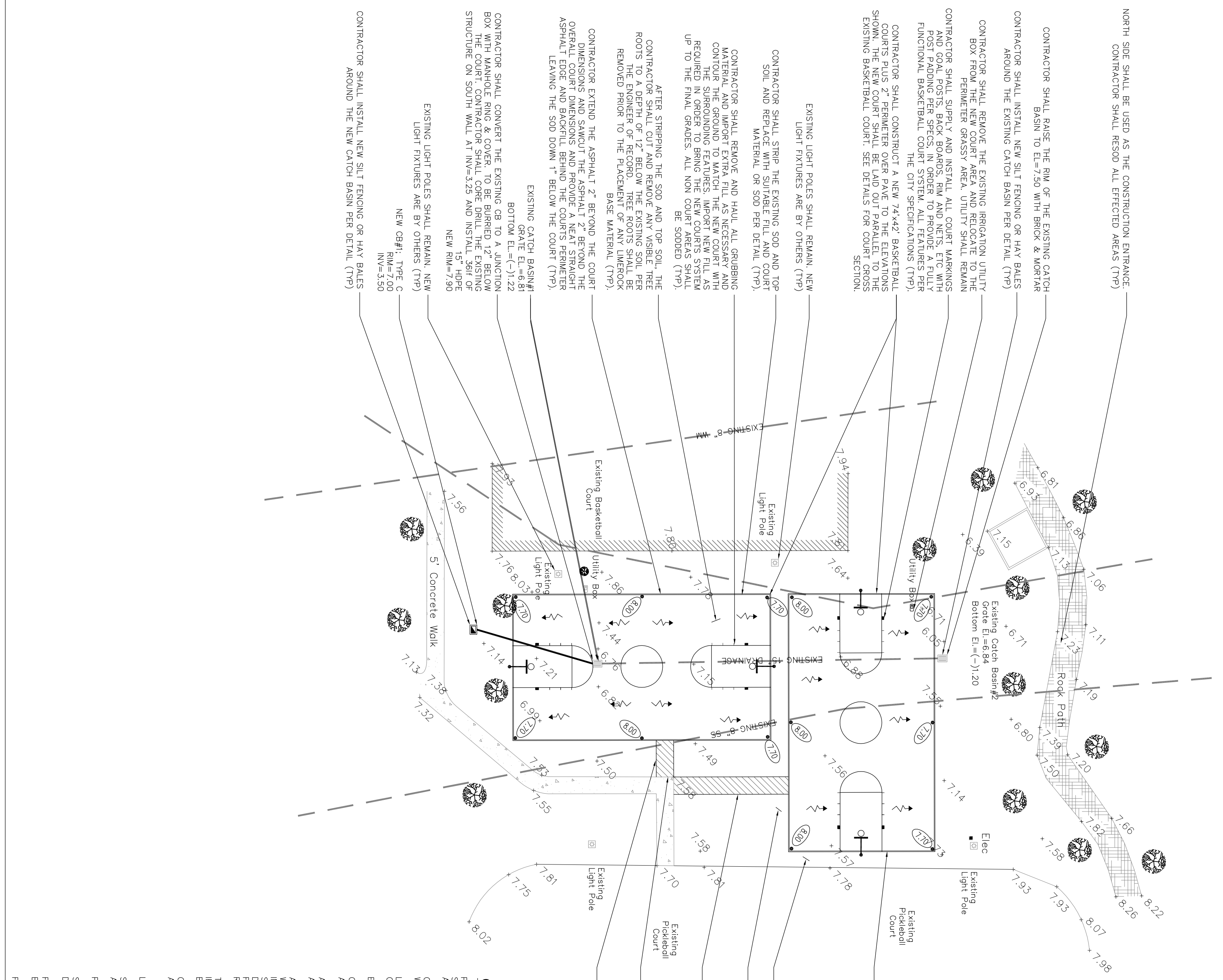

**GRADING AND DRAINAGE NOTES:**  
PROJECT CONSOLE OF STRIPPING THE EXISTING SOG, REMOVE AND Haul, REPAIRING STRUCTURAL FILL AND LIMEROCK BASE, AND ASPHALT, INSTALLING NEW SOG AROUND PERIMETER AND DISTURBED AREAS AND PROVIDING SITE AMENITIES AS SHOWN.  
CONTRACTOR SHALL PROVIDE LABOR AND MATERIAL, ETC. IN ORDER TO FINISH A COMPLETE WORKING SYSTEM BASED ON THE LAYOUT SHOWN ON THESE PLANS.  
LANDSCAPED AREAS SHALL BE GRADDED TO DRAIN TO THE CATCH BASIN INLETS. FIELD ADJUST ELEVATIONS SHOWN ARE THE GRADDES AFTER THE SOG HAS BEEN PLACED.  
CONTRACTOR SHALL PROVIDE A MAXIMUM SLOPE OF 3:1 (H:V) FOR ALL SWALES SIDE SLOPES AND A MAXIMUM SLOPE OF 4:1 (H:V) FOR PERIMETER TRANSMISSIONS IN GRASSES.  
ALL INSPECTIONS AND CERTIFICATION REQUIREMENTS SHALL FOLLOW THE CITY'S STANDARDS AND UDC'S MINIMUM ENGINEERING AND CONSTRUCTION STANDARDS.

AFTER THE GRADING AND GRUBBING OPERATION, THE CONTRACTOR SHALL CLEAR THE NEW AREAS OF ANY AND ALL ROCKS AND DEBRIS.  
INSTALL THE NEW SOIL IN A UNIFORM SLOPE FOR THE GRADDES ON THE PLAN. CONTRACTOR SHALL COMPACT THE SOIL WITH VIBRATORY ROLLER. AFTER ROLLING, ALL DEPRESSIONS AND FIELD AREAS IS ROLLED AND GRADDED UNTIL A SMOOTH, EVEN SURFACE IS ACHIEVED AT THE REQUIRED GRADDES BEFORE LIMEROCK BASE AND ASPHALT INSTALLATION.  
THE CONTRACTOR IS RESPONSIBLE FOR THE FOR THE REPAIR AND MAINTENANCE OF THE IRRIGATION AND LAWN INCLUDING FLUSHING AND RESPONDING ANY SINKERS OR ERODED AREAS, BARE SPOTS AND DEAD SOG.  
CONTRACTOR SHALL BE RESPONSIBLE FOR ESTABLISHING AND MAINTAINING THE SOG UNTIL ACCEPTANCE BY THE OWNER OR OWNER'S REPRESENTATIVE.

LASER GRADE SUB-GRADE AND COMPACT TO 98% DENSITY PER AASHTO T-180  
SUPPLY AND INSTALL 6" LIMEROCK BASE PER DETAILS(S) AND COMPACT TO 98% DENSITY PER AASHTO T-180  
PRIME ROCK BASE WITH AEP-225  
SUPPLY AND INSTALL MINIMUM 1" OF IRON TYP E-3 ASPHALT PER FOOT SPECIFICATIONS PER DETAILS(S)

AFTER STRIPPING THE SOG AND TOP SOIL, THE CONTRACTOR SHALL GRUB AND REMOVE THE ROOTS TO A DEPTH OF 12" BELOW THE EXISTING SOIL PER THE ENGINEER OF RECORD. TREE ROOTS SHALL BE REMOVED PRIOR TO THE PLACEMENT OF BRICK MATERIAL (TYP)  
CONTRACTOR EXTEND THE ASPHALT 2' BEYOND THE COURT PERIMETER DIMENSIONS AND PROVIDE A NEW STRAIGHT ASPHALT EDGE AND BACKFILL BEHIND THE COURT'S PERIMETER LEAVING THE SOG DOWN 1" BELOW THE COURT (TYP).

CONTRACTOR SHALL GRUB AND REMOVE ALL GRUBBING CONTOR THE GROUND TO MATCH THE NEW COURT WITH THE SURROUNDING FEATURES. IMPORT NEW FILL AS REQUIRED IN ORDER TO BRING THE NEW COURTS SYSTEM UP TO THE FINAL GRADDES. ALL NON-GRADES SHALL BE SCORED (TYP)  
CONTRACTOR SHALL REMOVE AND HAUL ALL GRUBBING CONTOR THE GROUND TO MATCH THE NEW COURT WITH THE SURROUNDING FEATURES. IMPORT NEW FILL AS REQUIRED IN ORDER TO BRING THE NEW COURTS SYSTEM UP TO THE FINAL GRADDES. ALL NON-GRADES SHALL BE SCORED (TYP)

CONTRACTOR SHALL REMOVE AND HAUL ALL GRUBBING CONTOR THE GROUND TO MATCH THE NEW COURT WITH THE SURROUNDING FEATURES. IMPORT NEW FILL AS REQUIRED IN ORDER TO BRING THE NEW COURTS SYSTEM UP TO THE FINAL GRADDES. ALL NON-GRADES SHALL BE SCORED (TYP)

CONTRACTOR SHALL REMOVE AND HAUL ALL GRUBBING CONTOR THE GROUND TO MATCH THE NEW COURT WITH THE SURROUNDING FEATURES. IMPORT NEW FILL AS REQUIRED IN ORDER TO BRING THE NEW COURTS SYSTEM UP TO THE FINAL GRADDES. ALL NON-GRADES SHALL BE SCORED (TYP)

CONTRACTOR SHALL REMOVE AND HAUL ALL GRUBBING CONTOR THE GROUND TO MATCH THE NEW COURT WITH THE SURROUNDING FEATURES. IMPORT NEW FILL AS REQUIRED IN ORDER TO BRING THE NEW COURTS SYSTEM UP TO THE FINAL GRADDES. ALL NON-GRADES SHALL BE SCORED (TYP)

CONTRACTOR SHALL REMOVE AND HAUL ALL GRUBBING CONTOR THE GROUND TO MATCH THE NEW COURT WITH THE SURROUNDING FEATURES. IMPORT NEW FILL AS REQUIRED IN ORDER TO BRING THE NEW COURTS SYSTEM UP TO THE FINAL GRADDES. ALL NON-GRADES SHALL BE SCORED (TYP)

CONTRACTOR SHALL REMOVE AND HAUL ALL GRUBBING CONTOR THE GROUND TO MATCH THE NEW COURT WITH THE SURROUNDING FEATURES. IMPORT NEW FILL AS REQUIRED IN ORDER TO BRING THE NEW COURTS SYSTEM UP TO THE FINAL GRADDES. ALL NON-GRADES SHALL BE SCORED (TYP)

CONTRACTOR SHALL REMOVE AND HAUL ALL GRUBBING CONTOR THE GROUND TO MATCH THE NEW COURT WITH THE SURROUNDING FEATURES. IMPORT NEW FILL AS REQUIRED IN ORDER TO BRING THE NEW COURTS SYSTEM UP TO THE FINAL GRADDES. ALL NON-GRADES SHALL BE SCORED (TYP)

MINSON DESIGN AND CONSULTING, INC.  
PO BOX 771058  
CORAL SPRINGS FL 33077  
PHONE: 954-340-5291  
AUTH. NO. 9327 & 7958

**PAVING, GRADING AND DRAINAGE PLAN  
STORMWATER POLLUTION PREVENTION PLAN**

PROJECT ADDRESS:  
IN BETWEEN NE 10 STREET AND NE 18 STREET, WEST OF FEDERAL HWY  
POMPAÑO BEACH, FL

REVISIONS:

No.	Revision	Date

**POMPAÑO BEACH COMMUNITY PARK  
YOUTH BASKETBALL COURT INSTALLATION**

**THE CITY OF POMPAÑO BEACH**

PROJECT ADDRESS:  
IN BETWEEN NE 10 STREET AND NE 18 STREET, WEST OF FEDERAL HWY  
POMPAÑO BEACH, FL

Scale: 1" = 20'

Sheet No. **C2**

Drawn by: SM  
Date: 07/19/2016

Appr. by: TO  
Date: 07/19/2016