

SANITARY KEY NOTES

- 1 EXTEND NEW 4" SANITARY BRANCH TO EXISTING STUB-UP AS REQUIRED. CONTRACTOR SHALL FIELD VERIFY EXACT SIZE, LOCATION, DIRECTION OF FLOW AND INVERT ELEVATION PRIOR TO CONSTRUCTION.

REVISIONS	BY

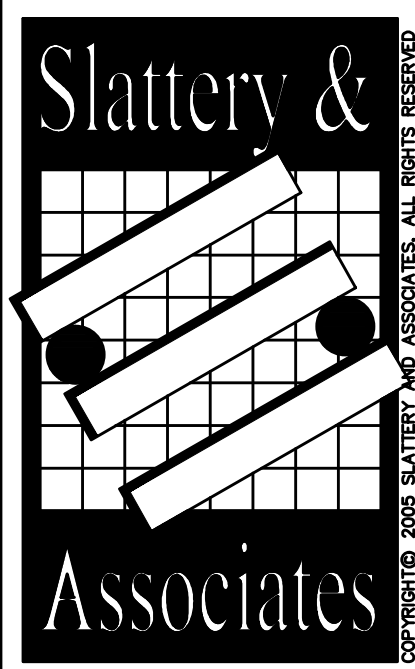

**ARCHITECTS
PLANNERS**
2060 NW BOCA RATON BLVD.
SUITE 2
BOCA RATON, FL 33431
TEL: 561-392-3848
FAX: 561-392-5402
WWW.SLATTERYARCHITECTS.COM

**ACTIVITY CENTER
FOR
FLORENCE FULLER CHILD DEVELOPMENT CENTERS
WEST CAMPUS
S.W. 185TH STREET
BOCA RATON, PALM BEACH COUNTY, FLORIDA**

**BIDDING
NOT FOR
CONSTRUCTION**
DATE OF SEAL: 4/2/08
SLATTERY & ASSOCIATES
FLORIDA REGISTRATION # AA0003381

DRAWN JWC/PG/AE
CHECKED AK/MP
DATE 10-21-16
SCALE AS NOTED
JOB NO. 2011-64
SHEET P2.1

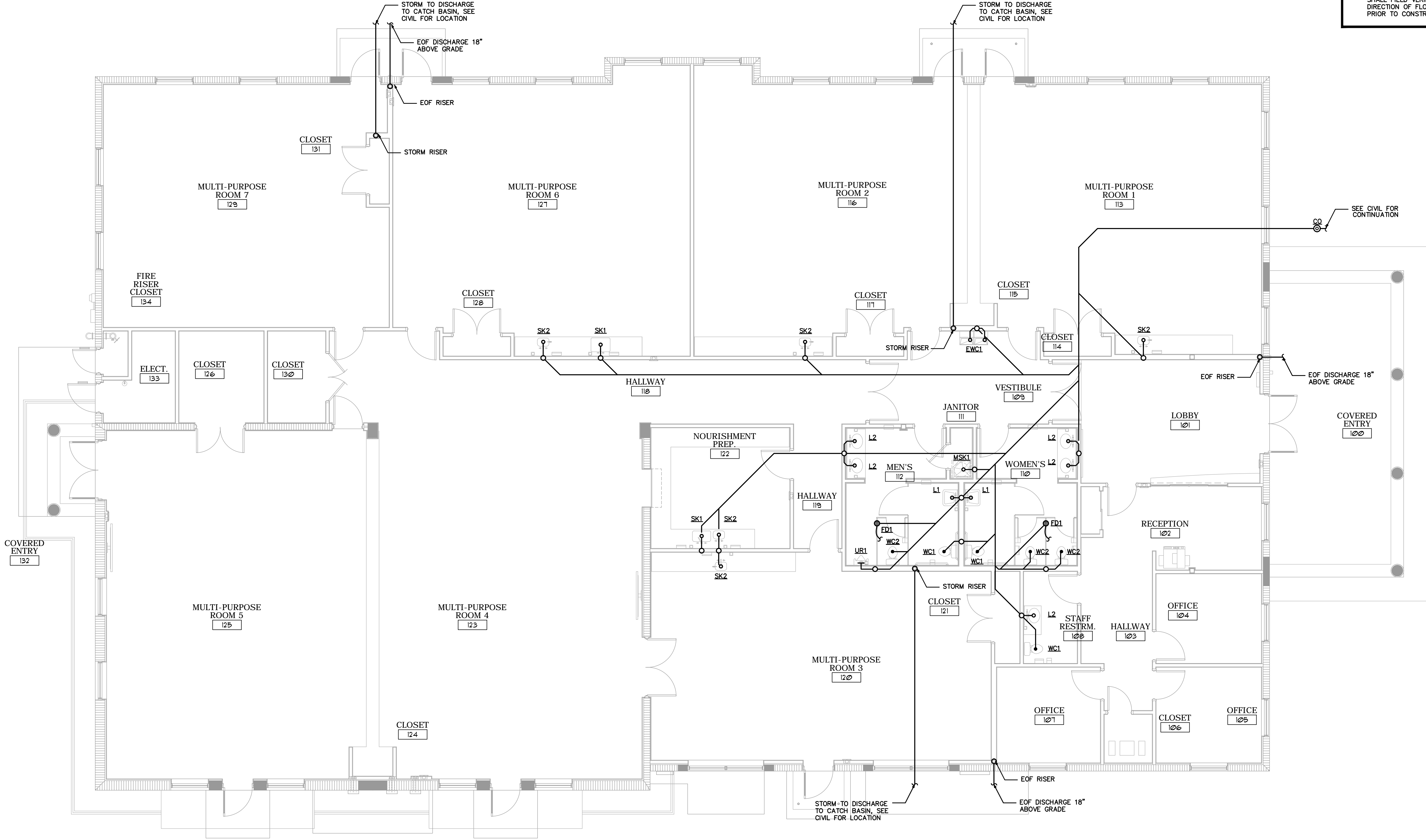

SANITARY PLAN
3/16"=1'-0" NORTH

ISSUED FOR PERMIT	
ISSUED FOR CONSTRUCTION	
KAMM CONSULTING PROJECT # 2016-0024 PROJECT MANAGER: JOHN CHIRGWIN	1407 West Newport Center Drive Deerfield Beach, Florida 33442 Phone 954.949.2200 Fax 954.949.2201 engineering@kammconsulting.com Certification of Authorization #8189
KAMM Consulting	date 10.21.16 signed

SANITARY PLAN

PHASE: C.D. SET 10-21-16