

REVISIONS	BY

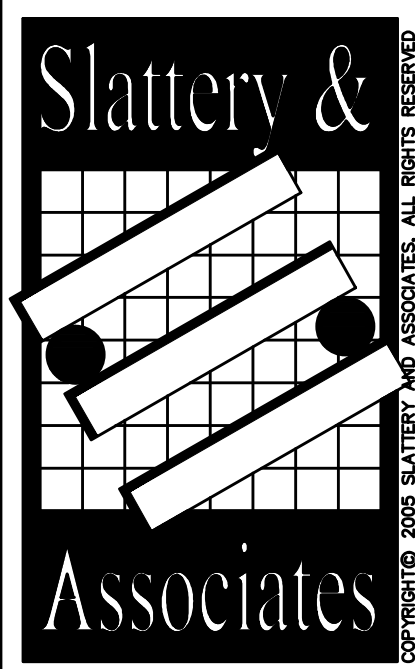

**ARCHITECTS  
PLANNERS**  
2060 NW BOCA RATON BLVD.  
SUITE 2  
BOCA RATON, FL 33431  
TEL: 561-392-3848  
FAX: 561-392-5402  
WWW.SLATTERYARCHITECTS.COM

**ACTIVITY CENTER  
FOR  
FLORENCE FULLER CHILD DEVELOPMENT CENTERS  
WEST CAMPUS  
S.W. 185TH STREET  
BOCA RATON, PALM BEACH COUNTY, FLORIDA**

**BIDDING  
NOT FOR  
CONSTRUCTION**  
DATE OF SEAL: 4/2/08  
SLATTERY & ASSOCIATES  
FLORIDA REGISTRATION # AA0003381

DRAWN	JWC/PG/AE
CHECKED	AK/MP
DATE	10-21-16
SCALE	AS NOTED
JOB NO.	2011-64
SHEET	P2.3

**P2.3**

PHASE: C.D. SET 10-21-16

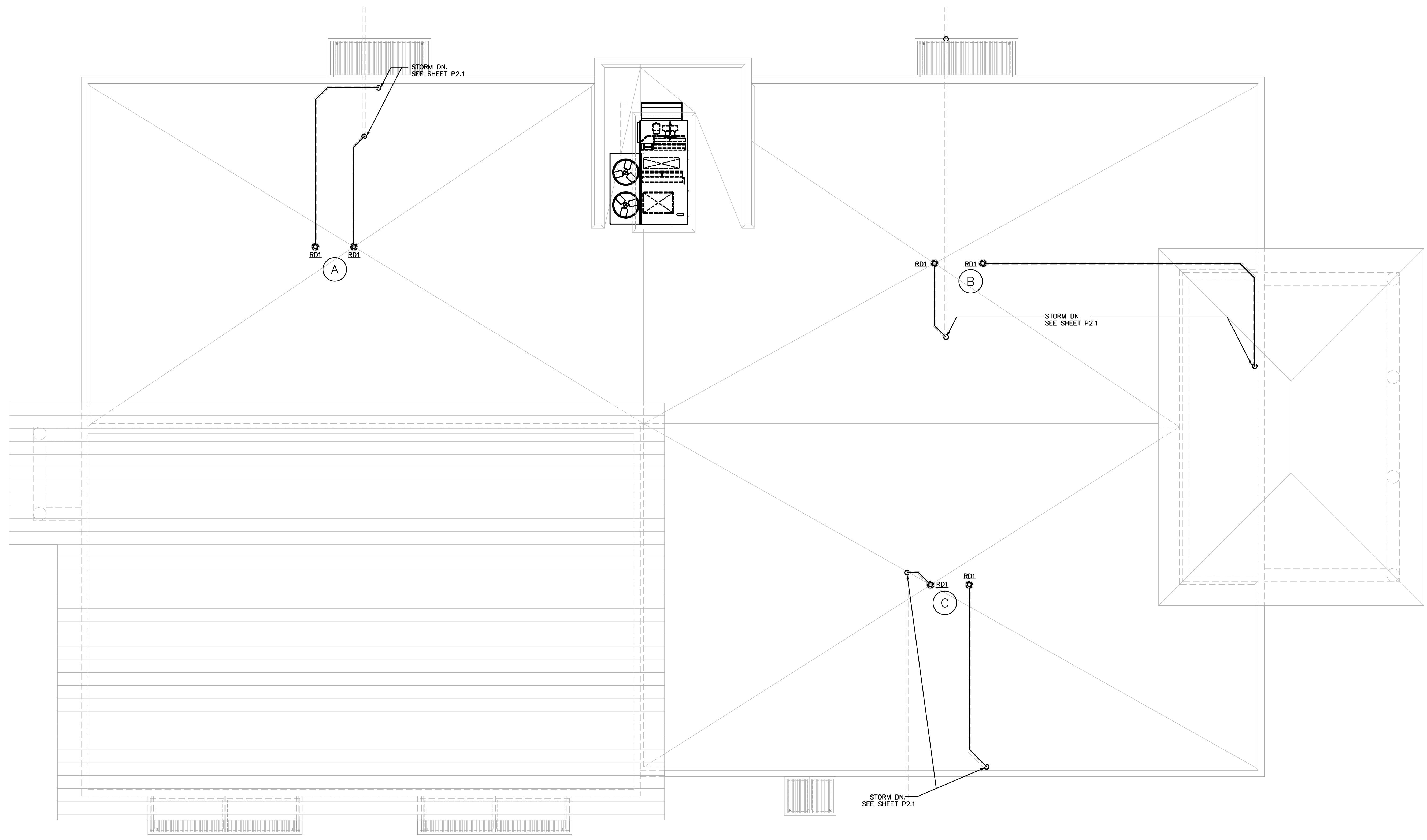

STORM DRAINAGE CALCULATION			
<b>(A)</b>	FLAT AREA = 1847 SQ.FT. 1/2 AREA PARAP. @ H=3.75' & L=33' = 1/2X3.75'X33' = 62 SQ.FT. 1/2 AREA PARAP. @ H=3.75' & L=52' = 1/2X3.75'X52' = 97.5 SQ.FT. 1/2 AREA PARAP. @ H=3.75' & L=57' = 1/2X3.75'X57' = 107 SQ.FT. 1/2 AREA PARAP. @ H=7.75' & L=15' = 1/2X7.75'X15' = 58 SQ.FT. TOTAL AREA=1847+97.5+107+58+62= 2172 SQ.FT.	<b>(B)</b> FLAT AREA = 2572 SQ.FT. 1/2 AREA PARAP. @ H=7.75' & L=15' = 1/2X7.75'X15' = 58 SQ.FT. 1/2 AREA PARAP. @ H=5.75' & L=10' = 1/2X5.75'X10' = 28.75 SQ.FT. 1/2 AREA PARAP. @ H=3.75' & L=52' = 1/2X3.75'X52' = 97.5 SQ.FT. 1/2 AREA PARAP. @ H=5.75' & L=18' = 1/2X5.75'X18' = 51.75 SQ.FT. 1/2 AREA PARAP. @ H=3.75' & L=17' = 1/2X3.75'X17' = 32 SQ.FT. 1/2 AREA PARAP. @ H=5.75' & L=10' = 1/2X5.75'X10' = 29 SQ.FT. TOTAL AREA=2752+58+28.75+97.5+51.75+28= 3016 SQ.FT.	<b>(C)</b> FLAT AREA = 2014 SQ.FT. 1/2 AREA PARAP. @ H=3' & L=36' = 1/2X3.75'X36' = 67.5 SQ.FT. 1/2 AREA PARAP. @ H=3.75' & L=61.5' = 1/2X3.75'X61.5' = 115 SQ.FT. 1/2 AREA PARAP. @ H=3.75' & L=17' = 1/2X3.75'X17' = 32 SQ.FT. 1/2 AREA PARAP. @ H=5.75' & L=19' = 1/2X5.75'X19' = 55 SQ.FT. 1/2 AREA PARAP. @ H=5.75' & L=10' = 1/2X5.75'X10' = 29 SQ.FT. TOTAL AREA=2014+67.5+115+32+55+29= 2133 SQ.FT.

**ROOF DRAINAGE PLAN**  
3/16"=1'-0" NORTH

ISSUED FOR PERMIT	
ISSUED FOR CONSTRUCTION	
KAMM CONSULTING PROJECT #	2016-0024
PRODUCT MANAGER	JOHN CHIRGWIN
<b>KAMM Consulting</b>	1407 West Newport Center Drive Deerfield Beach, Florida 33442 Phone 954.949.2200 Fax 954.949.2201 engineering@kammconsulting.com Certification of Authorization #81839
date	10.21.16
signed	

STORM DRAINAGE PLAN