

EQUIPMENT SCHEDULE			
ITEM NO.	QTY.	DESCRIPTION	REMARKS
1.01	1	OPEN NUMBER	
1.02	1	ICE MAKER W/ BIN	NIKEC/ EXISTING / RELOCATED - VERIFY ELECTRIC
1.03	1	HOT FOOD SERVING COUNTER	
1.04	1	COLD PAN SERVING COUNTER	
1.05	1	WORK TABLE	
1.06	1	WORK TABLE	
1.07	1	REACH-IN REFRIGERATOR	
1.08	1	REACH-IN HEATED CABINET	
1.09	1	WORK TABLE	
2.01	1	CONVECTION OVEN	
2.02	1	BOILERLESS CONVECTION STEAMER	
2.02A	1	WATER FILTER ASSEMBLY	
2.03	1	EQUIPMENT STAND	
2.04	1	TILTING SKILLET, GAS	
2.04A	1	FLOOR TROUGH	
2.05	1	RANGE, 72", 6 BURNERS, 36" GRIDDLE	
2.06	1	FRYER, GAS, HEAVY DUTY SECTIONAL RANGE MATCH	
2.07	1	WORK TABLE	
2.07A	1	WORK TABLE	
2.08	1	TWO (2) COMPARTMENT SINK	
	2	LEVER HANDLE DRAINS	
2.09	2	WORK TABLE	
2.10	1	SHELVING	NIKEC/ EXISTING/ MODIFY
2.11	1	MOP SINK	
2.12	1	OPEN NUMBER	
2.14	1	FIRE SUPPRESSION SYSTEM	
3.01	1	DISHWASHER, DOOR TYPE	
3.02	4	HAND SINK	
3.03	1	THREE (3) COMPARTMENT SINK	
3.04	1	SOILED DISHTABLE	
3.05	1	CLEAN DISHTABLE	
3.06	1	CONDENSATE HOOD	CUSTOM PER DETAIL 5.07
4.01	1	WALK IN COOLER FREEZER FLOOR	EXISTING / REPAIR
4.02	2	WALK-IN FREEZER & REFRIGERATOR DOOR HEATERS	EXISTING / REPAIR
4.03	1	WALK IN COOLER REFRIGERATOR FLOOR	EXISTING / REPAIR
4.04	1	OPEN NUMBER	
4.05	1	WARMING CABINET PARKING	NIKEC BY/ EC
4.06	1	WARMING CABINET PARKING	NIKEC BY/ EC
4.07	6	DROP DOWN CORD	NIKEC BY/ EC

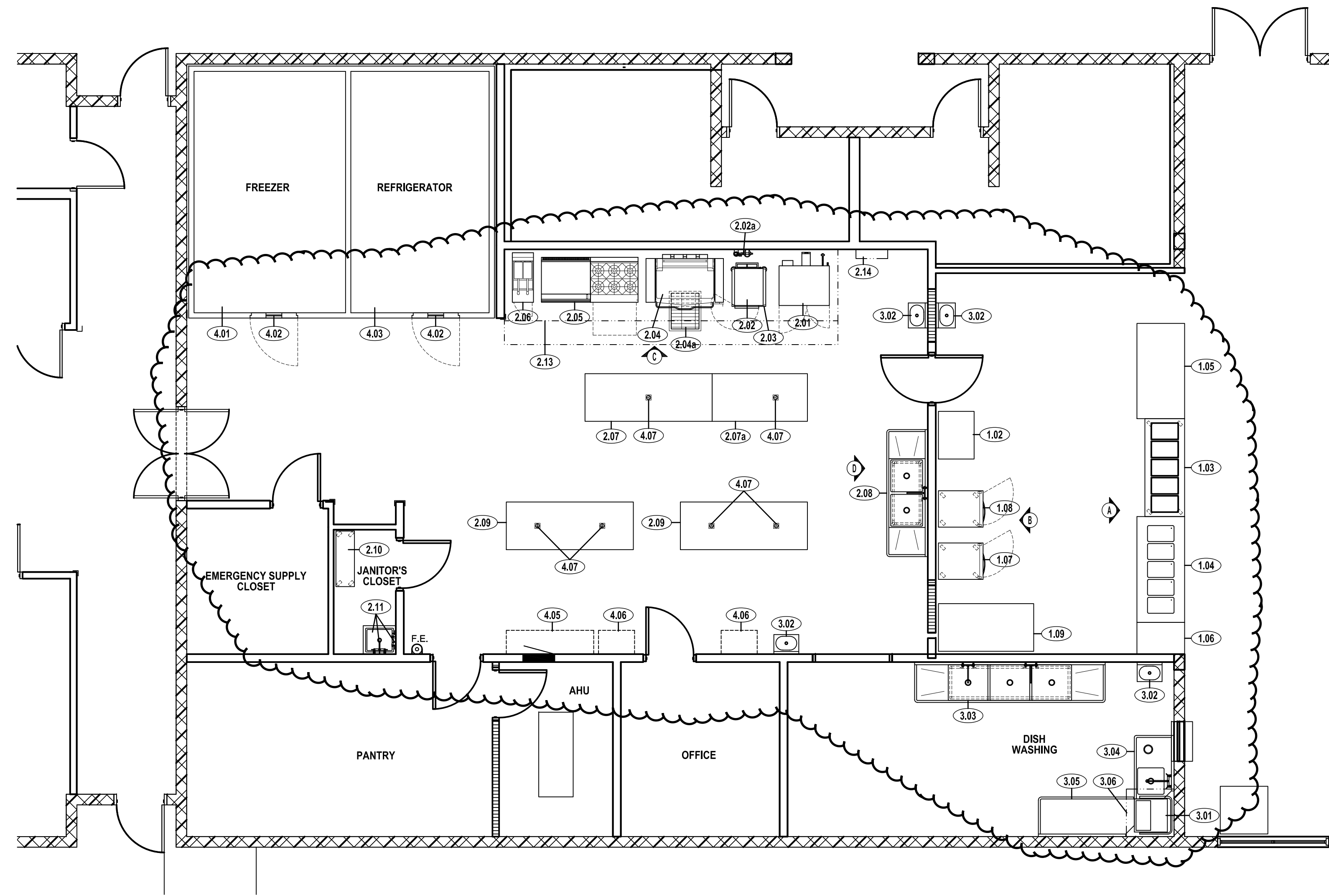

Cini-Little
 CINI.LITTLE INTERNATIONAL, INC.
 3405 N.W. 9th AVENUE, SUITE 1202
 FT. LAUDERDALE, FL 33309-5943 USA
 954-846-9600 OFFICE
 954-564-1065 FAX
 www.cini-little.com

OFFICE LOCATIONS
 CHICAGO CLEVELAND TORONTO
 FT. LAUDERDALE WASHINGTON
 LOS ANGELES LONDON
 NEW YORK STONEY
 SAN FRANCISCO TOKYO

PROJECT NAME
NORTH HOMELESS ASSISTANCE CENTER
 FT. LAUDERDALE, FL

SHEET TITLE
FOODSERVICE EQUIPMENT PLAN AND SCHEDULE

PROJECT MGR./DRN: SW/CAD
 SCALE: 1/4" = 1'-0"
 PROJECT NO: 16-0046-0
 ISSUE DATE: / /
 REFERENCE NORTH SHEET NUMBER
QF101

OCT 10, 2016 2:56 PM USER19
 Z:\A-YR-2015\15012 NORTH HOMELESS ASSISTANCE CENTER KITCHEN RENOV\CAI-INCOMING\CINI-LITTLE\2016.08.15 FINAL BROWARD_QF101.DWG

Z:\A-YR-2015\15012 North Homeless Assistance Center Kitchen Renov\CAI-Incoming\Cini-Little\2016.08.15 Final\Broward_QF101.dwg 10/10/2016 2:53:33 PM AutoCAD