

LCA AA 003432
 Architecture, Inc.
 1975 Sansbury's Way
 Suite 108
 West Palm Beach, FL 33411
 Phone: (561) 493-4787
 Fax: (561) 493-4786

REVISIONS / DATE

**Interior Improvement for
 Your Eye Specialists**
 550 Heritage Dr. Suite 105
 Jupiter, FL 33458

PLAN LEGEND

- EXISTING CMU EXTERIOR WALL. SEE STRUCTURAL DRAWINGS.
- 8", 12" OR 16" CMU EXTERIOR WALL. SEE STRUCTURAL DRAWINGS.
- EXISTING 1-HR FIRE RATED WALL
- 1-HR FIRE RATED WALL
- EXISTING PARTITION
- NON-BEARING PARTITION W/SOUND INSULATION
- NON-BEARING PARTITION TO 4" ABOVE CEILING UNLESS OTHERWISE SPECIFIED IN PARTITION DETAIL
- KNEE WALL

- DENOTES DETAIL
- DENOTES INTERIOR ELEVATIONS
- DENOTES WALL TYPE, SEE DETAIL SHEET
- WINDOW MARK/NUMBER
- WALL SECTION/SHEET NUMBER
- DOOR MARK/NUMBER
- BUILDING SECTION/SHEET NUMBER
- WALL HUNG FIRE EXTINGUISHER
- SEMI RECESSED FIRE EXTINGUISHER CABINET

PLAN NOTES

- 1) ALL FURNITURE IS NOT IN CONTRACT. (N.I.C.) U.O.N.
- 2) PROVIDE 2" WIDE BUILDING STANDARD WINDOW BLINDS FOR ALL WINDOWS, COLOR: WHITE.
- 3) ALL SLABS CORING AND PENETRATION PROTECTIONS SHALL BE INCLUDED
- 4) CONTRACTOR TO PREP FLOOR TO ACCEPT FINISH AND TO VISIT SITE TO DETERMINE FLOOR LEVELNESS PRIOR TO BID.
- 5) ALL PLUMBING AND ELECTRICAL LINES ARE TO BE CONCEALED UNLESS OTHERWISE SPECIFIED.
- 6) ALL INTERIOR FINISHES SHALL COMPLY WITH NFPA 101 AND FBC.
- 7) WALL THICKNESS ARE SHOWN AS NOMINAL. ALLOW FOR ACTUAL THICKNESS DURING LAYOUT. RESTROOM DIMENSIONS ARE MINIMUM CLEAR.
- 8) PROVIDE S.S. SURFACE MOUNTED BRADLEY PAPER TOWEL DISPENSER NEXT TO EACH SINK.
- 9) ALL CLOSET SHELVING TO BE MADE OF WHITE MELAMINE. (1) 24" DEEP SHELF @ 24" A.F.F. (WHERE SPACE PERMITS) AND (4) 16" DEEP SHELVES 14" O.C. VERTICALLY, UNLESS OTHERWISE REQUESTED BY CLIENT.
- 10) ALL WALL HUNG LAVATORIES SHALL HAVE CHAIR CARRIERS.
- 11) ALL BOX-BOX-FILE (BBF) CABINETS SHALL HAVE LOCKING BOTTOM DRAWER.

N.I.C. - NOT IN CONTRACT - ITEMS TO BE PURCHASED BY CLIENT. CONTRACTOR TO PREPARE SITE AND UTILITIES AS SHOWN. ALL BLOCKING/REINFORCING FOR N.I.C. ITEMS TO BE INCLUDED IN BID.

PLAN KEYNOTES

- EXIST. 1 HR FIRE RATED PARTITION, WALL. PROTECT ALL PENETRATIONS.
- EXIST. DOOR TO REMAIN.
- EXIST. ACCESSIBLE SUITE ENTRY DOORS.
- ACCESSIBLE RESTROOM SIGN COMPLYING WITH FBC. CENTER AT 60" AFF.
- PHONE BOARD-SEE ELECTRICAL
- 3/4" 24" X 24" BACKING BOARD FOR WALL MTD TV. CONSULT CLIENT FOR EXACT LOCATION. CONTRACTOR TO INSTALL TENANT'S WALL BRACKET.
- WIRE GROMMET, TYP.
- GRANITE COUNTER @ 42"
- GRANITE COUNTER @ 36"
- LAMINATED COUNTER @ 30"
- SEE SHEET A.3 FOR RESTROOM ACCESSORY MOUNTING DATA
- 30"W X 18"D LAMINATED COMPUTER DESK @ 30" A.F.F. PROVIDE BRACING.
- 1 5/8" 25 GA MTL STUDS @12" O.C. & 1/2" GWB. PAINT GWB FACING WINDOW BLACK. BRACE STUDS TO WALL & BOTTOM & TOP OF WINDOW @12" O.C. ABOVE & BELOW
- CHAIR RAIL-EXACT HEIGHT BY TENANT.
- EWH IN CEILING SPACE. SEE PLUMBING DRAWINGS.
- EXIST. STRUCTURAL/WET COLUMN. REPAIR DRYWALL WHERE NECESSARY.
- CONTRACTOR SHALL VERIFY THICKNESS OF EXIST. PANEL & ADJUST STUD DEPTH ACCORDINGLY.

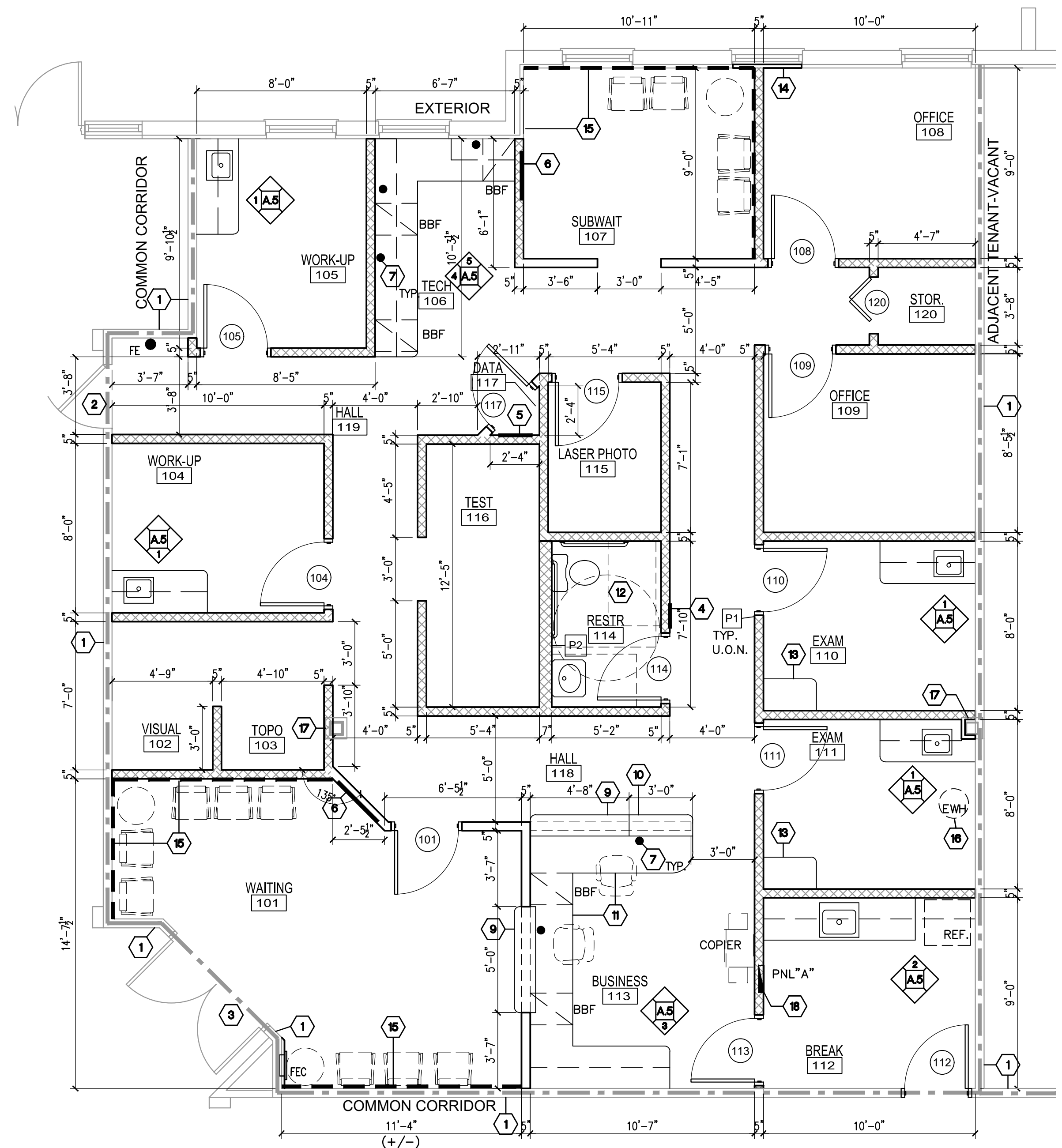

FLOOR PLAN
 SCALE: 1/4"=1'-0"

BRACING NOTE:

IF UNBRACED LENGTH OF WALL IS GREATER THAN 6'-0" USE DIAGONAL BRACING TO STRUCTURE ABOVE. PLACE BRACING IN MID SPAN OF WALL OR 6'-0" O.C. MAX.

FRAMING FASTENERS

BOTTOM TRACK: 3/4" X 1 1/4" DIA. POWDER ACTUATED FASTENERS @ 24" O.C. MAX. TOP TRACK TO BRACES: 4-PRUDENTIAL 53716 PAN FRAMING SCREWS BRACES TO STEEL JOIST: (2)#12 SELF-DRILLING SELF-TAPPING SCREWS.

CONTRACTOR SHALL EXAMINE PROVIDED EQUIPMENT SPECIFICATIONS AGAINST PROVIDED PLANS AND ISSUE REQUESTS FOR CLARIFICATION PRIOR TO BID. IF NO REQUEST IS ISSUED & RESPONDED TO FOR A GIVEN ITEM EQUIPMENT SPECIFICATION WILL GOVERN THESE PLANS.

LESLEW A. CZACZYK AIA

AR 00015391

PROJ. NO. 16176
 DESIGNED BY LAC
 DRAWN BY LAC
 DATE 11/30/16
 SCALE AS SHOWN

FLOOR PLAN NOTES